

FOR SALE

## Oseney Crescent, Kentish Town NW5

PRICE £475,000

OliverTown | 189 Kentish Town Road | Kentish Town | London | NW52JU Tel: 0207 284 1222 Email: hello@oliverstown.com



1 Bedroom



Kitchen



1 Reception



1 Bathroom



Balcony



Parking Permit

# Oseney Crescent, Kentish Town NW5

PRICE £475,000

Set in a period house along a charming Victorian crescent in the heart of Kentish Town, is this delightful first-floor flat, which encompasses space, high ceilings and character.

The entrance landing with its newly tiled floor leads to a WC cloakroom to the right and to the left, the living room, with its quaint fireplace and wonderful south-facing large sash windows set within period casements, offering great views onto the street and beyond.

Further in, a lobby offers access to a contemporary style shower room, the main bedroom and a beautifully appointed and tasteful kitchen, at the end of which, access is provided to a fantastic private balcony which spans across the entire rear façade of the property and along the bedroom too. This affords a lovely view onto the back gardens and trees as well as the sweeping rear elevation streetscape of Oseney Crescent.

The bedroom is well proportioned and appointed with storage and shelving.

This flat is a true gem, stylish, luminous and an ideal purchase for a first-time buyer. It is conveniently located near the shopping hub of Kentish Town Road and the exceptional transport links of Kentish Town Underground and mainline services.





£ 475,000.00

1 Bedroom

Leasehold

1 Bathroom

London Borough of Camden

1 Reception

C Council Tax Band

Balcony

67 EPC Band

Parking Permit

Oseney Crescent, NW5

Approximate Gross Internal Area = 47.27 m<sup>2</sup> / 508.81 ft<sup>2</sup>



First Floor

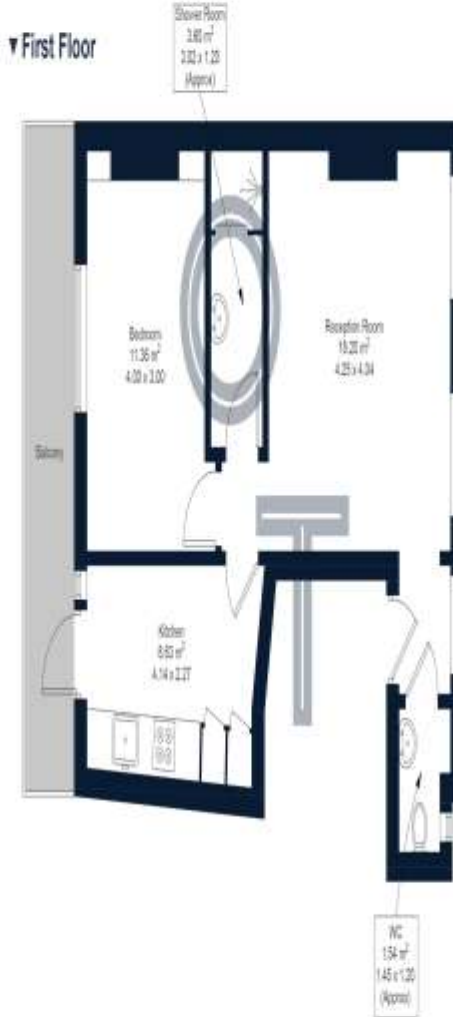

Brought to you by:

OLIVERS TOWN

This plan is for layout guidance only and is not to scale unless stated. All dimensions, including window, door, fittings, and the total area, are approximate measurements. Produced by a



KENTISH TOWN | 189 Kentish Town Rd | London | NW5 2JU | T: 020 7284 1222 | hello@oliverstown.com

ASSOCIATED MAYFAIR | 121 Park Lane | London | W1K 7AG | T: 020 3368 8602 | hello@oliverstown.com