



Lonsdale Road
Notting Hill, W11

CHESTERTONS





Situated on the raised ground floor of an attractive period conversion on Lonsdale Road, W11, this beautifully refurbished apartment offers bright and well designed living space. The property boasts impressive ceiling heights and a bright open plan kitchen, reception and dining area, creating a stylish yet practical environment.

The contemporary kitchen is thoughtfully appointed with a range of Siemens appliances, alongside a freestanding Smeg fridge, and is finished with quality materials including natural marble stone worktops and natural wood, lending both warmth and character. A light, neutral colour palette has been adopted throughout, offering an ideal blank canvas for personalisation.

The apartment further comprises a well proportioned bedroom with built in storage and a sleek, modern bathroom. Residents also benefit from access to parking. Ideally located in the heart of Notting Hill, the property is within approximately 0.5 miles of Notting Hill Gate Underground Station (Central and District lines). The fashionable boutiques and eateries of Westbourne Grove are moments away, while the vibrant Portobello Road is approximately 0.2 miles from the property.

- Raised ground floor apartment in a period W11 conversion
- Approximately 273 sq ft of stylishly refurbished living space
- Impressive ceiling heights and bright open-plan layout
- Modern kitchen with Siemens appliances and marble worktops
- Well-proportioned bedroom with built-in storage and sleek bathroom
- Prime Notting Hill location near Portobello Road and parking access

Asking Price £450,000

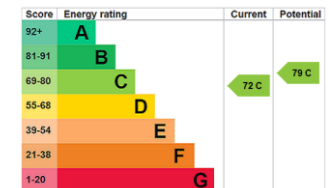

Tenure: Leasehold 123 years

Service Charge: £1075

Ground Rent: £0

Local Authority: Kensington and Chelsea

Council Tax Band: C

Chestertons Notting Hill Sales

30 Ledbury Road

Notting Hill

London

W11 2AB

nottinghill@chestertons.co.uk

0203 040 8585

Lonsdale Road, W11

○ - Ceiling Height

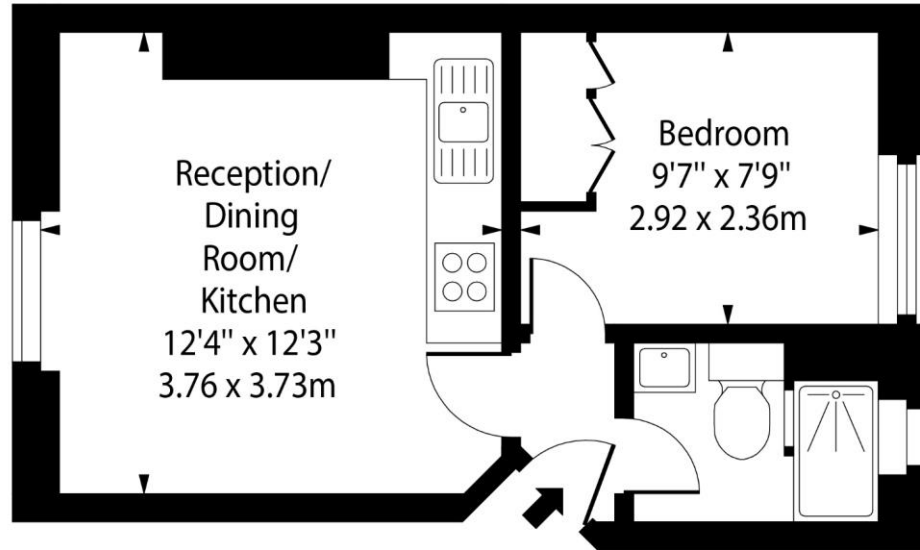

Raised Ground Floor

Approx Gross Internal Area 273 Sq Ft - 25.36 Sq M

Every attempt has been made to ensure the accuracy of the floor plan shown. However, all measurements, fixtures, fittings, and data shown are approximate interpretations and for illustrative purposes only. Measured according to the RICS. Not To Scale.

www.goldlens.co.uk

Ref. No. 031124M

