



QUEENS COURT, W2

£725 per week (£3,141 per month)

A bright two-bedroom apartment set in a sought-after building with a 24-hour porter.

Two bedroom

One bathroom

Heating and hot water included

Portered building

Moments from Hyde Park

EPC - D

STEP INSIDE QUEENS COURT

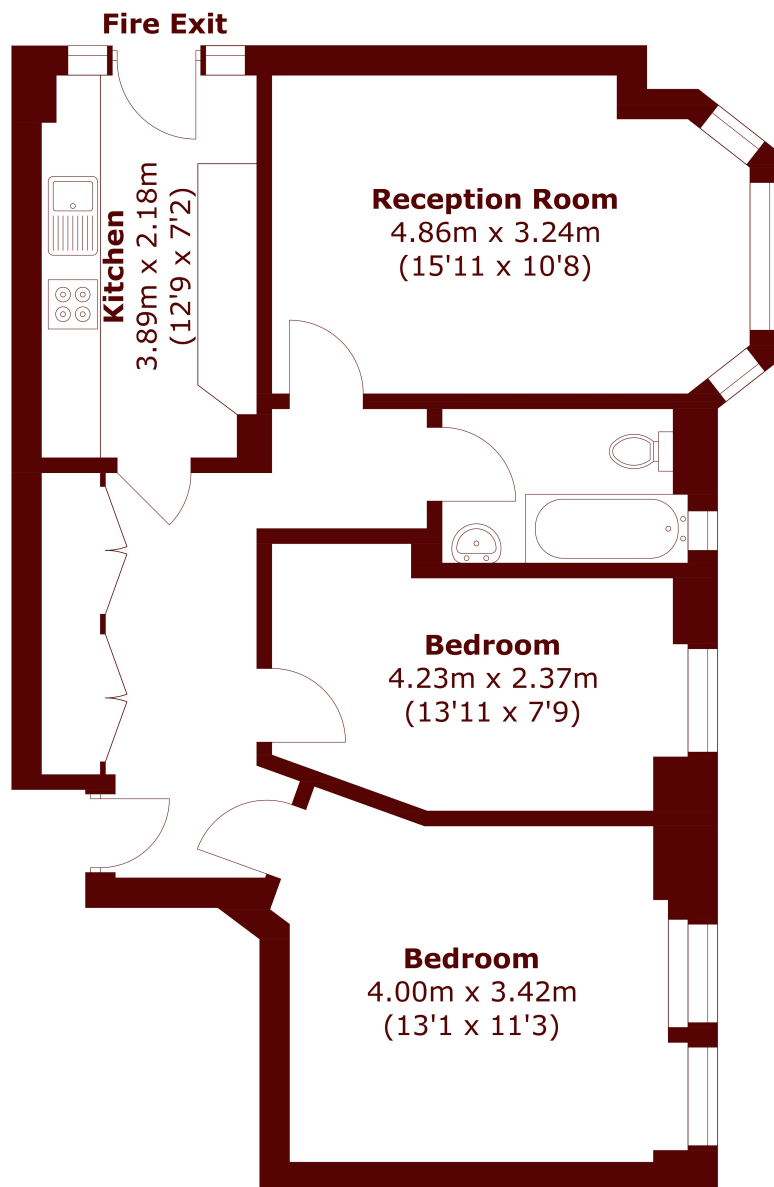

Total area (approx.): 66.0 sq. m (710.4 sq. ft)

Notting Hill
020 7313 6910

Energy Rating: D We aim to make our particulars both accurate and reliable. However, they are not guaranteed; nor do they form part of an offer or contract. If you require clarification on any points then please contact us, especially if you're traveling some distance to view. Please note that appliances and heating systems have not been tested and therefore no warranties can be given as to their good working order

MARSH &
PARSONS