



4 Thornfield Houses Cheadle Road, Cheadle Hulme

£180,000 Leasehold

NO CHAIN • SPACIOUS FIRST FLOOR APARTMENT • WALKING DISTANCE TO CHEADLE HULME VILLAGE • EXCELLENT LOCATION • TWO DOUBLE BEDROOMS • IN NEED OF UPDATING

Hibbert Homes are pleased to bring this well-presented two-bedroom first-floor apartment to the market, ideally located in the heart of Cheadle Hulme, and set within close proximity to Cheadle Hulme village offering its abundance of local amenities. This property presents spacious accommodation throughout and is sold as Chain Free, ensuring a quick transaction for all prospective buyers.



- › NO CHAIN
- › SPACIOUS FIRST FLOOR APARTMENT
- › WALKING DISTANCE TO CHEADLE HULME VILLAGE
- › EXCELLENT LOCATION
- › TWO DOUBLE BEDROOMS
- › IN NEED OF UPDATING





Approx Gross Internal Area
66 sq m / 707 sq ft

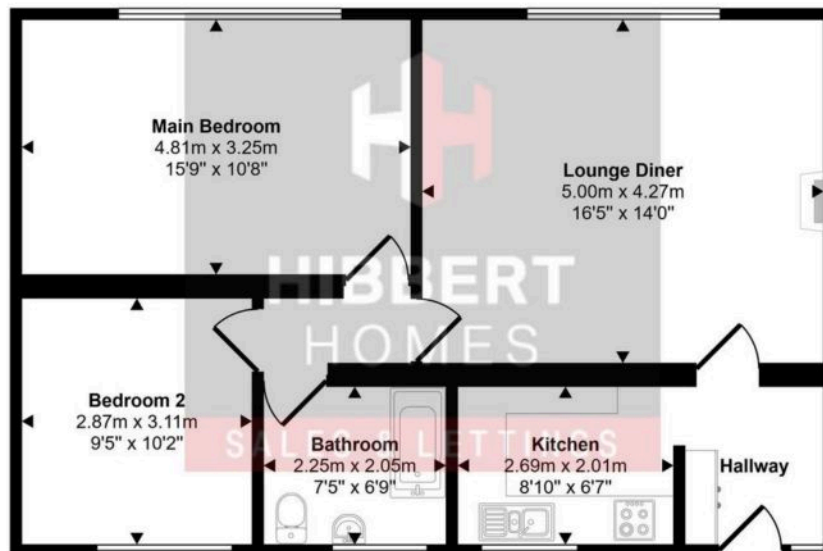

Floorplan

This floorplan is only for illustrative purposes and is not to scale. Measurements of rooms, doors, windows, and any items are approximate and no responsibility is taken for any error, omission or mis-statement. Icons of items such as bathroom suites are representations only and may not look like the real items. Made with Made Snappy 360.

