



101 Westgate, Southwell, Nottinghamshire,  
NG25 0LS

Guide Price £350,000

Tel: 01636 816200

 **RICHARD  
WATKINSON  
PARTNERS**

Surveyors, Estate Agents, Valuers, Auctioneers

- An Interesting Cottage
- Deceptively Spacious Accommodation
- Lounge Overlooking Gardens
- Entrance/Snug & Office/4th Bedroom
- 3 Bedrooms & Bathroom to 1st Floor
- No Onward Chain
- Versatile Living Space
- Spacious Sitting Room
- Kitchen & Boot Room/Utility
- Large Block Paved Driveway

An Interesting and Deceptively Spacious Cottage in the Heart of Southwell

An excellent opportunity to purchase this individual cottage, ideally located within the highly sought-after town of Southwell. The property offers spacious accommodation extending to approximately 1,050 sq. ft., and is available with the benefit of no onward chain.

The layout provides versatile living space, suited to a range of buyers. The accommodation includes:

Reception hall/snug leading to a large open-plan reception room, ideal for entertaining or relaxing.

A lounge to the rear, enjoying views over the southerly facing garden.

A further room, offering flexibility for use as home office or 4th bedroom.

A fitted kitchen complemented by a useful utility/boot room.

To the first floor, there are three bedrooms and a family bathroom.

Outside, the property features a large block-paved parking area, easily accommodating several vehicles, and a well maintained lawned rear garden that enjoys a favoured south facing aspect and includes a patio seating area.

### ACCOMMODATION

A timber entrance door leads into the entrance hall.

### HALLWAY/SNUG

With a central heating radiator, a door into the office/bedroom and opening into the sitting room.

### SITTING ROOM

A spacious reception room with two central heating radiators, two windows to the front aspect and a staircase leading down to the boot room/utility.

### OFFICE/BEDROOM

With a central heating radiator and a window to the front aspect.

### UTILITY/BOOT ROOM

A useful space with a central heating radiator, a uPVC double glazed obscured window to the front elevation, gas meter, a cupboard housing the electricity meter, plus space for kitchen appliances.

### KITCHEN

Fitted with a range of base and wall cabinets with rolled edge worktops and tiled splashbacks, an inset stainless steel 1.5 bowl sink with mixer tap and a built-in oven with four ring gas hob and extractor hood over. Space for appliances including plumbing for a washing machine plus spotlights to the ceiling, a uPVC double glazed obscured door onto the driveway parking and a doorway into the sitting room.

### LOUNGE

A lovely reception room with a central heating radiator, uPVC double glazed windows to both the side elevations, coved ceiling and uPVC double glazed sliding patio doors leading onto the rear garden. The focal point of the room is a decorative stone effect fireplace housing a coal effect gas fire.

### FIRST FLOOR LANDING

Having a uPVC double glazed window to the side aspect, access hatch to the roof space. Boiler/airing cupboard for storage and housing the combination boiler.

### BEDROOM ONE

With a central heating radiator, a uPVC double glazed window to the front aspect and a built-in double wardrobe.

### BEDROOM TWO

Having a central heating radiator and two uPVC double glazed windows to the side aspect.

### BEDROOM THREE

Having a central heating radiator and a uPVC double glazed window to the rear aspect.

### FOUR PIECE FAMILY BATHROOM

Fitted with a traditional style Heritage suite including a pedestal wash basin with hot and cold taps, a dual flush toilet, a panel sided bath with hot and cold taps and a shower enclosure with glazed folding door and mains fed shower. There is tiling for splashbacks and a tiled floor plus a central heating radiator, spotlights to the ceiling and an extractor fan.

### AMPLE DRIVEWAY PARKING & LAWNED GARDEN

A driveway shared only with 101a Westgate leads from the road turning onto private block paved parking for 101 Westgate, providing an exceptionally large parking area for multiple vehicles and including a useful timber shed. To the rear is a generous lawned garden with patio seating area, all affording a favoured southerly aspect.

### SOUTHWELL

The property is situated within walking distance to a wide range of amenities including boutique clothing stores, doctors surgery, pubs and restaurants and a number of excellent independent shops. The Minster itself is a great draw for tourists, and the town is conveniently situated for travel, the nearby town of Newark being approximately 9 miles by road and itself having a wide range of amenities including a mainline train station. In addition, Southwell is served by excellent schooling including the Ofsted rated 'excellent' Minster School which is within easy walking distance of the property.

## **COUNCIL TAX**

The property is registered as council tax band C.

## **VIEWINGS**

By appointment with Richard Watkinson & Partners.

## **ADDITIONAL INFORMATION**

The property is located within a conservation area.

Please see the links below to check for additional information regarding environmental criteria (i.e. flood assessment), school Ofsted ratings, planning applications and services such as broadband and phone signal. Note Richard Watkinson & Partners has no affiliation to any of the below agencies and cannot be responsible for any incorrect information provided by the individual sources.

Flood assessment of an area: \_

<https://check-long-term-flood-risk.service.gov.uk/risk#>

Broadband & Mobile coverage:-

<https://checker.ofcom.org.uk/en-gb/broadband-coverage>

School Ofsted reports:-

<https://reports.ofsted.gov.uk/>

Planning applications:-

<https://www.gov.uk/search-register-planning-decisions>

Once an offer is accepted, there will be a small charge for our biometric Anti Money Laundering compliance check of £14 + VAT per purchaser.











Approximate Gross Internal Area  
1163 sq ft - 108 sq m

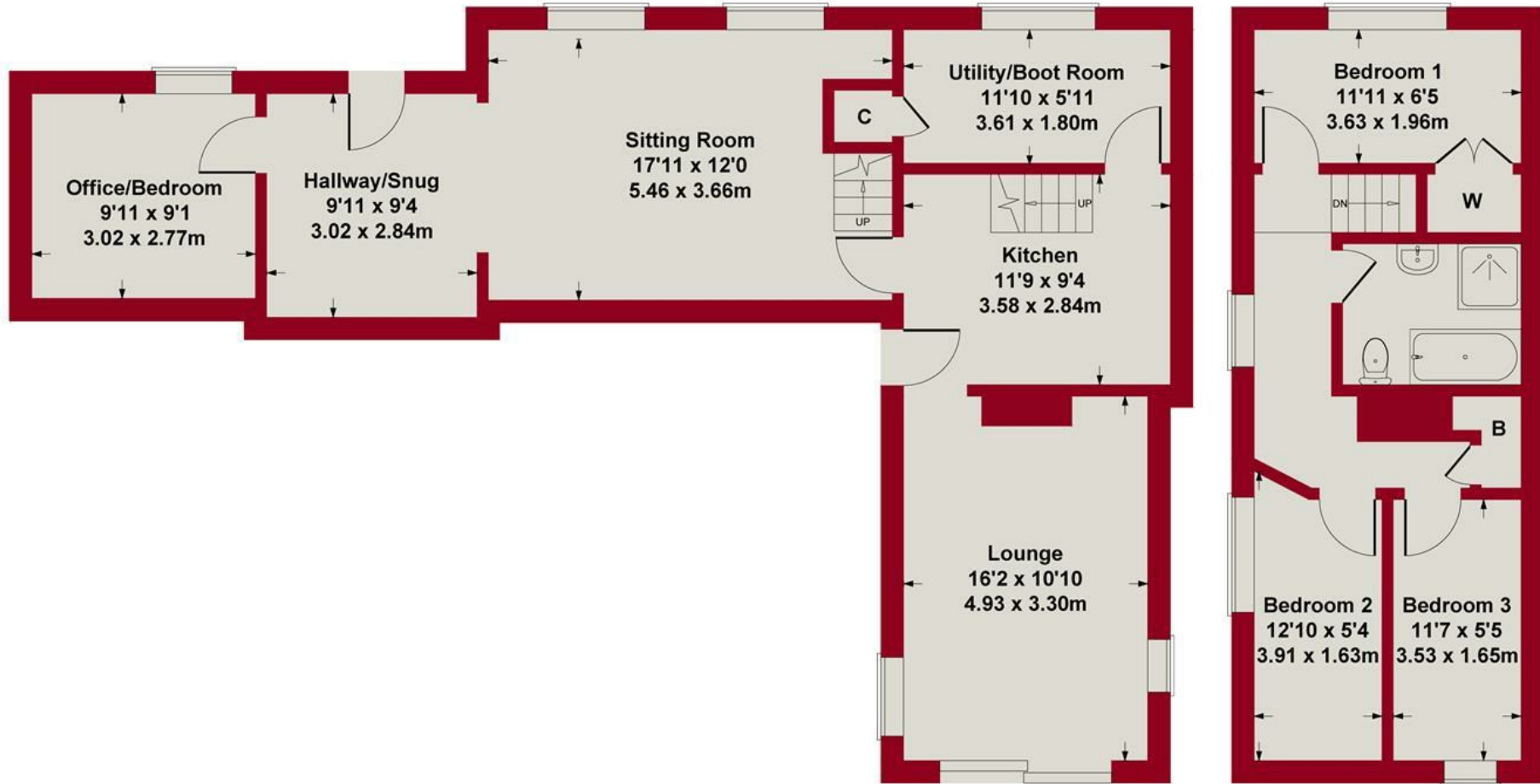

GROUND FLOOR

FIRST FLOOR

Whilst every attempt has been made to ensure the accuracy of the floor plan contained here, measurements of doors, windows, rooms and any other items are approximate and no responsibility is taken for any error, omission, or mis-statement. This plan is for illustrative purposes only and should be used as such by any prospective purchaser or tenant. The services, systems and appliances shown have not been tested and no guarantee as to their operability or efficiency can be given.

Copyright V360 Ltd 2025 | [www.houseviz.com](http://www.houseviz.com)



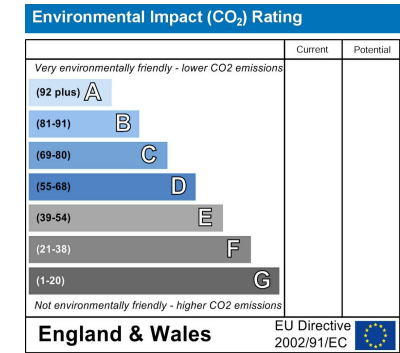
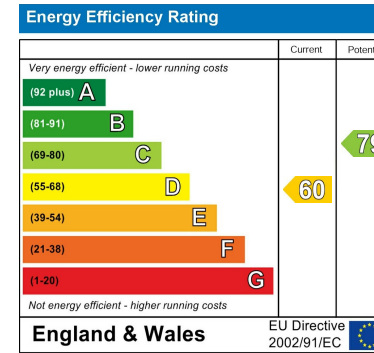

*These particulars, whilst believed to be accurate are set out as a general outline only for guidance and do not constitute any part of an offer or contract. Intending purchasers should not rely on them as statements of representation of fact, but must satisfy themselves by inspection or otherwise as to their accuracy. No person in this firm's employment has the authority to make or give any representation or warranty in respect of the property. Any fixtures and fittings not mentioned in these details are excluded from the sale price. No services or appliances which may have been included in these details have been tested by the selling agent and therefore cannot be guaranteed to be in good working order.*

*As part of the service we offer we may recommend ancillary services to you such as mortgage advice, solicitors and surveyors which we believe will help with your property transaction. We wish to make you aware that should you decide to proceed we may receive a referral fee or equivalent. This could be a fee, commission, payment or other reward. We will not refer your details unless you have provided consent for us to do so. You are not under any obligation to provide us with your consent or to use any of these services. You are also free to choose an alternative provider.*

Thinking of selling? For a FREE no obligation quotation call 01636 816200



Richard Watkinson & Partners is the trading name of Richard Watkinson Ltd.  
Registered in England. Ltd Registration number: 07140024

20 King Street,  
Southwell NG25 0EH  
Tel: 01636 816200  
Email: [southwell@richardwatkinson.co.uk](mailto:southwell@richardwatkinson.co.uk)



Surveyors, Estate Agents, Valuers, Auctioneers