



**Meadside Walk, Chatham**

**£2,300 Per Month**

# Meadside Walk, Chatham

Date Available: 17th May 2026

Deposit: £2,653

Unfurnished

Council Tax Band: D

- 5 double bedrooms
- Attic bedroom with ensuite
- Walk-in wardrobe in 1 bedroom
- Family bathroom
- Downstairs WC
- Newly decorated interiors
- Low maintenance courtyard
- Quiet cul-de-sac location
- Garage with electric shutter
- Viewing highly recommended

Energy Efficiency Rating	
Current	Potential
75	84

Very energy efficient - lower running costs

(92 plus) A

(81-91) B

(69-80) C

(55-68) D

(39-54) E

(21-38) F

(1-20) G

Not energy efficient - higher running costs

England & Wales EU Directive 2002/91/EC

Environmental Impact (CO <sub>2</sub> ) Rating	
Current	Potential

Very environmentally friendly - lower CO<sub>2</sub> emissions

(92 plus) A

(81-91) B

(69-80) C

(55-68) D

(39-54) E

(21-38) F

(1-20) G

Not environmentally friendly - higher CO<sub>2</sub> emissions

England & Wales EU Directive 2002/91/EC

Nestled in the tranquil cul-de-sac of Meadside Walk, Chatham, this splendid family home offers an impressive 1,984 square feet of living space, perfect for modern family life.

The house boasts five generously sized double bedrooms, ensuring ample space for family members or guests. Among these, one bedroom features a convenient walk-in wardrobe, while the attic bedroom comes complete with its own ensuite, providing a private retreat. The family bathroom is well-appointed, and there is an additional downstairs WC for added convenience.

The heart of the home is the inviting reception room, which flows seamlessly into the low-maintenance courtyard-style garden, perfect for outdoor relaxation or entertaining. The property has been newly decorated throughout, with fresh carpets and flooring that enhance its appeal.

For those with vehicles, the property includes a garage with an electric shutter and offers one to two parking spaces, ensuring ease of access. The quiet location adds to the charm, making it a peaceful haven away from the hustle and bustle.

This lovely family home is a must-see, as its spacious layout and thoughtful features truly need to be appreciated in person.

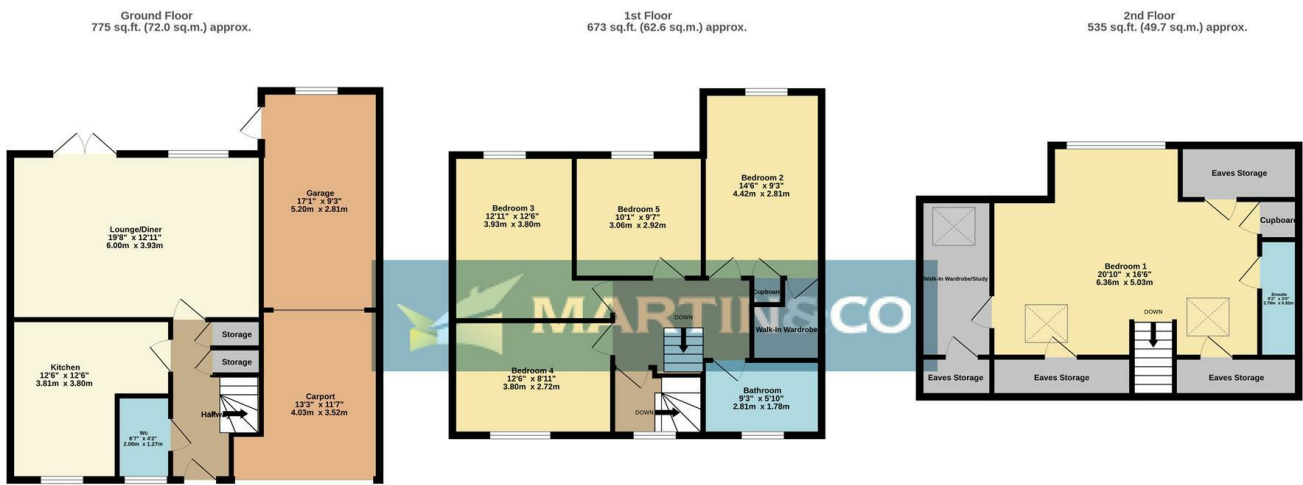

TOTAL FLOOR AREA : 1984 sq.ft. (184.3 sq.m.) approx.

Whilst every attempt has been made to ensure the accuracy of the floorplan contained here, measurements of doors, windows, rooms and any other items are approximate and no responsibility is taken for any error, omission or mis-statement. This plan is for illustrative purposes only and should be used as such by any prospective purchaser. The services, systems and appliances shown have not been tested and no guarantee as to their operability or efficiency can be given.

Made with Metropix ©2026

Martin & Co Medway Lettings  
 161 High Street, Rochester, Kent, ME1 1EH  
 01634 838700 . medway@martinco.com

01634 838700  
<http://www.martinco.com>



**Accuracy:** References to the Tenure of a Property are based on information supplied by the Seller. The Agent has not had sight of the title documents. A Buyer is advised to obtain verification from their Solicitor. Items shown in photographs including but not limited to carpets, fixtures and fittings are not included unless specifically mentioned within the sales particulars. They may however be available by separate negotiation. Buyers must check the availability of any property and make an appointment to view before embarking on any journey to see a property. No person in the employment of the agent has any authority to make any representation about the property, and accordingly any information given is entirely without responsibility on the part of the agents, sellers(s) or lessors(s). Any property particulars are not an offer or contract, nor form part of one. **Sonic / laser Tape:** Measurements taken using a sonic / laser tape measure may be subject to a small margin of error. **All Measurements:** All Measurements are Approximate. **Services Not tested:** The Agent has not tested any apparatus, equipment, Fixtures and Fittings or services and so cannot verify that they are in working order or fit for the purpose. A Buyer is advised to obtain verification from their Solicitor or Surveyor.

