



Canning Terrace, Nottingham
£1,000 pcm





Canning Terrace

Nottingham, Nottingham

This Property on Canning Terrace has undergone extensive renovation works to create a thoughtfully designed and modern home with an immaculate finish. Tenants will benefit from stylish interiors, thoughtful high-end features and appliances clever storage solutions, and an abundance of light from original windows with secondary glazing. This property also benefits from a home office in the garden.

Canning Terrace offers potential tenants the chance to live in a piece of Nottingham's history, built in 1837. You will enjoy a thriving city centre on your doorstep, with plenty of shops, bars, restaurants and theatres just a stones throw away. This includes some of Comfort Estates own favourite independent retailers located just off Canning Circus on Derby Road. There are plenty of transport links close by including Nottingham train station and the bus and tram network.

In brief the property comprises of entrance hallway, modern kitchen with high-end appliances, separate living room, 3 piece suite bathroom, large double bedroom, and private courtyard with a home office.

This property is undoubtedly one of the finest city centre opportunities on the market today – call Comfort Estates now to book your viewing appointment.

This Property on Canning Terrace has undergone extensive renovation works to create a thoughtfully designed and modern home with





Canning Terrace

Nottingham, Nottingham

Canning Terrace benefits from stylish interiors, high-end features and great storage solutions.

Council Tax band: A

Tenure: Freehold

EPC Energy Efficiency Rating: C

EPC Environmental Impact Rating:

- Character Property
- City Centre Location
- Private Garden
- Modern Finish
- Great Location





Living Room

Decorated with white walls and herringbone flooring. The room consists of a 3-seater sofa, side table, tv unit, traditional style radiators, and original windows giving the room plenty of light. The living room also leads to the garden at the rear.

Kitchen

Located to the front of the property, through the Crittall doors of the entry hall. The kitchen is finished to a high-spec with white walls, herringbone flooring, and original windows, with secondary glazing. The kitchen comprises grey units with an integrated dishwasher, four ring hob/ oven, a free-standing fridge/ freezer, and a dining table with spare chairs kept in storage ready to entertain guests.

Bathroom

8' 6" x 7' 3" (2.60m x 2.20m)

A luxurious bathroom with 3 piece suite. An original window to the rear of the property with obscured glass provides plenty of light. Decorated with graphite grey tiling and light wood effect flooring. The 3 piece suite includes free-standing wash hand basin with mirrored storage cabinet above, shower with rain shower head over bath and wc. The bathroom also holds a storage cupboard containing a washing machine and boiler.

Bedroom

The bedroom is a large double located at the front of the property. The bedroom is decorated with grey carpets and white walls. The room benefits from built-in wardrobes, bedside tables, and a double bed. The room also features original windows with secondary glazing to maintain peace and quiet.





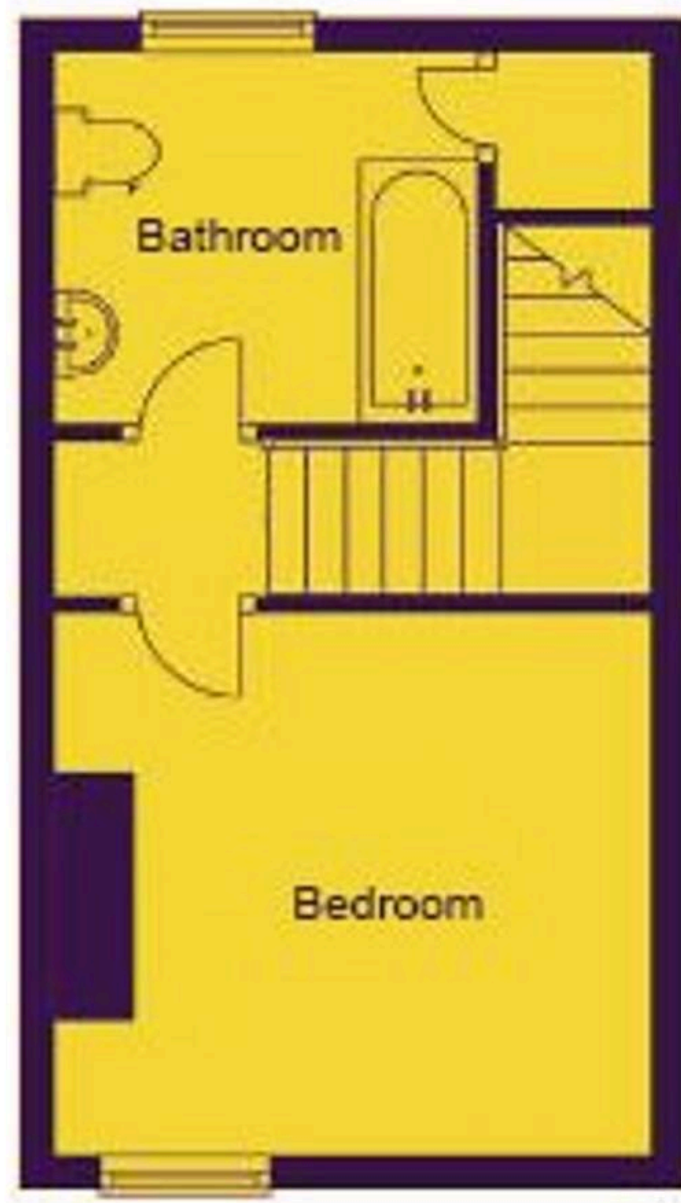
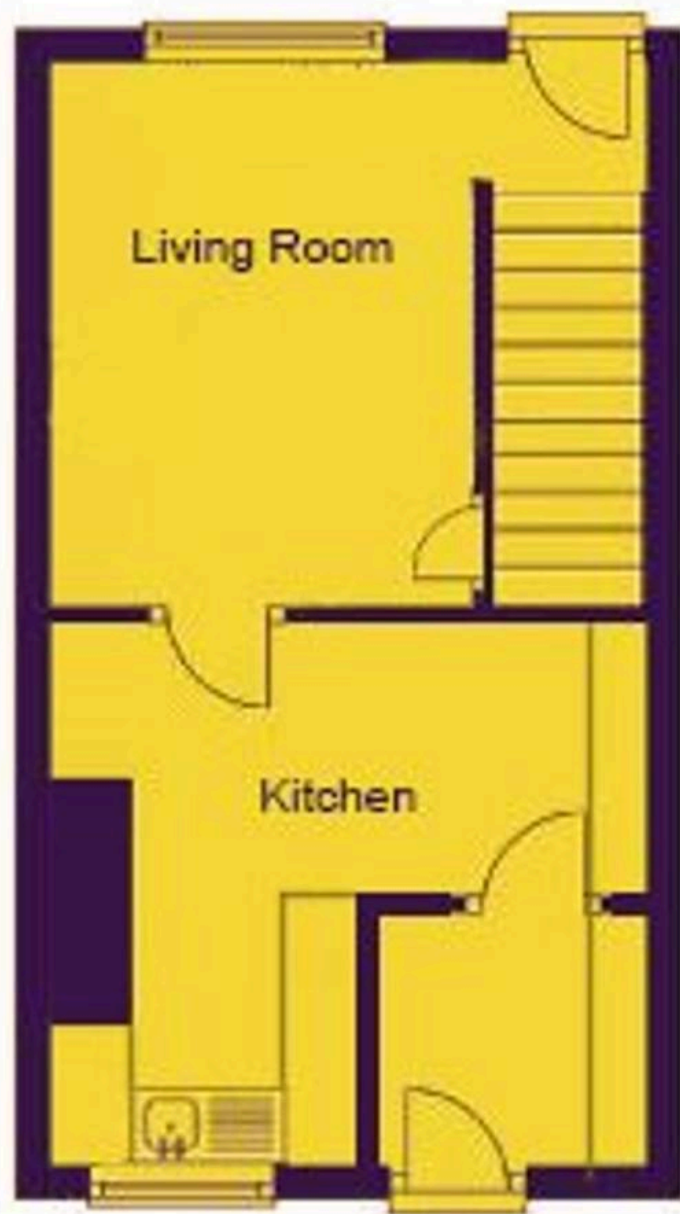



Comfort Estates

Comfort Estates, 47 Derby Road - NG1 5AW

0115 9338997 • info@comfortestates.co.uk • www.comfortestates.co.uk