



## 26 Orrian Close, Stratford-Upon-Avon

Guide Price **£275,000**



## 26 Orrian Close

Stratford-Upon-Avon, Stratford-Upon-Avon

Freehold 3-bed mid-terrace with no chain, kitchen, dining room, large living room, conservatory, garden, off-street parking. Near shops, station. Ideal for investors, first-time buyers or downsizers.

Council Tax band: C

Tenure: Freehold

EPC Energy Efficiency Rating: C

EPC Environmental Impact Rating: C

- No Upward Chain
- Large Living Room
- UPVC Double Glazing
- Gas Central Heating
- Investors / First Time Buyers
- Off Street Parking
- Close to Amenities
- Family Residential Location









## Ground Floor

Approx. 47.6 sq. metres (512.9 sq. feet)

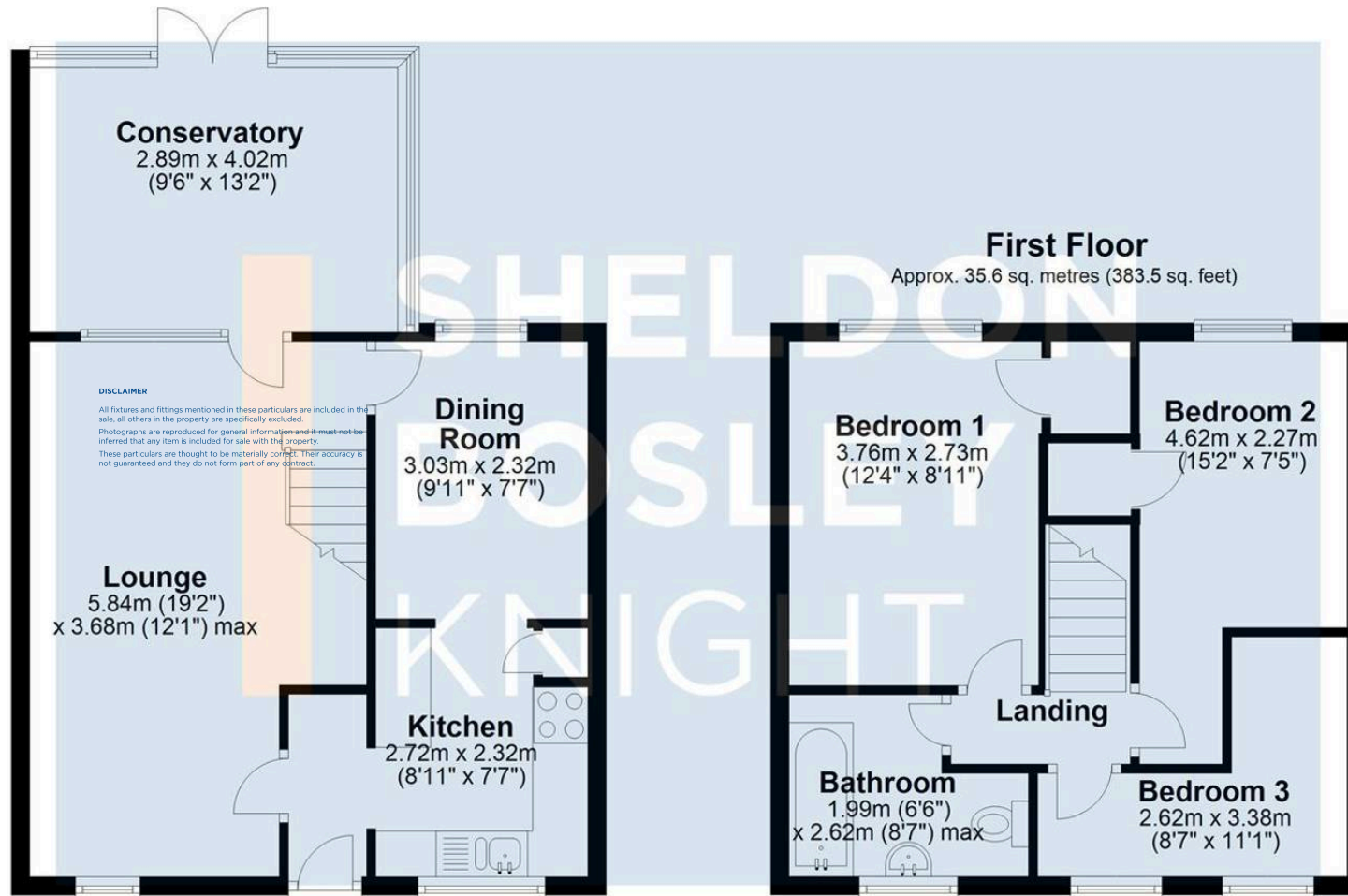

Total area: approx. 83.3 sq. metres (896.4 sq. feet)

All efforts have been made to ensure that the measurements on this floorplan are accurate however these are for guidance purposes only.  
Plan produced using PlanUp.

## Sheldon Bosley Knight Stratford-Upon-Avon

Sheldon Bosley Knight, 35-36 Rother Street - CV37 6LP

01789387887 · stratfordsales@sheldonbosleyknight.co.uk · www.sheldonbosleyknight.co.uk/

### DISCLAIMER

All fixtures and fittings mentioned in these particulars are included in the sale, all others in the property are specifically excluded.

Photographs are reproduced for general information and it must not be inferred that any item is included for sale with the property.

These particulars are thought to be materially correct. Their accuracy is not guaranteed and they do not form part of any contract.