



RESIDENTIAL



## 27 Moseley Road, Birmingham, West Midlands, B12 0HJ

£138,950

- Rental income of £675.00 pcm
- Well Presented 1bed
- 105 years on lease
- With Elevator Access and Landscaped Communal Gardens
- Located in a Highly Desirable Development

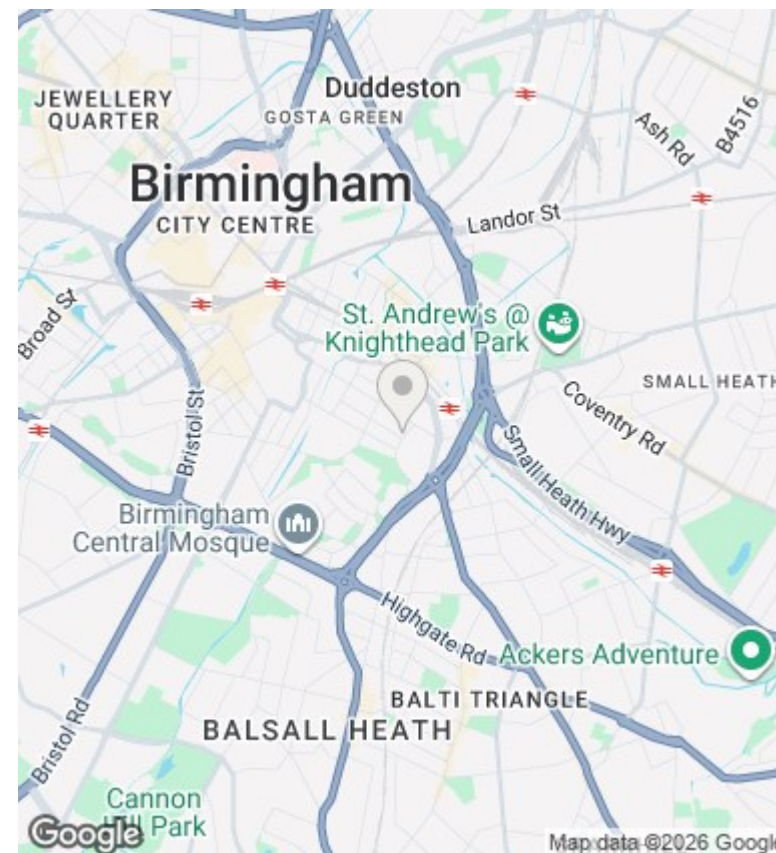
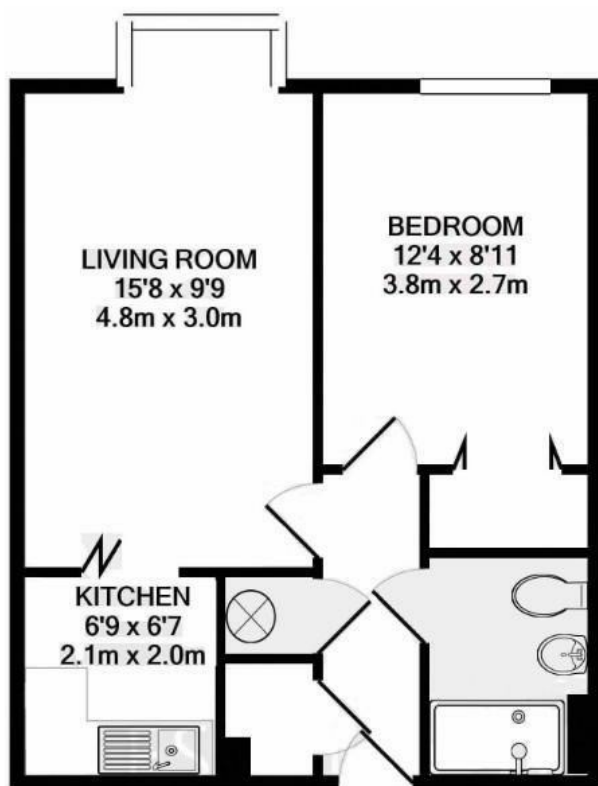

## Directions

## Viewings

Viewings by arrangement only. Call 0113 3224 345 to make an appointment.

## Council Tax Band

## EPC Rating:

Energy Efficiency Rating		
	Current	Potential
Very energy efficient - lower running costs		
(92 plus) <b>A</b>		
(81-91) <b>B</b>		
(69-80) <b>C</b>		
(55-68) <b>D</b>		
(39-54) <b>E</b>		
(21-38) <b>F</b>		
(1-20) <b>G</b>		
Not energy efficient - higher running costs		
<b>England &amp; Wales</b>	EU Directive 2002/91/EC	