



Flat F, 45 Woodford Way, Witney



Flat F

A stylish two-bedroom first floor apartment situated in a highly-sought after town centre location within walking distance of all local amenities.

Council Tax band: C

Tenure: Leasehold

- Stylish two-bedroom first floor apartment situated in a central position within walking distance of all local amenities.
- Open plan kitchen/dining/living room.
- Bright and spacious hallway which could be used as an office.
- Two double bedrooms, master bedroom with built in wardrobe.
- Modern bathroom with bath and shower.
- Allocated parking space.



45 Woodford Way - Witney

Approximate Gross Internal Area = 60.7 sq m / 653 sq ft

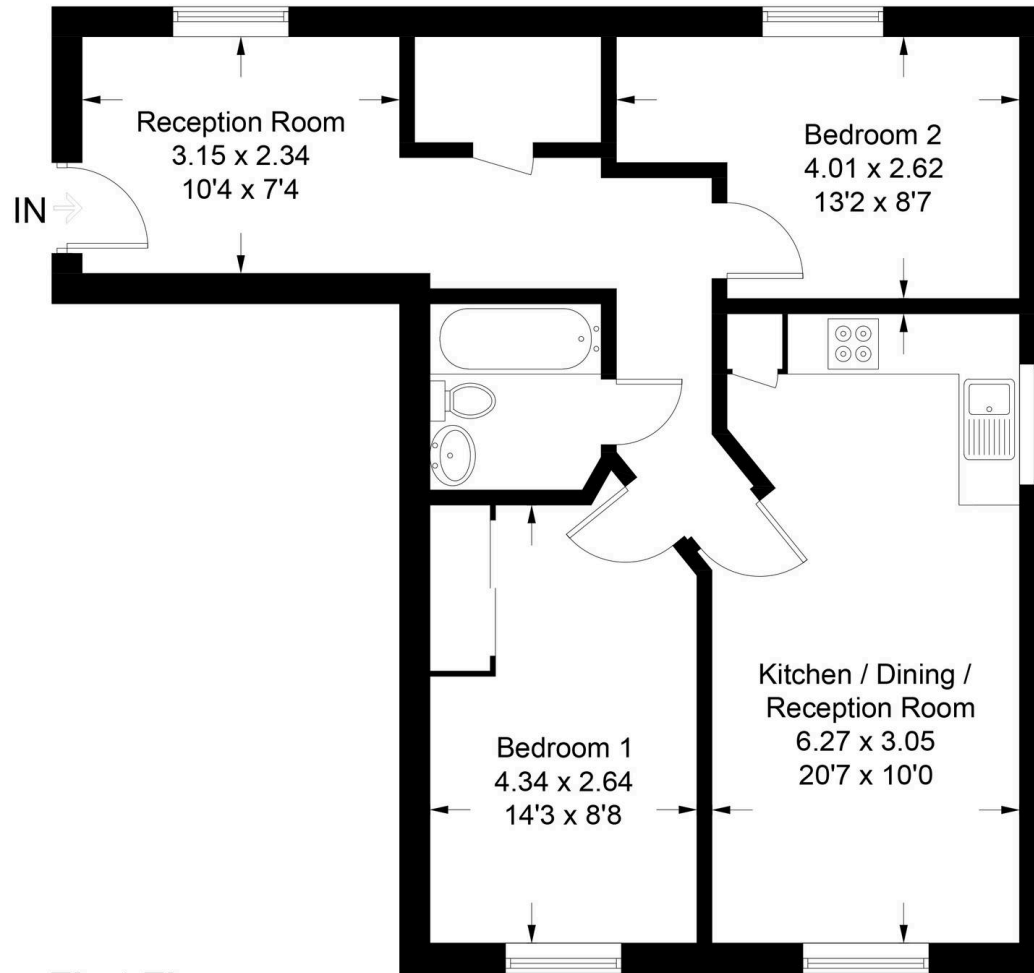

First Floor



Simpsons Witney Branch

4 Langdale Court Witney, Oxfordshire - OX28 6AD

01993 835030 • witney@simpsonsproperty.com • www.simpsonsproperty.com/