

Clyfford Road

Ruislip • Middlesex • HA4 6PU

Asking Price: £525,000



coopers
est 1986

Clyfford Road

Ruislip • Middlesex • HA4 6PU

Coopers are delighted to present this two-bedroom end-terrace home situated on the sought-after Clyfford Road in Ruislip, offering bright and spacious accommodation across two floors, along with the rare benefit of a double garage. The ground floor comprises a generously sized living room, featuring a bay window that allows for an abundance of natural light. To the rear, a separate dining room provides an ideal space for entertaining. The adjoining kitchen is well laid out, offering ample storage and workspace, with direct access to the garden. Upstairs, the property offers two well-proportioned bedrooms, including a particularly spacious principal bedroom with excellent floor space. A family bathroom completes the first-floor accommodation. Externally, the home benefits from its end-of-terrace position, providing additional privacy and side access as well as off street parking for two cars via the paved driveway. To the rear, the property boasts a double garage—ideal for secure parking, storage, or potential workshop use. Clyfford Road is conveniently located close to local amenities, well-regarded schools, and excellent transport links, making this property an ideal purchase for first-time buyers, downsizers, or investors alike.

TWO BEDROOM END TERRACE HOUSE

LARGE LIVING ROOM

SEPARATE DINING ROOM

FAMILY BATHROOM

OFF STREET PARKING

GALLEY KITCHEN

MODERN INTERIOR THROUGHOUT

QUIET LOCATION

WALKING DISTANCE TO RUISLIP GARDENS STATION

777 SQ.FT. TOTAL

These particulars are intended as a guide and must not be relied upon as statements of fact. Your attention is drawn to the Important Notice on the last page.





Ground Floor

Approx. 42.1 sq. metres (453.4 sq. feet)
(excluding Garage, Garage)

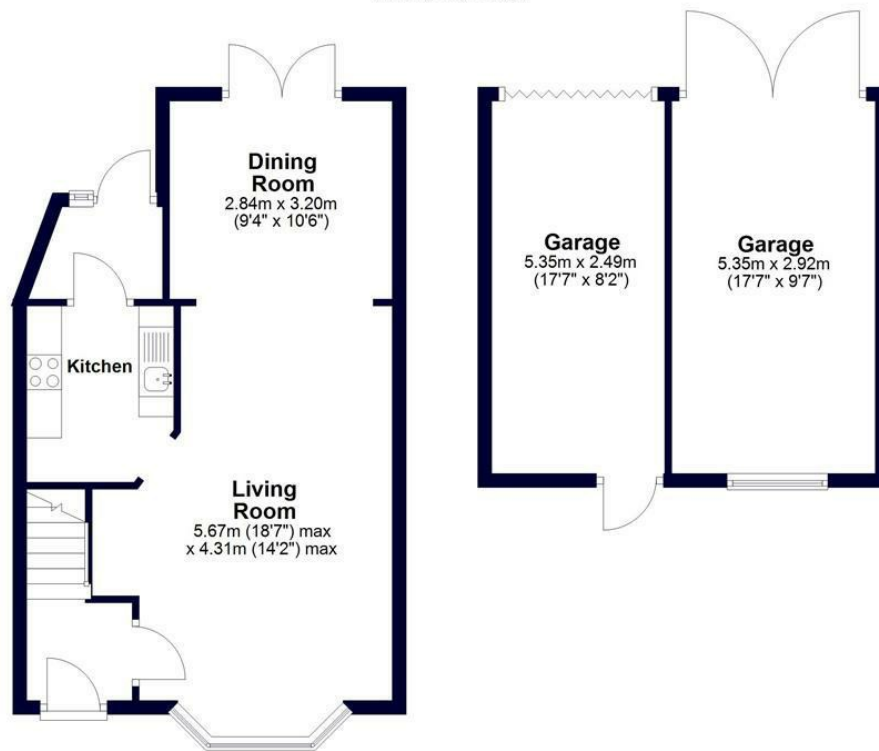

First Floor

Approx. 30.1 sq. metres (323.9 sq. feet)



Total area: approx. 72.2 sq. metres (777.3 sq. feet)



Whilst every effort has been made to ensure the accuracy of this floor plan, measurements of doors, windows, rooms and other items are approximate and no responsibility is taken for any errors. This plan is for illustrative purposes only and should be used as such by any prospective purchaser.
©Property Pot. Produced on behalf of Coopers Residential.



71 Victoria Road, Ruislip Manor,
Middlesex, HA4 9BH
ruislipmanor@coopersresidential.co.uk

CoopersResidential.co.uk

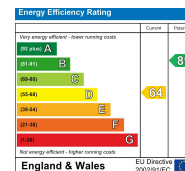

Important Notice: These particulars, whilst believed to be accurate are set out as a general outline only for guidance and do not constitute any part of an offer or contract. Intending purchasers should not rely on them as statements or representation of fact, but must satisfy themselves by inspection or otherwise has the authority to make or give any representation or warranty in respect of the property.