



Grierson Road, SE23
£950,000

Dexters



Grierson Road, SE23

A spacious four-bedroom family home of over 1,600 sq ft, perfectly positioned in a desirable location close to stations and local amenities. Offering generous living space, a west facing garden and exciting potential to extend (STPP).

This spacious 1930s home offers generous proportions across three floors and blends period character with modern family living. The ground floor has a welcoming hallway leading to a bay-fronted reception room. To the rear, a bright and spacious reception/dining room opens directly onto the west facing garden, seamlessly connecting to a modern kitchen with ample storage. A WC completes this level. On the first floor, the principal bedroom benefits from a large bay window, with two further well proportioned bedrooms and a stylish family bathroom. The top floor offers a spacious fourth bedroom with fitted storage and access to the eaves.

Grierson Road is set in a leafy pocket of Honor Oak, just a short walk from Honor Oak Park station, offering quick links into central London. The area is sought after by families, with several well-regarded schools nearby, including Stillness, Dalmain, and Harris Girls' Academy. Green spaces such as Horniman Gardens, One Tree Hill, and Peckham Rye Park are all close by, adding to the area's charm and community feel.

Features

- Spacious Family Home
- Four Bedrooms
- Over 1600 sq ft.
- Potential To Extend (STPP)
- Desirable Location
- Close To Stations







Grierson Road,
London, SE23

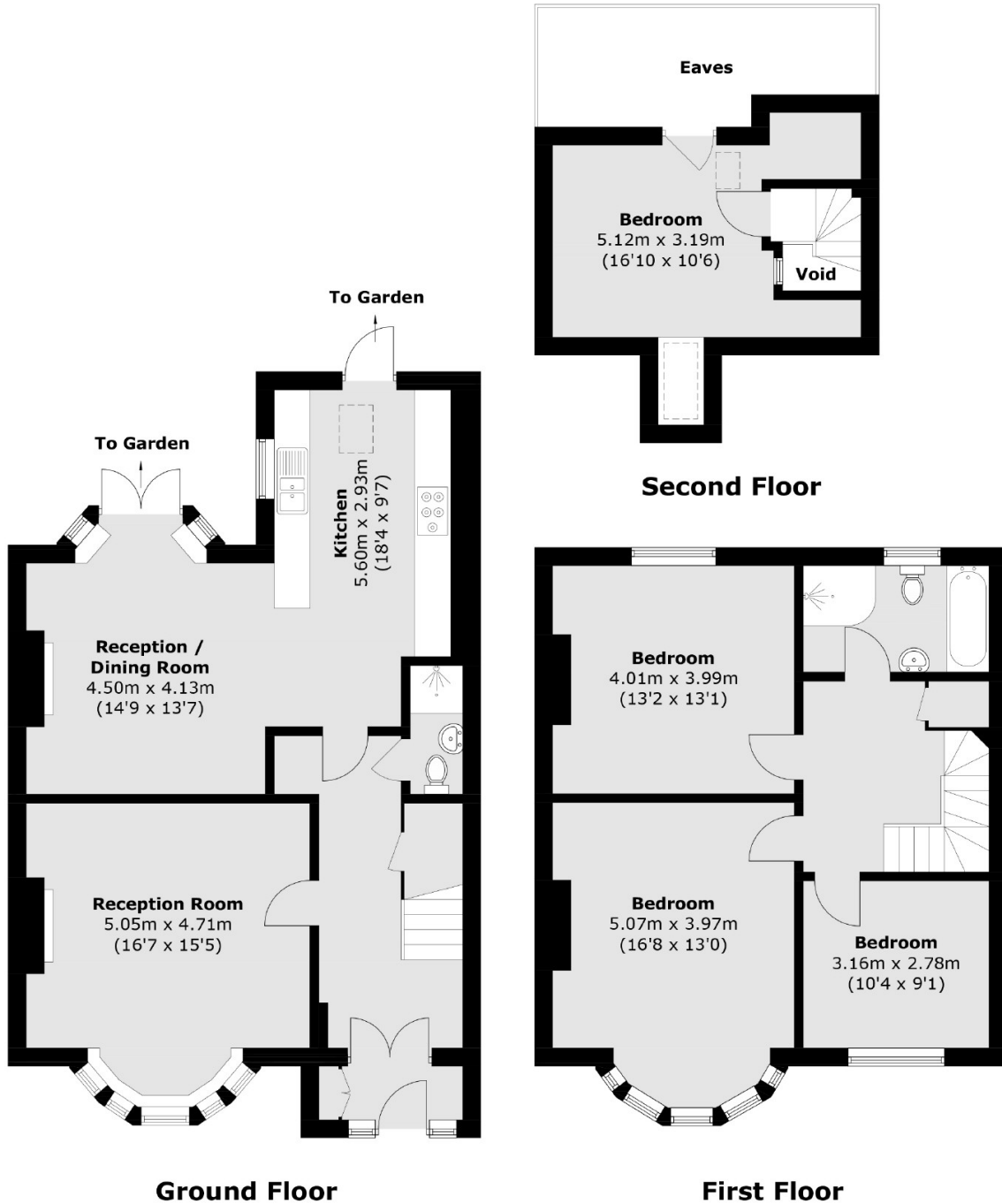

Total area (approx.): 150.9 sq. m (1,624.2 sq. ft)
(Excluding Eaves / Void)