



Mill Plat Avenue, TW7

£549,950

A charming and beautifully presented two double bedroom period home, ideally situated in one of Isleworth's most sought-after residential locations. Arranged over two floors, this characterful property boasts an abundance of original features, including high ceilings, feature fireplaces, and timeless period charm throughout. Offered to the market with no onward chain, this exceptional purchase provides a great rental income currently, ideal for investor buyers. Further benefits include a generous secluded rear garden and there is further scope to extend (STPP).

Mill Plat Avenue is ideally located close to excellent local schools, amenities and riverside pubs of Old Isleworth whilst the many shops, bars and restaurants of Twickenham and Richmond are nearby. Isleworth train station is a short walk offering excellent links to London, as well as easy access to the A4/M4 motorway.

Features

- Period House
- Two Double Bedrooms
- Large Garden
- Scope to Extend (STPP)
- Sought After Location
- No Chain

Mill Plat Avenue, Isleworth, TW7

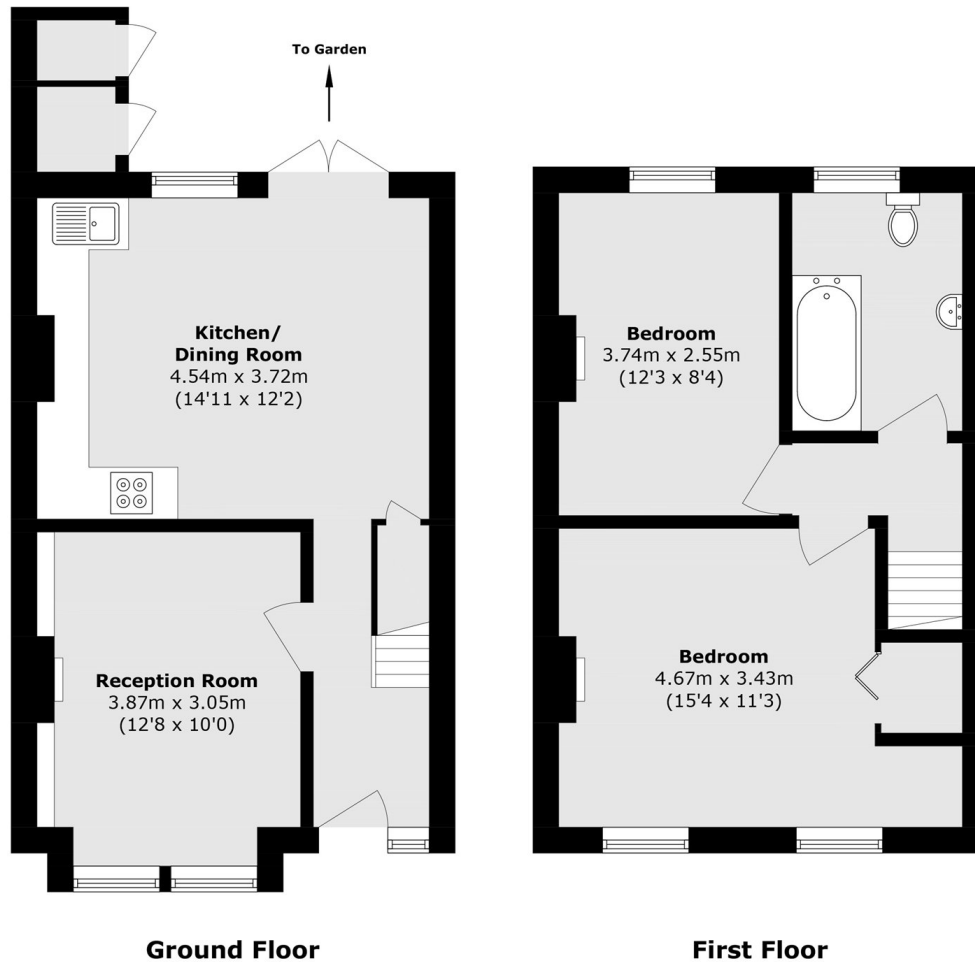

Ground Floor **First Floor**

Total area (approx.): 68.4 sq. m (736.3 sq. ft)
External Storage area (approx.): 1.5 sq. m (16.1 sq. ft)