



**POOLE  
TOWNSEND**

Woodside Gardens, Ashmount Road, Grange over Sands  
£650,000

3 3 2



- Private edge-of-town-centre setting with space, style, and tranquillity
- Far-reaching views across Morecambe Bay from almost every room
- Welcoming living room with wood-burning stove and bay window opening to a terrace
- Bright extended kitchen/diner opening onto a covered patio, ideal for entertaining
- Two further double bedrooms upstairs, plus landscaped split-level gardens, water feature, and ample off-road parking
- Extensive, beautifully maintained gardens surrounding the property
- Light-filled accommodation arranged over two floors
- Luxurious principal suite with built-in wardrobes and en-suite bathroom
- Practical ground floor with utility room, shower room, and integral double garage
- Freehold. Council Tax E



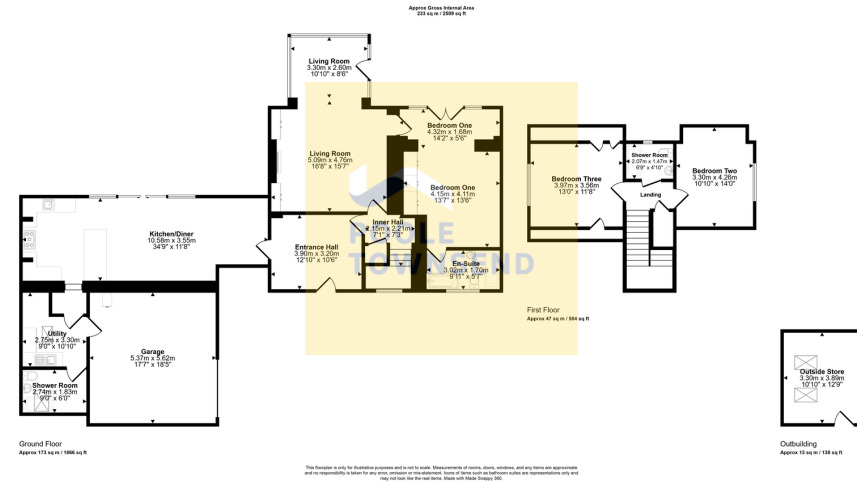

Occupying a private position on the edge of the town centre, this exceptional home combines space, style, and tranquillity within extensive, beautifully maintained gardens. From almost every room, far-reaching views across Morecambe Bay provide a breathtaking backdrop. The light-filled interiors are arranged over two floors, with a welcoming living room featuring a wood-burning stove and bay window opening onto a terraced seating area. The principal suite is a luxurious retreat with built-in wardrobes and en-suite bathroom, while the extended kitchen/diner, flooded with natural light, opens onto a covered patio and gardens, ideal for entertaining. A utility room, ground-floor shower room, and integral double garage complete the ground floor. Upstairs, two further double bedrooms with eaves storage and a modern shower room offer family accommodation. Split-level lawns, patio areas, a water feature, and garden store

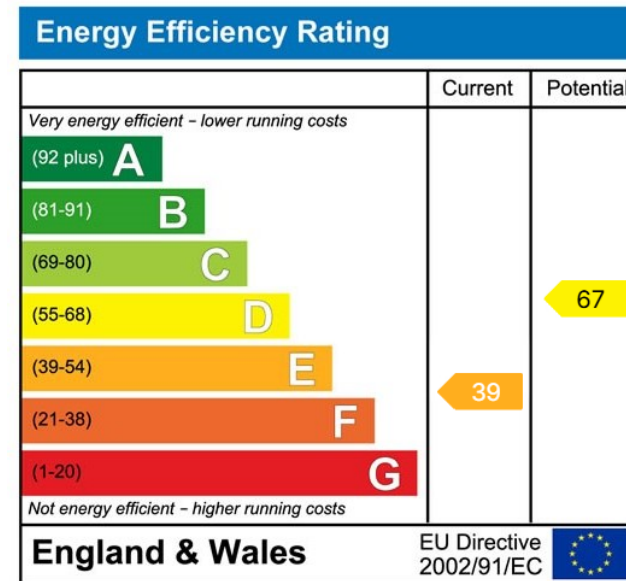

Visit us at  
[www.pooletownsend.co.uk](http://www.pooletownsend.co.uk)  
[enquiries@pooletownsend.co.uk](mailto:enquiries@pooletownsend.co.uk)

We are open  
 Monday – Friday 9.00 – 5.00  
 Saturday 9.00 – 1.00

Barrow 01229 811811  
 Ulverston 01229 588111  
 Grange 015395 33316  
 Kendal 01539 734455  
 Milnthorpe 015395 62044