



**Ian Anthony**  
The Estate Agents



Woodland Avenue, Scarisbrick, Ormskirk, L40 9QL

Offers Over £300,000

🛏 4 🍽 2 🛋 2





- FOUR GENEROUSLY SIZED BEDROOMS
- SPACIOUS END OF TERRACE FAMILY HOME
- GENEROUS PLOT OF OVER 1,700 SQUARE FEET
- DESIRABLE SEMI-RURAL LOCATION IN SCARISBRICK
- TWO LARGE RECEPTION ROOMS
- MODERN KITCHEN WITH INTEGRATED APPLIANCES
- BI-FOLD DOORS LEADING TO PRIVATE REAR GARDEN
- UNINTERRUPTED COUNTRYSIDE VIEWS
- LARGE DRIVEWAY WITH AMPLE OFF-ROAD PARKING
- READY TO MOVE INTO THROUGHOUT



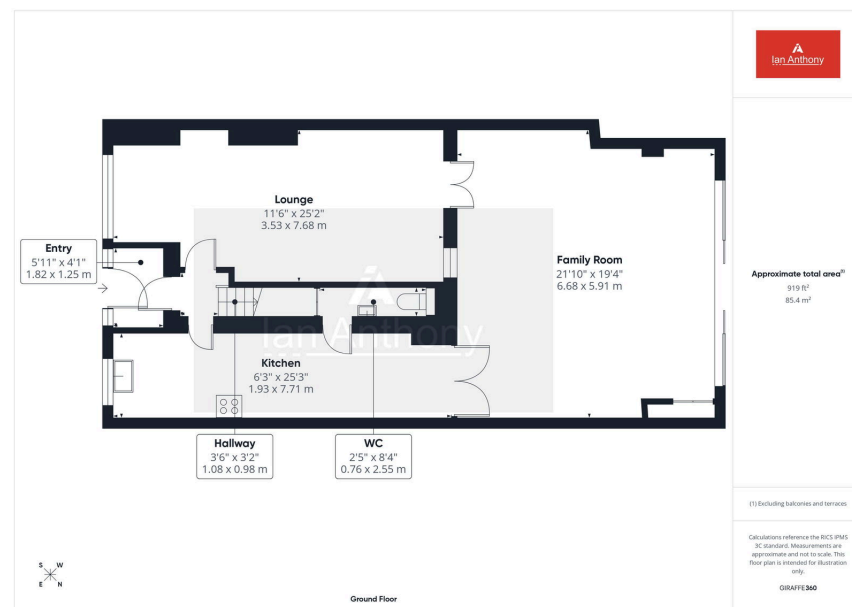

This well-presented four-bedroom end of terrace home occupies a generous plot of over 1,700 square feet and is situated on Woodland Avenue in Scarisbrick, a desirable semi-rural location. Ready to move into, the property offers spacious and versatile accommodation, making it a perfect family home. To the front, a large driveway provides ample off-road parking.

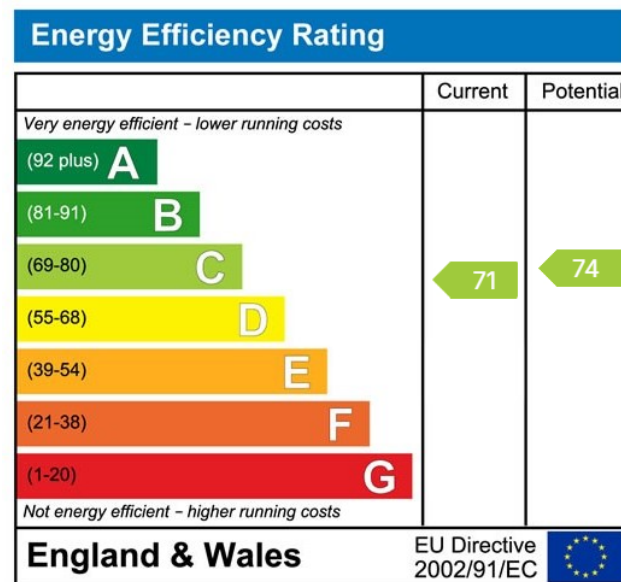

These particulars, whilst believed to be accurate are set out as a general outline only for guidance and do not constitute any part of an offer or contract. Intending purchasers should not rely on them as statements of representation of fact, but must satisfy themselves by inspection or otherwise as to their accuracy. No person in this firm's employment has the authority to make or give any representation or warranty in respect of the property.

5 Burscough Street, Ormskirk, Lancashire, L39 2EG

Tel: 01695 580888 Email: [enquiries@iananthonystates.co.uk](mailto:enquiries@iananthonystates.co.uk) <https://www.iananthonystates.co.uk>