



21 Lancaster Road, Harlescott, Shrewsbury, Shropshire, SY1 3JG

£110,000

This 2 bedroom ground floor flat offers large accommodation throughout and is being offered with no upward chain. Includes: Enclosed Porch, Living Room, Kitchen. Inner Hall leads to 2 spacious Bedrooms and Refitted Bathroom. Garden and 2 useful Stores. DG. Convenient range of amenities in the immediate area.



21 Lancaster Road, Harlescott, Shrewsbury, Shropshire, SY1 3JG

The mention of any appliances and/or services within these sales particulars does not imply that they are in full and efficient working order.

Accommodation comprises

Entrance door with spy hole.

Entrance Porch

Living Room

A good size room with wood style laminate flooring and large double glazed window to the front, wooden ornamental fire surround, gas fire set to tiled hearth.

Kitchen

Fitted base and eye level units laminated work tops, inset sink unit, tiled splashback, built in pantry cupboard, double glazed window.

Inner Hall

Built in store cupboard.

Bedroom 1

Double glazed window, built in airing cupboard housing hot water cylinder.

Bedroom 2

Another good size room with double glazed window.

Bathroom

Fitted with white 3 piece suite providing corner bath with tiled walls around and wall mounted electric shower unit, wash basin and WC, tiled flooring, extractor and double glazed window.

Outside

There is a communal area for bins etc and 2 integral stores/sheds.

Services

We understand that mains water, drainage, electricity and gas are connected to the property.

Lease details

The property is held on a 125 year lease from 4 May 2004 with 103 years remaining. Ground rent and service charges to be confirmed.

Council Tax Band A

Tenure: Our client advises us that the property is Leasehold. Should you proceed with the purchase of the property, these details must be verified by your solicitor.

Viewing: To arrange a viewing call in at our office or telephone **01743 248351**

Approx Gross Internal Area
52 sq m / 564 sq ft

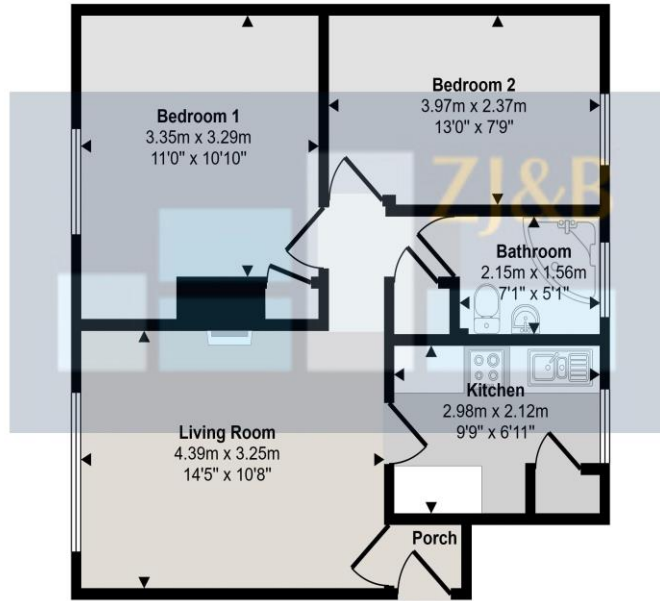

Floorplan

This floorplan is only for illustrative purposes and is not to scale. Measurements of rooms, doors, windows, and any items are approximate and no responsibility is taken for any error, omission or mis-statement. Icons of items such as bathroom suites are representations only and may not look like the real items. Made with Made Snappy 360.

FLOOR PLANS FOR GUIDANCE ONLY

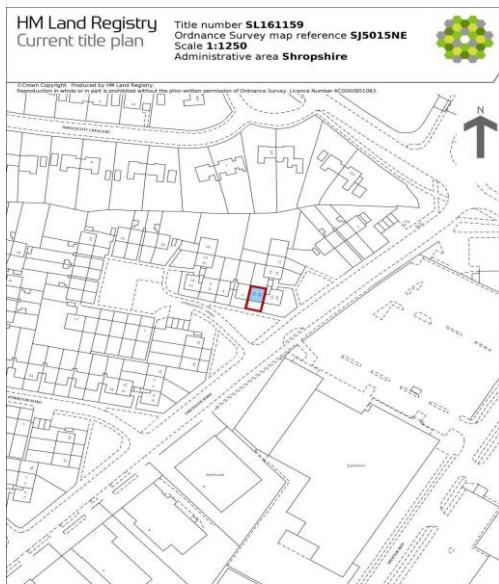

This is a copy of the title plan on 13 FEB 2026 at 15:59:01. This copy does not take account of any application made after that time even if still pending in HM Land Registry when this copy was issued.

This copy is not an "Official Copy" of the title plan. An official copy of the title plan is admissible in evidence in a court to the same extent as the original. A person is entitled to be indemnified by the registrar if he or she suffers loss by reason of a mistake in an official copy. If you want to obtain an official copy, the HM Land Registry web site explains how to do this.

HM Land Registry endeavours to maintain high quality and scale accuracy of title plan images. The quality and accuracy of any print will depend on your printer, your computer and its print settings. This title plan shows the general position, not the exact line, of the boundaries. It may be subject to distortions in scale. Measurements scaled from this plan may not match measurements between the same points on the ground.

This title is dealt with by HM Land Registry, Telford Office.

13/02/2026, 15:41

Energy performance certificate (EPC) - Find an energy certificate - GOV.UK

Find an energy certificate (/)

English | Cymraeg

Energy performance certificate (EPC)

21 Lancaster Road SHREWSBURY SY1 3JG	Energy rating D	Valid until: 8 October 2035
		Certificate number: 9004-1207-6905-4102-0004

Property type Ground-floor maisonette

Total floor area 54 square metres

Rules on letting this property

Properties can be let if they have an energy rating from A to E.

You can read [guidance for landlords on the regulations and exemptions](https://www.gov.uk/guidance/domestic-private-rented-property-minimum-energy-efficiency-standards-landlord-guidance) (<https://www.gov.uk/guidance/domestic-private-rented-property-minimum-energy-efficiency-standards-landlord-guidance>).

Energy rating and score

This property's energy rating is D. It has the potential to be D.

[See how to improve this property's energy efficiency.](#)



FREE MORTGAGE ADVICE

Whether you are a first time buyer, moving home, buying as an investor or looking to save on your mortgage payments, you will benefit from some **free** no obligation mortgage advice. To arrange an appointment with Stephen Bath of Bee Mortgages, who is based at our office, call us on **01743 248351**

Whole of Market, clear and relevant tailored to your individual needs and circumstances.

Your home may be repossessed if you do not keep up repayments on your mortgage