



6, Cadman Place, The Old Meadow, Shrewsbury, SY2 6AN
£1,750 Per Month



6, Cadman Place, The Old Meadow, Shrewsbury, SY2 6AN

£1,750 Per Month

VIRTUAL TOUR AVAILABLE - A beautifully presented recently built four bedroom town house situated within this prestigious gated development overlooking superb landscaped grounds, River Severn and Shrewsbury town centre.

Available: 03/09/26

Description

Comprising: Entrance hall including store cupboards, cloakroom, kitchen/dining room including integrated appliance and double doors to private garden, first floor living room with balcony, cloakroom, master bedroom with balcony, dressing area and en-suite, 3 further double bedrooms, 1 with en-suite, family bathroom including shower, driveway parking for two cars, integral garage with utility area and substantial built in storage, private garden, double glazed windows, gas fired central heating. EPC B



Unfurnished

Council Tax Band: D

Available: 3rd September 2026

EPC: C

Floor Plans

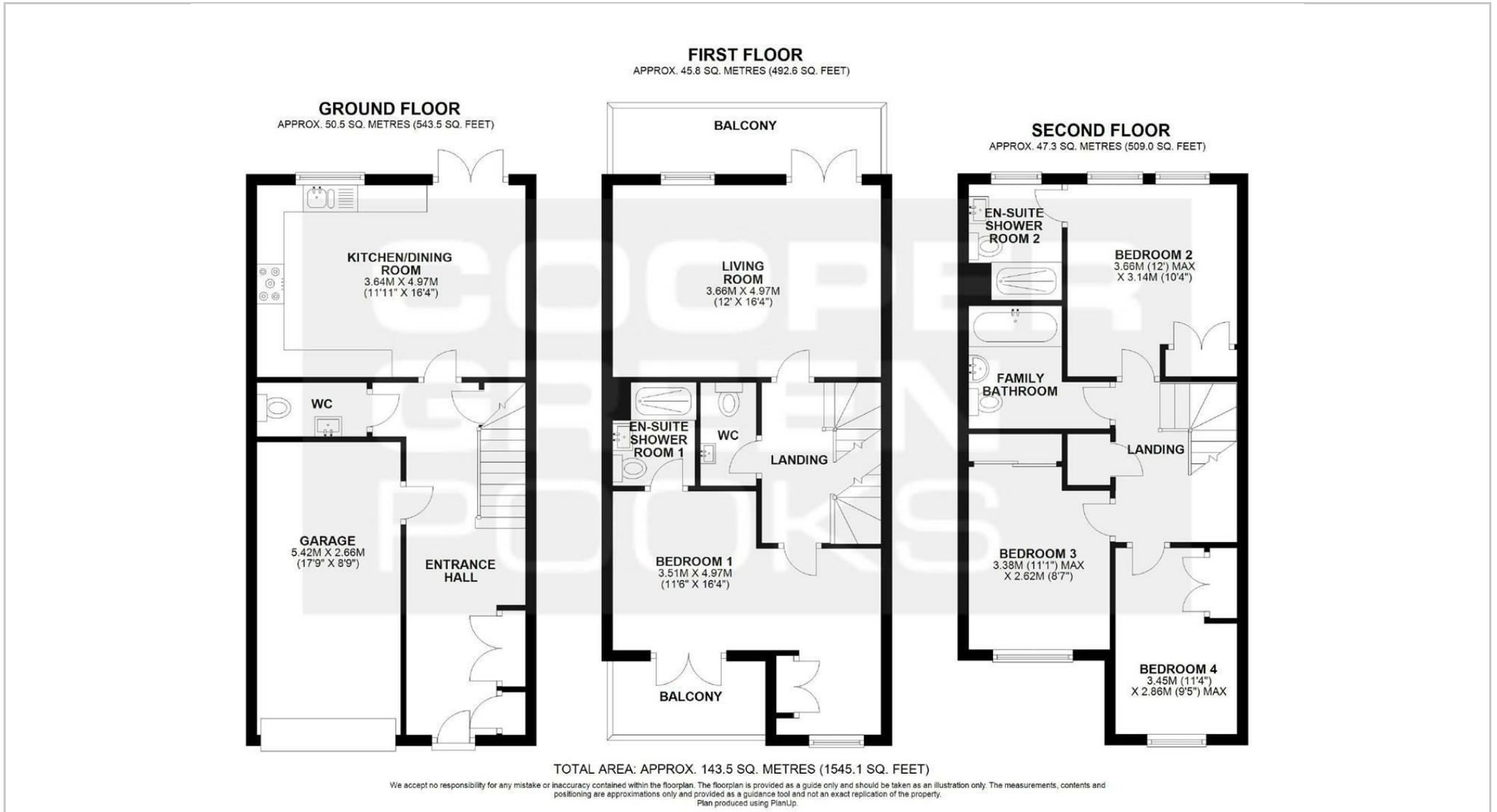

These particulars, whilst believed to be accurate are set out as a general outline only for guidance and do not constitute any part of an offer or contract. Intending purchasers should not rely on them as statements of representation of fact, but must satisfy themselves by inspection or otherwise as to their accuracy. No person in this firm's employment has the authority to make or give any representation or warranty in respect of the property.