



Paul Coutts Estate Agency Ltd
102 Brudes Hill
Inverness
IV3 8AT



PAUL COUTTS
ESTATE AGENCY

Creag Na Caillich Sworddale, Evanton, Dingwall, IV16 9XA

Offers Over £415,000

🛏 4 🚿 3 🚗 2



- HOME REPORT UNDER THE EPC SECTION
- SET IN AN IDYLIC AND PRIVATE LOCATION
- FOUR BEDROOMS
- CHARMING BALCONY
- OPEN VIEWS THROUGHOUT
- VERY WELL PRESENTED
- SUMMER HOUSE
- SUBSTANTIAL PLOT
- VERSATILE ACCOMODATION
- VIEWING HIGHLY RECOMMENDED



Set on a substantial plot in the peaceful and sought after area of Evanton, this exceptionally presented four-bedroom detached family home offers flexible and generous accommodation, stunning views across the firth, countryside and beyond and is set in a private and idyllic location. Offering four bedrooms, a summer house and a charming balcony this property must be viewed to be fully appreciated.

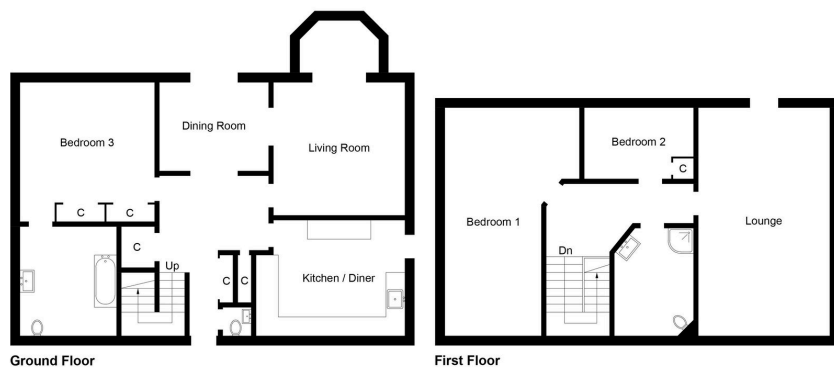

Illustration for identification purposes only, measurements are approximate, not to scale. Fourlabs.co © (ID1309805)

