

Exeter Road, Mapesbury, NW2

Guide Price £1,000,000

🛏 4 🚿 3 🚿 1



Guide Price: £1,000,000 to £1,100,000

Set on one of the Mapesbury Conservation Area's most desirable streets, this exceptional four-bedroom, three-bathroom split-level duplex occupies the upper floors of a handsome Victorian building and offers over 1,500 sq ft of beautifully designed living space. The apartment combines loft-style volume with the warmth and practicality of a family home.

Oli & Liana are delighted to be instructed on this spectacular home.

Key Features

- Guide Price: £1,000,000 to £1,100,000
- Arranged over the upper floors of a handsome Victorian building
- Stylish open-plan kitchen with quality appliances, gas hob and steam oven
- Two generous en suites, family bathroom and additional guest WC
- Exceptionally well-managed building
- Over 1,600 sq ft four-bedroom, three-bathroom split-level duplex
- Reception room flooded with natural light and air-conditioning
- Four double bedrooms with excellent built-in storage throughout
- Loft-style top floor with southwest-facing views across London
- Prime Mapesbury Estate location moments from Kilburn Station and close to Queen's Park

Exeter Road
 Approx. Total Internal Area 1856 Sq Ft - 172.43 Sq M
(Including Eaves Storage & Restricted Height Area)
 Approx. Gross Internal Area 1635 Sq Ft - 151.90 Sq M
(Excluding Eaves Storage & Restricted Height Area)

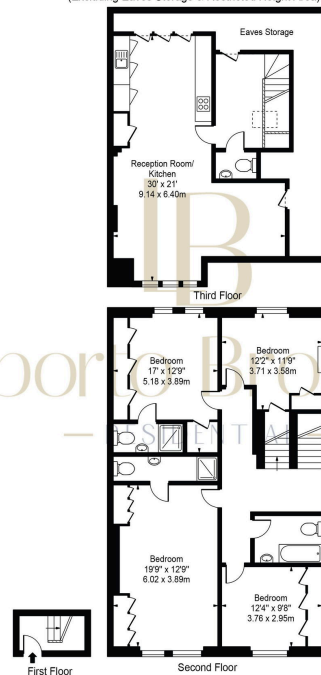

For Illustration Purposes Only - Not To Scale

This floor plan should be used as a general outline for guidance only and does not constitute in whole or in part an offer or contract.
 Any intending purchaser or lessee should satisfy themselves by inspection, searches, enquiries and full survey as to the correctness of each statement.
 Any areas, measurements or distances quoted are approximate and should not be used to value a property or be the basis of any sale or let.