



**Hollyfield, HATFIELD AL10 8LW**

**welcome to**

**Hollyfield, HATFIELD**

This two bedroom ground floor apartment is ideally situated for commuter links via the A414, A1(M), and mainline rail links into London. Internally the property comprises of entrance hall, kitchen, lounge with patio doors to the rear, two bedrooms and bathroom. Further benefits include gas central heating and double glazing throughout. Externally the property offers resident parking and communal gardens.



### Entrance Hall

Laminate flooring, radiator, storage.

### Lounge

13' x 14' ( 3.96m x 4.27m )  
Patio doors to rear,

### Kitchen

Double glazed window to front, laminate flooring, tiled splashback, space for washing machine/dryer, electric oven/hob, integrated dishwasher, radiator.

### Bedroom One

9' x 12' ( 2.74m x 3.66m )  
Double glazed window to rear, carpet, fitted wardrobe, radiator.

### Bedroom Two

10' x 9' 10" ( 3.05m x 3.00m )  
Double glazed window to rear, carpet, fitted wardrobe, radiator.

### Bathroom

Double glazed window to front, bath with shower over, boiler, radiator, wash hand basin, W/C.

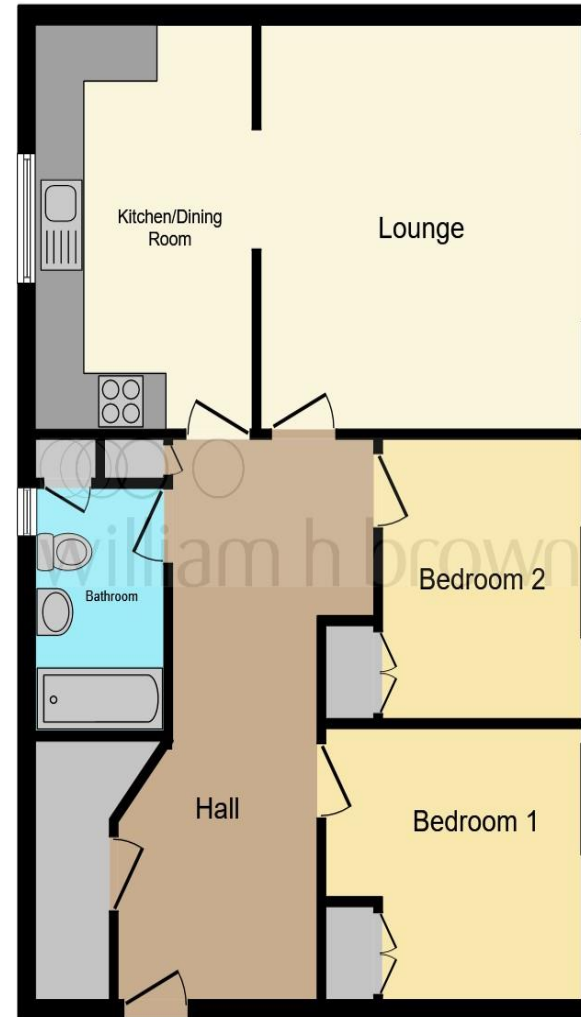

Total floor area 70.3 m<sup>2</sup> (756 sq.ft.) approx

This floor plan is for illustrative purposes only. It is not drawn to scale. Any measurements, floor areas (including any total floor area), openings and orientation are approximate. No details are guaranteed, they cannot be relied upon for any purpose and they do not form part of any agreement. No liability is taken for any error, omission or misstatement. A party must rely upon its own inspection(s). Powered by [www.focalagent.com](http://www.focalagent.com)



**check out more properties at** [williamhbrown.co.uk](http://williamhbrown.co.uk)



## welcome to Hollyfield, HATFIELD

- Two Bedrooms
- Ground Floor
- Resident Parking
- Communal Gardens

Tenure: Leasehold EPC Rating: C

Council Tax Band: C Service Charge: 624.33

Ground Rent: 10.00

This is a Leasehold property with details as follows; Term of Lease 125 years from 15 Jun 1987. Should you require further information please contact the branch. Please Note additional fees could be incurred for items such as Leasehold packs.

offers in excess of

# £220,000



Please note the marker reflects the  
postcode not the actual property

Check out more properties at [williamhbrown.co.uk](http://williamhbrown.co.uk)



Property Ref:  
WGN109164 - 0003

1. MONEY LAUNDERING REGULATIONS Intending purchasers will be asked to produce identification documentation at a later stage and we would ask for your co-operation in order that there is no delay in agreeing the sale. 2. These particulars do not constitute part or all of an offer or contract. 3. The measurements indicated are supplied for guidance only and as such must be considered incorrect. Potential buyers are advised to recheck measurements before committing to any expense. 4. We have not tested any apparatus, equipment, fixtures or services and it is in the buyers interest to check the working condition of any appliances. 5. Where an EPC, or a Home Report (Scotland only) is held for this property, it is available for inspection at the branch by appointment. If you require a printed version of a Home Report, you will need to pay a reasonable production charge reflecting printing and other costs. 6. We are not able to offer an opinion either written or verbal on the content of these reports and this must be obtained from your legal representative. 7. Whilst we take care in preparing these reports, a buyer should ensure that his/her legal representative confirms as soon as possible all matters relating to title including the extent and boundaries of the property and other important matters before exchange of contracts.

William H Brown is a trading name of Sequence (UK) Limited which is registered in England and Wales under company number 4268443, Registered Office is Cumbria House, 16-20 Hockliffe Street, Leighton Buzzard, Bedfordshire, LU7 1GN. VAT Registration Number is 500 2481 05.

  
william h brown



01707 324361



WelwynGardenCity@williamhbrown.co.uk



53 Wigmores North, WELWYN GARDEN CITY,  
Hertfordshire, AL8 6PG



[williamhbrown.co.uk](http://williamhbrown.co.uk)