



## Flat 5 27 Victoria Road, Sheffield, South Yorkshire, S10 2DJ

Rent: £695pcm – excludes utilities & council tax

Rent Schedule: Monthly in advance

Security Deposit: Total £695

Bills Package: Unihomes package available for electricity, water, internet & TV licence (optional)

Council Tax: Band A - not applicable for full-time students

EPC Rating: D

Tenancy Start Date: 2nd September 2026

**£695 Per Month**  
**Available: 2nd September 2026**

- Modern studio flat
- Contemporary kitchen
- Modern shower room
- Fully furnished
- First floor flat
- Close to Ecclesall Road
- Tenancy Start Date: 2nd September 2026
- Deposit - One months rent
- Rent - £695 pcm
- Unihomes Bills Package Available Upon Request

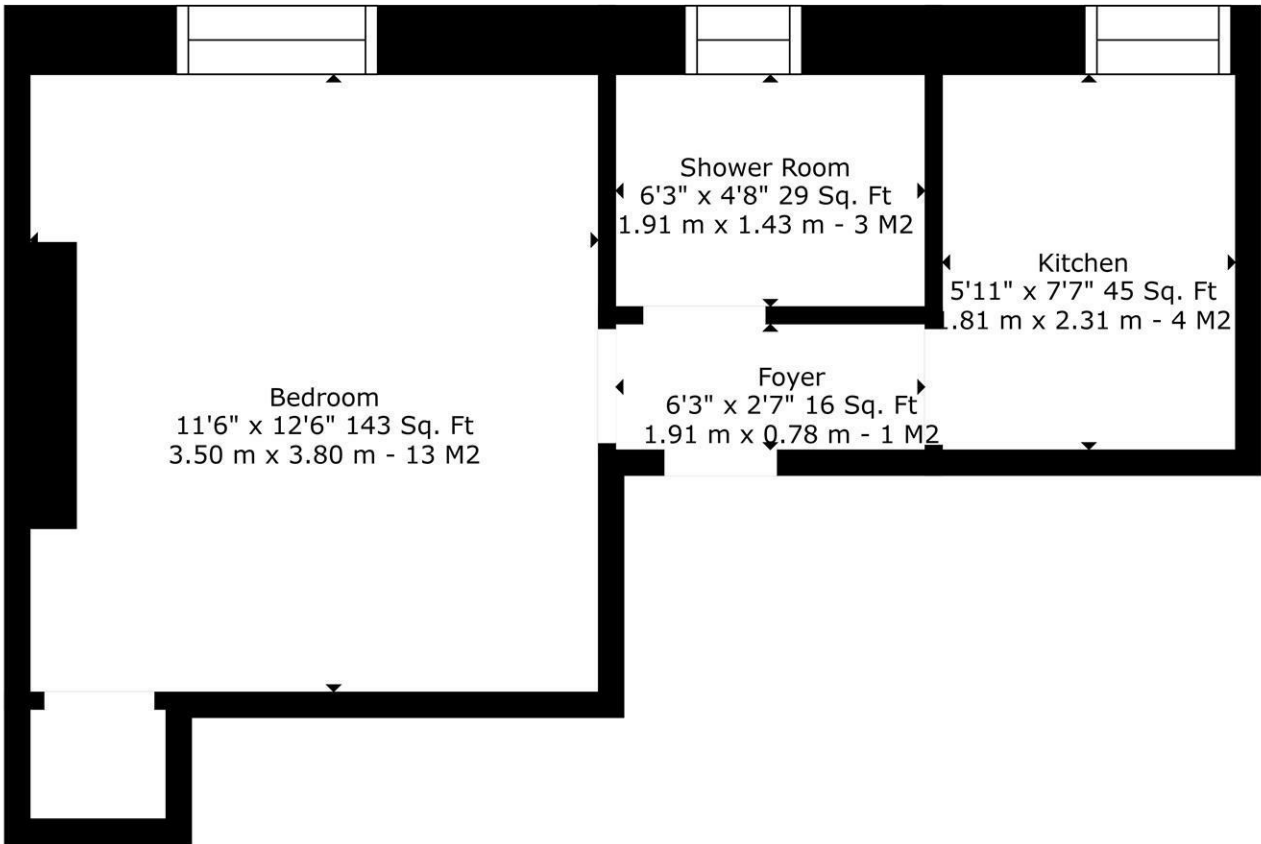

**TOTAL: 249 sq. ft, 23 m2**  
 27 VICTORIA ROAD FLAT 5: 249 sq. ft, 23 m2

Sizes And Dimentions Are Approximate. Actual May Vary

Energy Efficiency Rating		Current	Potential
Very energy efficient - lower running costs			
(92 plus) <b>A</b>			
(81-91) <b>B</b>			
(69-80) <b>C</b>			
(55-68) <b>D</b>			
(39-54) <b>E</b>			
(21-38) <b>F</b>			
(1-20) <b>G</b>			
Not energy efficient - higher running costs			
<b>England &amp; Wales</b>	EU Directive 2002/91/EC	<b>61</b>	<b>73</b>

Environmental Impact (CO <sub>2</sub> ) Rating		Current	Potential
Very environmentally friendly - lower CO2 emissions			
(92 plus) <b>A</b>			
(81-91) <b>B</b>			
(69-80) <b>C</b>			
(55-68) <b>D</b>			
(39-54) <b>E</b>			
(21-38) <b>F</b>			
(1-20) <b>G</b>			
Not environmentally friendly - higher CO2 emissions			
<b>England &amp; Wales</b>	EU Directive 2002/91/EC		