



5, Binary Mews Steep Bridge Way, Walsall Wood
Offers Over £150,000

🛏️ 2 🚿 2 🚗 1



- Ideal first home
- Recently refreshed throughout
- Juliet balcony
- Modern family bathroom
- Canal-side location
- Two-bedroom second-floor apartment
- Open-plan living space
- Ensuite to Bedroom one
- Garage and communal parking
- Move straight in





Ground Floor
Approx. 67.8 sq. metres (730.1 sq. feet)

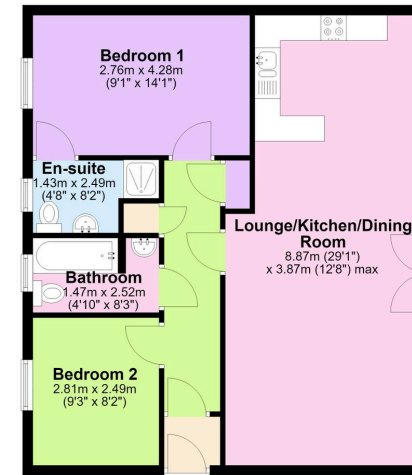

Total area: approx. 67.8 sq. metres (730.1 sq. feet)

This floor plan is for illustrative purposes only and may not be to scale. While every effort has been made to ensure accuracy, measurements are approximate and should not be relied upon for any purpose.
Plan produced using PlanUp.

Your first home should be exciting, not overwhelming, and this apartment gets that balance just right. Bought by the current owner before later becoming a home he shared with his wife, it's easy to see why it appealed. Freshly decorated throughout, this two-bedroom second-floor apartment is ready for someone else to move straight in and make it their own. With an open-plan living space, Juliet balcony, two bathrooms, a garage and the Wyrley & Essington Canal right on your doorstep, it's a home that offers more than just four walls. Whether you're buying on your own or together, this could be exactly what you've been waiting for.

