



**A FIRST FLOOR TWO BEDROOM, TWO BATHROOM APARTMENT IN THE HEART OF NORTHWOOD**

Dell Court, Green Lane, Northwood, Middlesex, HA6 2UT

**ROBSONS**

Dell Court, Green Lane, Northwood, Middlesex, HA6 2UT

**FIRST FLOOR • TWO BEDROOMS • TWO BATHROOMS • SPACIOUS LIVING ROOM • KITCHEN/DINING ROOM • BALCONY • ALLOCATED PARKING • GATED • LIFT IN BLOCK**

### Description

This very well-presented and generously sized first floor two-bedroom, two-bathroom apartment is set within an exclusive, privately gated development, ideally positioned in the heart of Northwood town centre.

The apartment comprises a spacious living room with a balcony, separate kitchen/dining room, two bedrooms one with an ensuite shower room and a family bathroom.

Further benefits included gated allocated parking and there is a lift in the block.





Northwood provides a range of shopping facilities including Waitrose supermarket, a variety of restaurants and other amenities with the Metropolitan Line station providing access to Baker Street and the City. There is a plethora of state and private schooling together with a wide choice of recreational facilities, which include golf courses and fitness centres. The M1, M40 and M25 motorways are also accessible.

NB this property is situated within the proximity of the ULEZ, if your vehicle does not comply charges may apply.

\*Please note the photographs displayed are not current\*

### **Additional Information**

Tenure: Leasehold

Lease Length: 125 years from 1 January 2007

Service Charge: £2,800 p/a

Ground Rent: £440 p/a

Local Authority: London Borough of Hillingdon

Council Tax Band: F

Energy Efficiency Rating: B

For additional information, please refer to [www.robsonswb.com](http://www.robsonswb.com) or call us on: 01923 835355.



Approximate Gross Internal Area = 96.9 sq m / 1043 sq ft

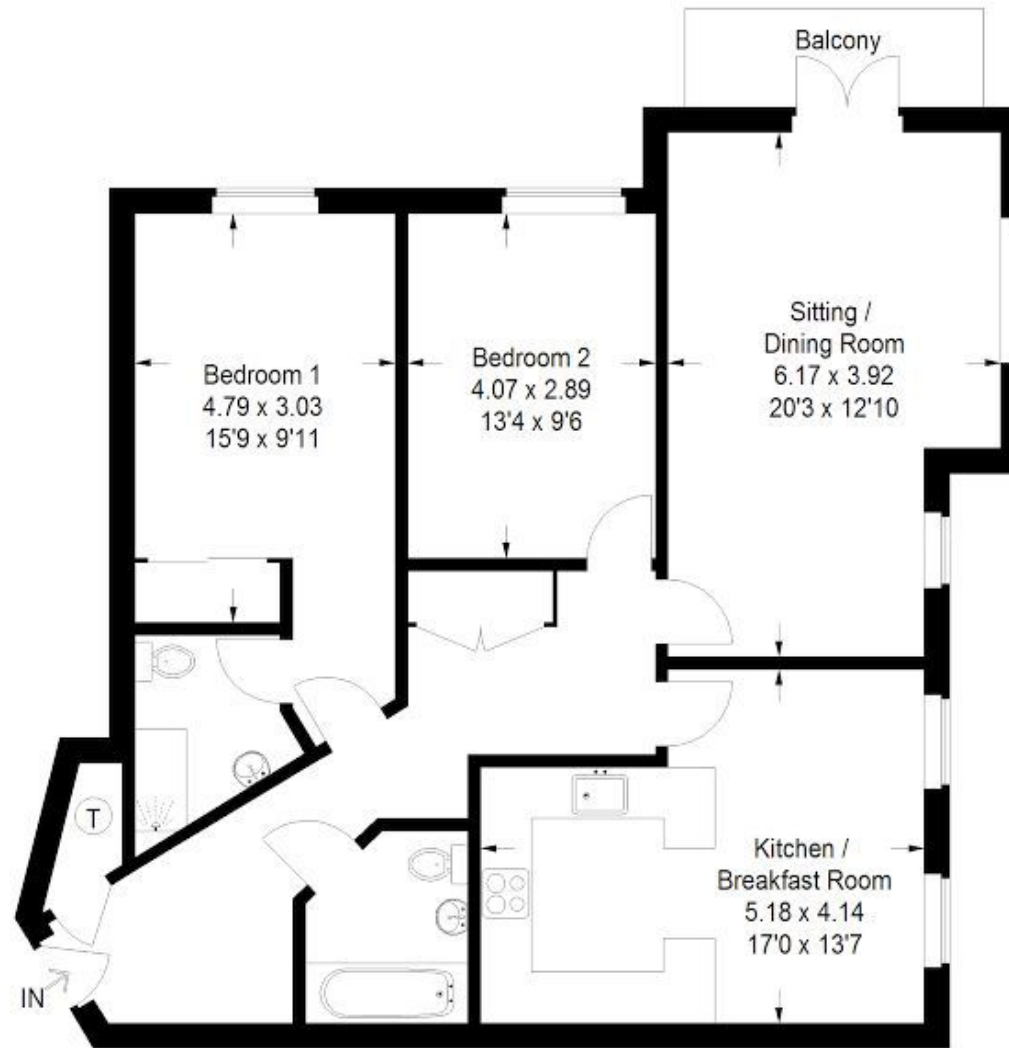

Illustration for identification purposes only, measurements are approximate, not to scale.

**ROBSONS**

7 Clive Parade, Northwood, HA6 2QF  
Tel: 01923 835355 Email: northwood@robsonswb.com  
[www.robsonswb.com](http://www.robsonswb.com)

SCAN TO VISIT



OUR WEBSITE

Important notice: Robsons, their clients and any joint agents give notice that 1: They are not authorised to make or give any representations or warranties in relation to the property either here or elsewhere, either on their own behalf or on behalf of their client or otherwise. They assume no responsibility for any statement that may be made in these particulars. These particulars do not form part of any offer or contract and must not be relied upon as statements or representations of fact. 2: Any areas, measurements or distances are approximate. Plot sizes and dimensions are taken from Promap and are approximate. The text, photographs and plans are for guidance only and are not necessarily comprehensive. It should not be assumed that the property has all necessary planning, building regulation or other consents and Robsons have not tested any services, equipment or facilities. Purchasers must satisfy themselves by inspection or otherwise.