



## 353 Finchley Road

Swiss Cottage, London, NW3 6ET

£3,200 Per month

This 2 bedroom property located on the third floor is designed by international architectural studio Lifschutz Davidson Sandilands is based on Bauhaus inspired modern architecture, a seamless fusion of the cool and contemporary with stylish ergonomically designed interiors.

The accommodation comprises of: Fully fitted open plan kitchen with large reception room leading onto a decked balcony with views over London; Main bedroom with built in storage; Second bedroom with built in storage along with one stylish family bathroom and one modern shower room.

The property further benefits from floor to ceiling windows. Located close to Finchley Road Tube Station and local amenities: O2 Centre, Waitrose, Sainsbury's and parkland of Hampstead Heath, Primrose Hill and Regents Park. Furnished

- Modern Apartment
- 2 Double Bedrooms
- 2 Bathrooms
- Secure Development With Lift
- Furnished
- Available 1st of March

### Viewing

Please contact us on 020 3198 4517 if you wish to arrange a viewing appointment for this property or require further information.



# Floor Plan

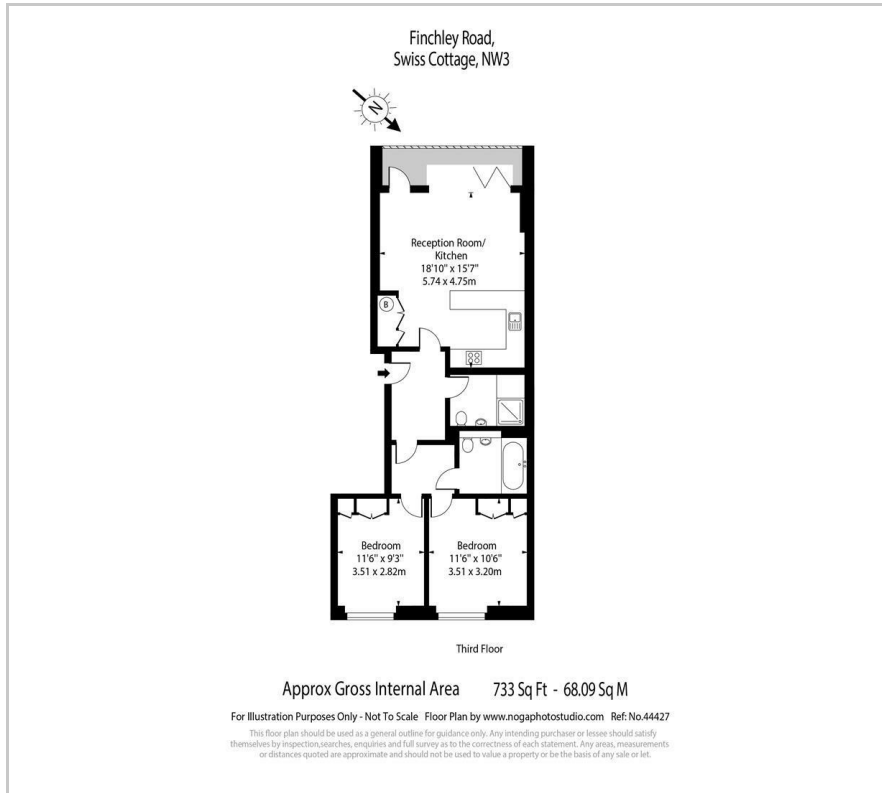

# Area Map



# Energy Efficiency Graph

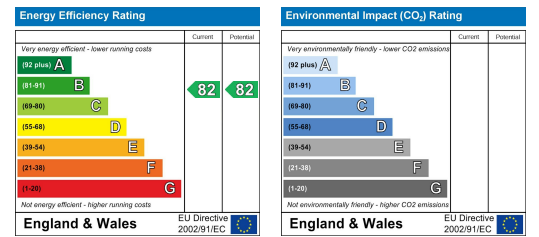

These particulars, whilst believed to be accurate are set out as a general outline only for guidance and do not constitute any part of an offer or contract. Intending purchasers should not rely on them as statements of representation of fact, but must satisfy themselves by inspection or otherwise as to their accuracy. No person in this firm's employment has the authority to make or give any representation or warranty in respect of the property.