

Energy Efficiency Rating		
	Current	Potential
Very energy efficient - lower running costs		
(92 plus) A		82
(81-91) B		
(69-80) C	75	
(55-68) D		
(39-54) E		
(21-38) F		
(1-20) G		

Environmental Impact (CO ₂) Rating		
	Current	Potential
Very environmentally friendly - lower CO ₂ emissions		
(92 plus) A		
(81-91) B		
(69-80) C		
(55-68) D		
(39-54) E		
(21-38) F		
(1-20) G		

We have endeavoured to supply this information as accurate as possible. Before making an offer, buying or renting this property please seek independent or professional advice.

Harvist Road, Queens Park, NW6 6HB

£2,200 Per Month

Subject to Contract

- Two double bedrooms a stones through of the park
- Hardwood worktop in modern kitchen
- High ceilings
- Ceiling mouldings
- Sizable reception room into bay
- White three piece suit
- Stripped timber floors
- Unfurnished except for the brown leather sofa



Harvist Road, NW6 6HB

Ideally located... spacious two double bedroom apartment, set on the first floor of this imposing three-story mid terraced period house, offering many features, which include high ceilings, timber floors, and only a stone's throw of "Queens Park", parklands.

The property offers well-proportioned accommodation, of over 679sqft of living/entertaining space, boasting high glossed striped timber floors within a sizable reception room into bay, lacquered kitchen units with wishbone handle, hardwood worktops, and white three piece bathroom suite.

Harvist Road is a tree-lined residential avenue ideally situated moments from the restaurants, bars, and coffee houses of Salusbury Road and just a walk away from Queens Park/Kensal Green (Bakerloo Line, British Rail) station.

Available 7th of February

Tel: +44 (0)2 8960 9988
Fax: +44 (0)2 8960 9989

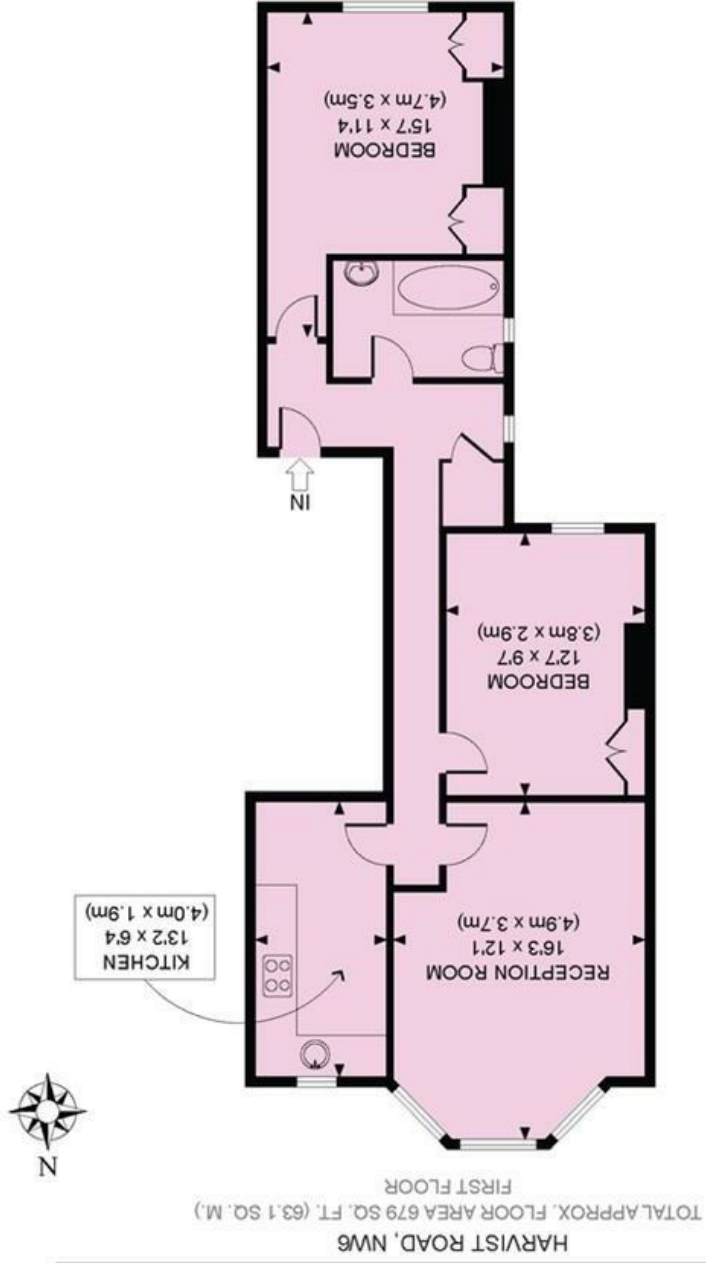

HARVIST ROAD, NW6
TOTAL APPROX. FLOOR AREA 679 SQ. FT. (63.1 SQ. M.)
FIRST FLOOR
N
KITCHEN 13'2" x 6'4" (4.0m x 1.9m)
RECEPTION ROOM 16'3" x 12'1" (4.9m x 3.7m)
BEDROOM 12'7" x 9'7" (3.8m x 2.9m)
BEDROOM 15'7" x 11'4" (4.7m x 3.5m)
BATHROOM
IN
All measurements walls, doors, windows, fittings and their appliances, their size and locations are shown conventionally and are approximate only and cannot be regarded as being a representation either by the seller or his agent nor zenluvo
www.zenluvo.co.uk



Email: mail@warwickestateagency.co.uk
warwickestateagents.tv | warwickestateagents.co.uk
69 Chamberlayne Road, London NW10 3ND
Tel: +44 (0)20 8960 9988 Fax: +44 (0)20 8960 9989