



**Connells**

Jupiter Avenue  
Peterborough



## Property Description

Situated within the popular Cardea development, this well-presented three bedroom detached house offers comfortable and practical accommodation, ideal for families, professionals or first-time buyers.

The ground floor comprises an inviting entrance hall with a convenient downstairs cloakroom. The lounge is positioned to the rear of the property and provides a bright and welcoming living space, with doors opening directly onto the enclosed rear garden. To the front is a modern kitchen/diner, offering ample space for everyday dining along with a range of fitted units and work surfaces.

Upstairs, the first floor accommodation includes three well-proportioned bedrooms. The main bedroom is of a generous size, complemented by a further good-sized second bedroom and a third bedroom which would make an ideal child's room, home office or dressing room. A contemporary family bathroom serves the first floor.

Externally, the property benefits from an enclosed rear garden, perfect for outdoor entertaining or family use. To the side, a double driveway provides off-road parking and leads to a detached garage, which benefits from power and lighting, offering excellent storage or workshop potential.

## Entrance Hall

Door to front, stairs to first floor and access to WC.

## Downstairs Wc

Window to the front, vinyl flooring, storage cupboard, WC and wash hand basin.

## Lounge

Window and patio door to rear, carpet, understairs cupboard and radiator.

## Kitchen

Window to the front, integrated oven with gas hob and hood, tiled flooring and splashbacks, space for appliance and dishwasher, wall mounted boiler in cupboard, high and low level storage with worktops over., stainless steel sink/drainer 1 and 1/2 basin with mixer tap.

## First Floor Landing

Loft access.

## Bedroom One

Window to the front, carpet and radiator.

## Bedroom Two

Window to the rear, carpet and radiator.

## Bedroom Three

Window to the rear, carpet and radiator.

## Bathroom

Bath with rainfall shower over (recently fitted), tiled walls and flooring, heated towel rail, window to the front, wash hand basin, WC, chrome heated towel rail and airing cupboard.

## Outside

### Rear Garden

Laid to lawn, patio area and door to garage.

### Front

Double driveway to side and detached garage.

### Garage

Power and lighting and electric up and over door.



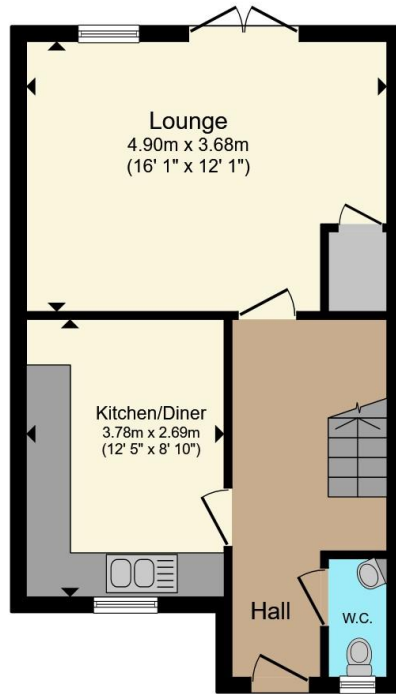

**Ground Floor**

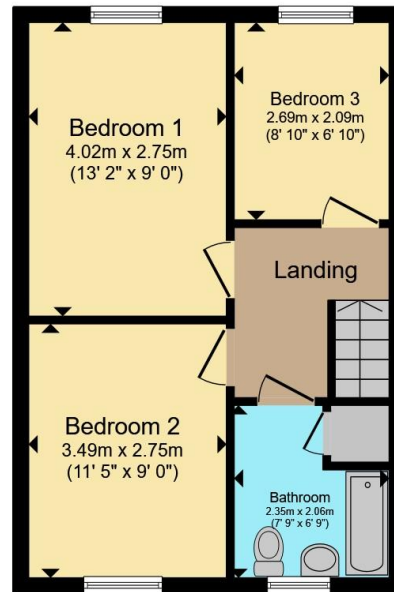

**First Floor**

Total floor area 76.4 m<sup>2</sup> (822 sq.ft.) approx

This floor plan is for illustrative purposes only. It is not drawn to scale. Any measurements, floor areas (including any total floor area), openings and orientation are approximate. No details are guaranteed, they cannot be relied upon for any purpose and they do not form part of any agreement. No liability is taken for any error, omission or misstatement. A party must rely upon its own inspection(s). Powered by [www.propertybox.io](http://www.propertybox.io)



To view this property please contact Connells on

**T 01733 314 775**  
**E [peterborough@connells.co.uk](mailto:peterborough@connells.co.uk)**

14 Cowgate  
PETERBOROUGH PE1 1NA

EPC Rating: Council Tax  
Awaited Band: C

**view this property online [connells.co.uk/Property/PBO312825](http://connells.co.uk/Property/PBO312825)**

Tenure: Freehold



1. MONEY LAUNDERING REGULATIONS Intending purchasers will be asked to produce identification documentation at a later stage and we would ask for your co-operation in order that there will be no delay in agreeing the sale. 2. These particulars do not constitute part or all of an offer or contract. 3. The measurements indicated are supplied for guidance only and as such must be considered incorrect. Potential buyers are advised to recheck measurements before committing to any expense. 4. We have not tested any apparatus, equipment, fixtures, fittings or services and it is in the buyers interest to check the working condition of any appliances.

Connells Residential is registered in England and Wales under company number 1489613, Registered Office is Cumbria House, 16-20 Hockliffe Street, Leighton Buzzard, Bedfordshire, LU7 1GN. VAT Registration Number is 500 2481 05.

**See all our properties at [www.connells.co.uk](http://www.connells.co.uk) | [www.rightmove.co.uk](http://www.rightmove.co.uk) | [www.zoopla.co.uk](http://www.zoopla.co.uk)**

Property Ref: PBO312825 - 0003