



Whitfield Street, W1T

£700 Per week

A modern third floor two bedroom property with wooden floors throughout. The property is centrally located on this popular street in the heart of Fitzrovia.

There is a huge selection of shops, restaurants, bars and cafés within easy reach and the nearest Underground Stations are Goodge Street and Tottenham Court Road Undergrounds.

Features

- Modern
- Two Double Bedrooms
- High Ceilings
- Wooden Floors
- Central Location
- Separate Kitchen

Whitfield Street, London, W1T

Third floor

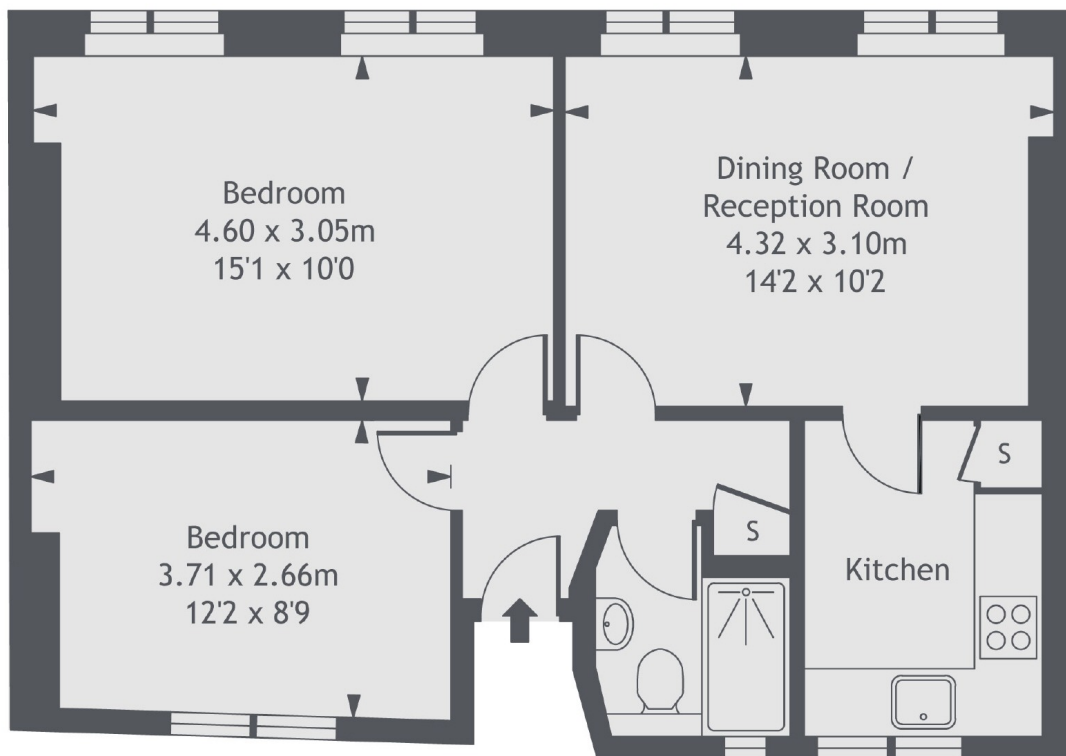

Gross Internal Area 550 sq ft (51.10 sq m)