



Stalbridge Walk, Corby

**STUART  
CHARLES**  
ESTATE AGENTS

# £245,000

Offered FOR SALE with NO CHAIN is this FOUR/FIVE bedroom semi detached home offered with tenants in situ. Currently rented as a LICENSED HMO the home was originally a four bedroom family home but currently is rented out by the room. The accommodation comprises to the ground floor of an entrance hall, three piece shower room, lounge/diner, kitchen and a family room/bedroom five with three piece en-suite. To the first floor are four bedrooms and a three piece bathroom suite, the master bedroom also features a three piece bathroom en-suite. Outside to the front is a split laid lawn which is enclosed by low level brick walls. To the rear a decking area leads to a laid lawn and to off road parking for multiple vehicles and a garage located on the end of the block.

- NO CHAIN
- LARGE LOUNGE
- THREE PIECE BATHROOM UPSTAIRS
- OFF ROAD PARKING AND GARAGE
- CLOSE TO SHOPS
- SOLD WITH TENANTS IN SITU
- TWO EN-SUITES
- THREE PIECE SHOWER ROOM ON GROUND FLOOR
- FLEXIBLE ACCOMODATION
- CLOSE TO MAINS BUS LINKS

## Entrance Hall

Entered via a double glazed door, double glazed window to side elevation, spotlights, radiator, tiled floor, stairs to first floor landing, doors to:

## Shower Room

Fitted to comprise a three piece suite consisting of a shower cubicle, low level wash hand basin, low level pedestal, radiator, extractor.

## Lounge/Diner

19'6 x 11'4 (5.94m x 3.45m )  
Double glazed window to front elevation, two radiators, Tv point, double glazed patio door to rear elevation, door to:

## Kitchen

14'5 x 9'5 (4.39m x 2.87m)  
Fitted to comprise a range of base and eye level units with single sink and drainer, electric hob and extractor,







electric oven, space for automatic washing machine, space for fridge/freezer, double glazed window to rear elevation, door to:

### Hall

Double glazed door to rear elevation, door to:

### Family Room

19'6 x 12'11 (5.94m x 3.94m)

Double glazed patio doors to rear elevation, radiator, door to:





### **En-Suite**

Fitted to comprise a three piece suite consisting of a bath with shower over, low level pedestal, low level wash hand basin, radiator, double glazed window to front elevation.

### **First Floor Landing**

Stairs rising from ground floor, loft access, doors to:

### **Bedroom One**

13'10 x 13'0 (4.22m x 3.96m)

Double glazed window to front elevation, radiator, door to:





**First Floor**

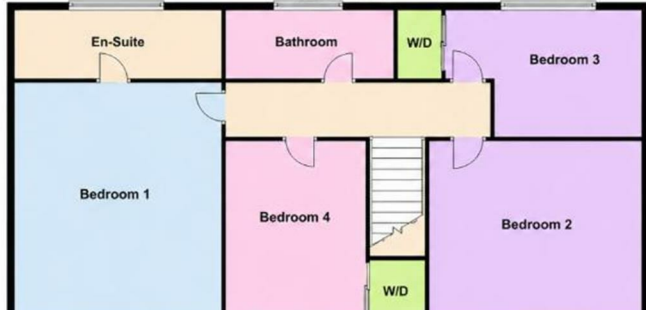

**En-Suite**

Fitted to comprise a three piece suite consisting of a corner bath with electric shower over, low level wash hand basin, low level pedestal, radiator, double glazed window to rear elevation.

**Bedroom Two**

11'5 x 10'2 (3.48m x 3.10m)

Double glazed window to front elevation, radiator.

**Bedroom Three**

11'6 x 9'2 (3.51m x 2.79m)

Double glazed window to rear elevation radiator, built in wardrobe.



### Ground Floor



### First Floor



## Bedroom Four

10'7 x 7'1 (3.23m x 2.16m)

Double glazed window to front elevation, radiator, built in wardrobe.

## Bathroom

Fitted to comprise a three piece suite consisting of panel bath, low level wash hand basin, low level pedestal, radiator, double glazed window to rear elevation.

## Outside

Front: A split laid lawn is enclosed by low level wall t all sides.

Rear: A decking area leads onto a laid lawn and this inturn leads to off road parking for multiple vehicles and a garage.

Garage: With up and over door and located at the end of the block.

