

Property ref: 32587

## Salisbury Road, Reading, RG30 1BN

**£1,550 PCM**

**HASLAM'S**  
Lettings



A newly redecorated three bedroom bay-fronted terraced home situated in a popular quiet no-through road close to Reading West railway station, local schools and the town centre - an ideal family home. Reading Borough Council tax band C.

Water supply: Mains

Drainage info: Mains

Electricity supply: Mains

Gas supply: Mains

Broadband/Mobile Info: Connections available. For an indication of specific speeds and supply of Broadband and Mobile, we advise applicants go to the Ofcom website Broadband and Mobile Coverage Checker.

- Two double bedrooms; One single bedroom
- Upstairs family bathroom
- Spacious kitchen with appliances
- Gas central heating; EPC rating C
- Permit parking available
- Unfurnished; Managed by HASLAM'S

### Available Now

\*Fees For Assured Shorthold Tenancies: when you rent a property from us you will be required to pay a sum equivalent to one weeks' rent for a holding deposit. Upon successful application, this amount will be off set against your first months' rent. You will also be required to pay a security deposit equivalent to 5 weeks' rent which will be held and protected in line with Deposit legislation. For more information about our fees please visit: [www.haslams.net](http://www.haslams.net)  
Fees for all other tenancies (Non Housing Act Tenancies / Company Lets): when you rent a property from us we will charge you a one-off fee per property. This charge is the equivalent of 15 days of the monthly rental charge (+VAT) with a minimum fee of £450 (inc.VAT) up to a maximum of £650 (inc.VAT). Other fees may apply depending on your circumstances.

**0118 960 1055**

**[lettings@haslams.net](mailto:lettings@haslams.net) [www.haslams.net](http://www.haslams.net)**

**Haslams Estate Agents Ltd, 159 Friar Street, Reading, Berkshire, RG1 1HE**









# Salisbury Road, Reading, RG30

Approximate Area = 872 sq ft / 81 sq m

Storage = 10 sq ft / 0.9 sq m

Total = 882 sq ft / 81.9 sq m

For identification only - Not to scale

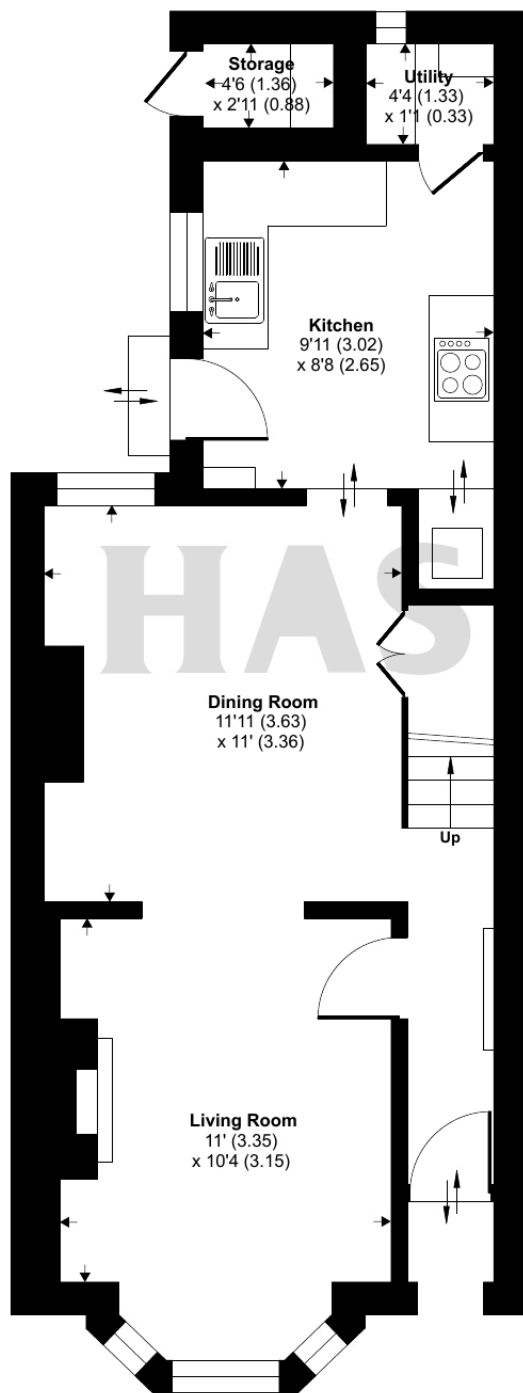

**GROUND FLOOR**

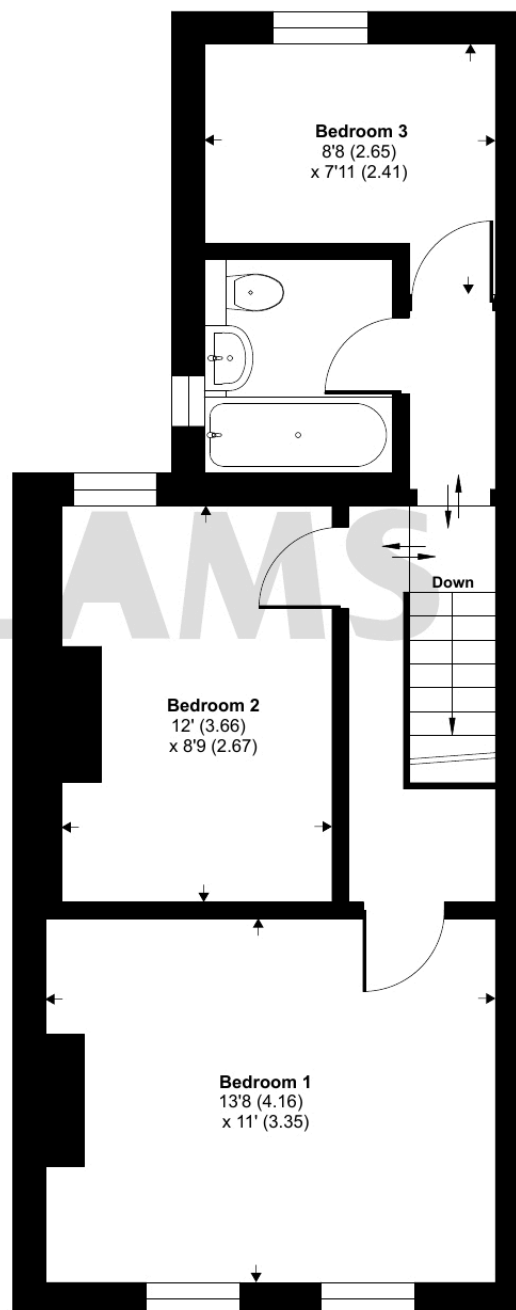

**FIRST FLOOR**



Floor plan produced in accordance with RICS Property Measurement 2nd Edition, Incorporating International Property Measurement Standards (IPMS2 Residential). © n̄checom 2026. Produced for Haslamss. REF: 1400875