

## 9 Houghton Avenue, King's Lynn PE30 3EG

£210,000

🛏 3 🚿 1 🚗 1



Situated in the popular Reffley area of King's Lynn, this extended three bedroom semi-detached bungalow offers an excellent opportunity for buyers looking to create a home to their own taste. Conveniently located close to local amenities, schools and transport links, the property enjoys a well-established residential setting.

## Key Features

- Semi-detached bungalow
- 3 bedrooms
- Desirable location
- Double glazed
- 19ft6 Lounge
- Extended
- No chain
- Great opportunity
- Garage
- Open fireplace

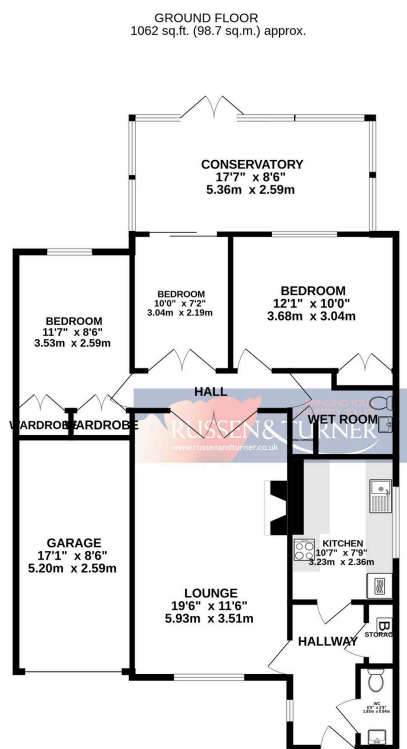

TOTAL FLOOR AREA: 1062 sq.ft. (98.7 sq.m.) approx.  
Whilst every attempt has been made to ensure the accuracy of the description contained herein, measurements of doors, windows, rooms and any other items are approximate and no responsibility is taken for any error, omission or mis-statement. This plan is for illustrative purposes only and should be used as such by any prospective purchaser. The services, systems and appliances shown have not been tested and no guarantee as to their operability or efficiency can be given.  
Made with Metropix C2028

