

15-17 Eastgate Street, Bury St. Edmunds, Suffolk, IP33 1XX  
Tel: 01284 760770  
bury@shiresestateagents.co.uk  
www.shiresresidential.com

shires

Estate & Letting Agents



## Brayfield Close, Bury St. Edmunds, Suffolk, IP32 7EN

Rent - £1,215 PCM      Deposit - £1,401

Situated in the popular Brayfield Close area, this well-presented two-bedroom terraced house offers comfortable living with a spacious reception room, family bathroom, and off-road parking.

Conveniently located close to local amenities, schools, and transport links, this property is ideal for professionals, couples, or small families.

**Agent's Note:**

Please be aware that images of the property may have been digitally enhanced, edited, or staged using artificial intelligence, and may not reflect the current presentation or furnishings.

- MODERN TERRACE HOUSE
- HALL, KITCHEN WITH ELECTRIC OVEN AND HOB
- TWO BEDROOMS, BATHROOM
- ALLOCATED PARKING SPACES & REAR GARDEN
- CUL DE SAC LOCATION
- ON THE BARTONS DEVELOPMENT CLOSE TO AMENITIES
- SITTING ROOM/DINING ROOM
- ELECTRIC HEATING EPC 68, D
- COUNCIL TAX BAND B



Council Tax Band: B - EPC Rating: D 68

GROUND FLOOR

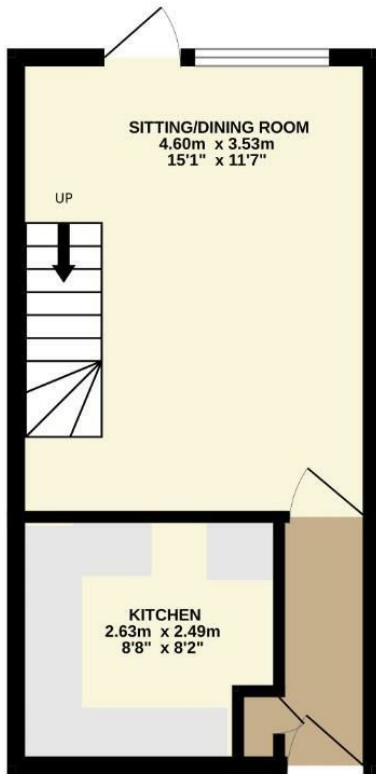

1ST FLOOR

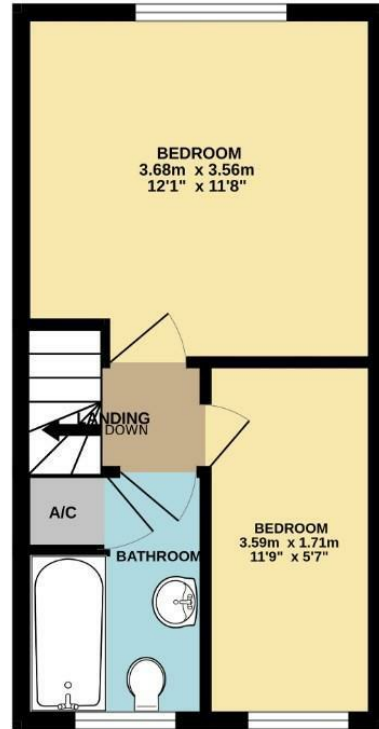

Whilst every attempt has been made to ensure the accuracy of the floorplan contained here, measurements of doors, windows, rooms and any other items are approximate and no responsibility is taken for any error, omission or mis-statement. This plan is for illustrative purposes only and should be used as such by any prospective purchaser. The services, systems and appliances shown have not been tested and no guarantee as to their operability or efficiency can be given.  
Made with Metropix 5.02.05.

