

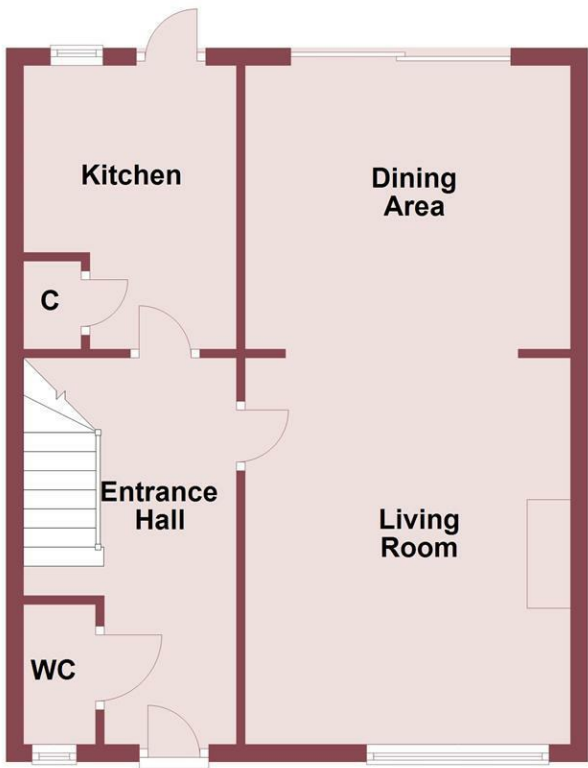

Ground Floor

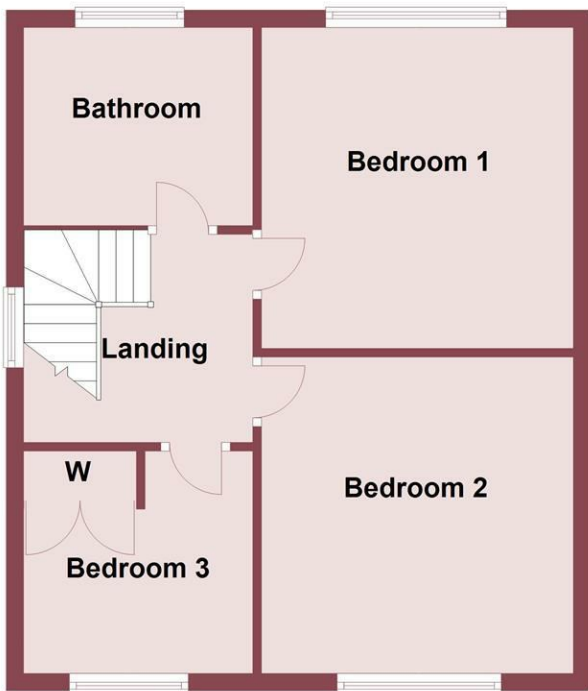

First Floor



Arden Drive, Neston, CH64 0SJ

£1,000 PCM

 3 Bedroom  2 Reception  1 Bathroom  C

****Available Now - Sought After Location - Immaculate Condition ****

Hewitt Adams are delighted to offer to the rental market this exceptionally well presented, three bedroom semi detached house in Arden Drive close to local amenities, transport links and excellent schools. The property has recently undergone improvements such as new carpets and full decoration throughout.

In brief the ground floor accommodation comprises; Entrance hallway, WC, lounge leading to dining area, kitchen. To the first floor there are three well sized bedrooms and a spacious bathroom.

Externally, the property has a driveway for off road parking, a front garden, gated access to the rear.

The rear garden is sunny and well presented with laid to lawn area, secure boundaries, patio and garage access.

Small Pets Considered, No Smokers, Available Now

Entrance Hall

13'06 x 6'00 (4.11m x 1.83m)
uPVC front door to hallway, central heating radiator, stairs to first floor, doors to;

WC

4'05 x 2'08 (1.35m x 0.81m)
WC, wash hand basin, window to front aspect.

Lounge

14'05 x 11'08 (4.39m x 3.56m)
Window to front elevation, central heating radiator, fireplace (display only), opening to dining area.

Dining Area

10'00 x 8'10 (3.05m x 2.69m)
Sliding doors to rear elevation, central heating radiator.

Kitchen

10'04 x 8'04 (3.15m x 2.54m)
Comprising a range of wall and base units with roll top work surfaces incorporating sink and drainer with mixer tap, cooker and fridge freezer, space and plumbing for washing machine, storage cupboard housing boiler, window and door to rear. The fridge / freezer will not be maintained or replaced by the landlord if it breaks.

Landing

Window to side, doors to;

(loft not to be used)

Bedroom 1

11'07 x 10'07 (3.53m x 3.23m)
Window to rear aspect, central heating radiator.

Bedroom 2

12'06 x 11'06 (3.81m x 3.51m)
Window to front aspect, central heating radiator.

Bedroom 3

10'05 x 8'09 (3.18m x 2.67m)
Window to front aspect, central heating radiator, built in wardrobe.

Bathroom

8'01 x 5'09 (2.46m x 1.75m)
A spacious bathroom comprising; WC, wash hand basin, P-shape bath with shower over, heated towel radiator, vanity unit, window to rear elevation.

Garage

Up and over door

