



TO LET

**Meath Street
Battersea
London
SW11 4JA**

£2,050 pcm

1 Bedroom Flat Unfurnished





Description

Hindwoods is delighted to present to market this beautiful and fantastically located one-bedroom ground floor flat. The property is accessed via a communal entrance that leads to two separate front doors. The bright and spacious living room provides a welcoming atmosphere for relaxation and entertainment. Large windows allow natural light to fill the space. Located within walking distance of numerous transport links.

The accommodation comprises:

Living Room

12'1" x 12'0" (3.69 x 3.67m) Casement windows. 1 large Radiator. Carpeted throughout.

Kitchen

9'9" x 9'9" (2.98 x 2.80m) Double hung sash Window. Radiator. Combi boiler. Wall and base units with inset stainless-steel sink and work top surfaces. Gas hob and cooker. Washing machine. Fridge/Freezer. Tiled back splash.

Bathroom

8'0" x 4'11" (2.43 x 1.51) Suite comprising pedestal wash basin and W.C tiled wall. Bath & plumbed in shower hose with a half enclosure. Cabinet. Mirror. Laminated flooring.

Bedroom

9'4" x 9'10" (2.84 x 3.00m). Double hung sash Window to rear. Radiator. Carpeted throughout.



Viewings

For further information
please contact:
Hindwoods 0208 858 9303

Donna Distin
d.distin@hindwoods.co.uk



Score	Energy rating	Current	Potential
92+	A		
81-91	B		
69-80	C	74 C	80 C
55-68	D		
39-54	E		
21-38	F		
1-20	G		

Energy Efficiency Rating

Very energy efficient - lower running costs

Current	Potential
---------	-----------

Meath Street

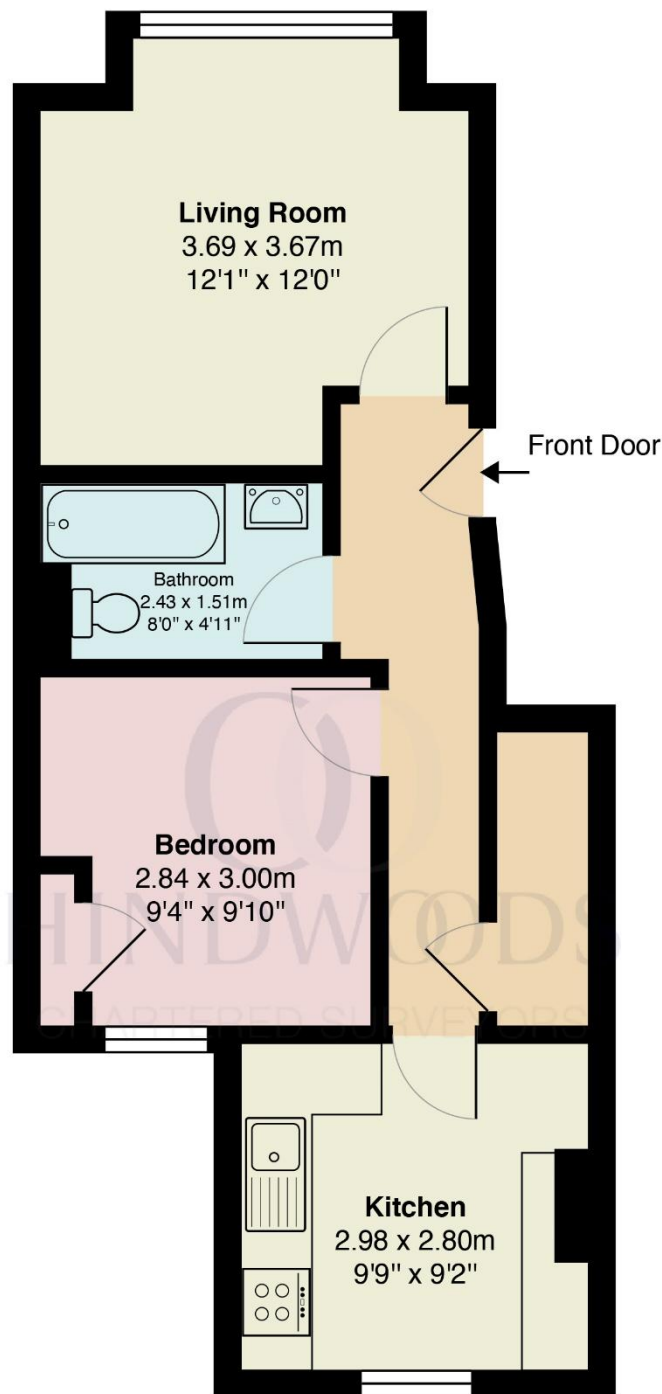

Gross Internal Area: 40.0 m² ... 431 ft²

