



8 Whitworth Avenue

Corby, Northamptonshire NN17 1DL



**Simpson West**

Simpson West Lettings are delighted to offer for rent this established three bedroom semi detached house which is located on the highly sought after Lloyds area of Corby. This property boasts many features to include lounge/diner, kitchen and a downstairs shower room. Upstairs there are three bedrooms with an en-suite to the master bedroom. Outside there is off road parking provided for two vehicles to the front and an established garden to the rear. Viewing is highly recommended. Energy Rating D. Council Tax Band A.



£1,100 PCM

3 2 1



### Ground Floor

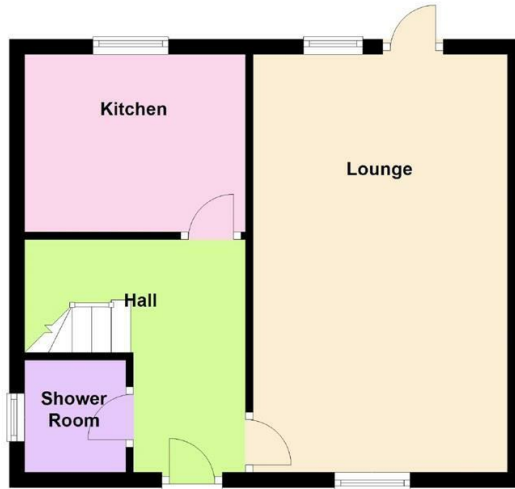

### First Floor



Floor plan not to scale - for guidance purposes only.  
Plan produced using PlanUp.



### Energy Efficiency Rating

	Current	Potential
<i>Very energy efficient - lower running costs</i>		
(92 plus) <b>A</b>		
(81-91) <b>B</b>		88
(69-80) <b>C</b>		
(55-68) <b>D</b>	64	
(39-54) <b>E</b>		
(21-38) <b>F</b>		
(1-20) <b>G</b>		
<i>Not energy efficient - higher running costs</i>		
<b>England &amp; Wales</b>	EU Directive 2002/91/EC 	



When you buy with Simpson West, you know **you'll be in safe hands**. From the moment you walk through our doors, we'll make you **feel truly welcome**. Our sales consultants and financial advisors will take you through **every step of the process**, offering **free expert advice** along the way, from help choosing the right mortgage and insurance through to finding your conveyancer. And if you need help selling your home too, **with over 20 years of local experience, you can trust us to get you moving**.



**Simpson  
West**

Making Every  
Journey Personal



01536 202007

[info@simpsonwest.co.uk](mailto:info@simpsonwest.co.uk)

<https://www.simpsonwest.co.uk/>

64 Corporation Street, Corby, Northants, NN17 1NH