



**Connells**

Shackleton Gardens  
Flitwick Bedford



# Shackleton Gardens Flitwick Bedford MK45 1GR

for sale  
**£375,000**



## Property Description

Connells present this modern semi-detached home which is situated just a short walk from local amenities and transport links. As you step inside you'll find an open plan living/dining room with french doors leading to the enclosed rear garden, a well kept kitchen with a range of integrated appliances and a cloakroom perfect for guests, completes the ground floor. Upstairs, you will find three well sized bedrooms, with the principal bedroom having the convenience of en-suite shower room and finally a family bathroom suited to the other bedrooms. Outside you find a low-maintenance garden with artificial lawn and a summerhouse and to the front you have the ease of off road parking.

## Entrance/ Hallway

Door to front, radiator.

## Cloakroom

Double glazed window, low level wc, hand wash basin, radiator.

## Living Room

16' 9" x 15' 5" ( 5.11m x 4.70m )

Double glazed window, french doors to rear garden, built in storage cupboard, radiators

## Kitchen

9' 5" x 7' 11" ( 2.87m x 2.41m )

Double glazed window, fitted wall to base units, ceramic sink/ drainer, integrated gas

hob, extractor, dishwasher, oven.

## First Floor

## Landing

Loft hatch, access to all bedrooms and bathroom

## Principal Bedroom

12' 9" x 10' 2" ( 3.89m x 3.10m )

Double glazed window, built in wardrobe, radiator.

## En-Suite

Double glazed window, low level wc, hand wash basin, shower, radiator.

## Bedroom 2

10' 3" x 8' 9" ( 3.12m x 2.67m )

Double glazed window, radiator.

## Bedroom 3

10' 3" x 6' 5" ( 3.12m x 1.96m )

Double glazed window, radiator.

## Bathroom

Double glazed window, bath with overhead shower, hand wash basin, low level wc, heated towel rail.

## Front Garden

Paved pathway to front door

## Rear Garden

Patio area with pergola, artificial grass laid, side gate access, summerhouse with power.











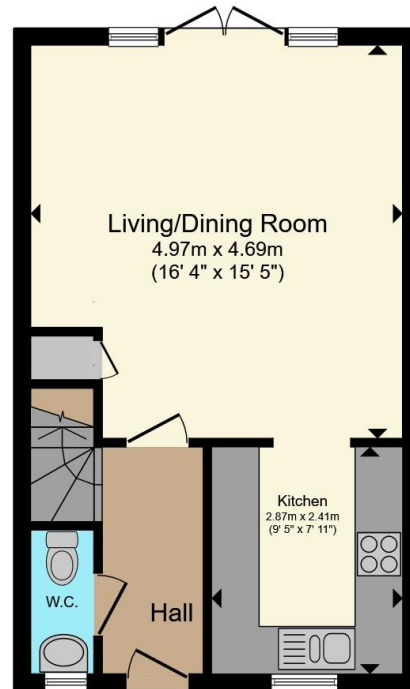

**Ground Floor**

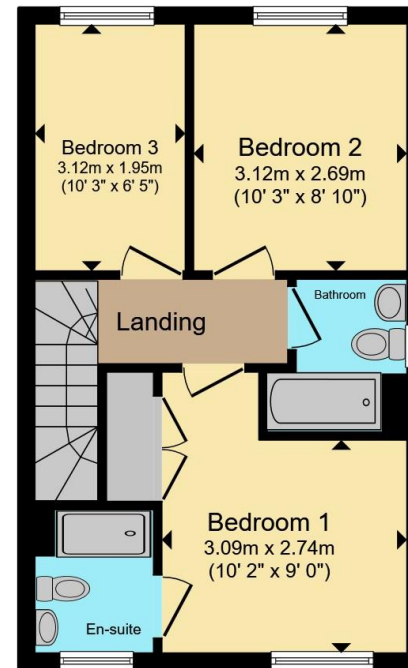

**First Floor**

Total floor area 74.5 m<sup>2</sup> (802 sq.ft.) approx

This floor plan is for illustrative purposes only. It is not drawn to scale. Any measurements, floor areas (including any total floor area), openings and orientation are approximate. No details are guaranteed, they cannot be relied upon for any purpose and they do not form part of any agreement. No liability is taken for any error, omission or misstatement. A party must rely upon its own inspection(s). Powered by [www.propertybox.io](http://www.propertybox.io)

**Connells**

To view this property please contact Connells on

**T 01525 712 271**  
**E [flitwick@connells.co.uk](mailto:flitwick@connells.co.uk)**

Unit 9 Russell Centre Coniston Road Flitwick  
BEDFORD MK45 1QY

EPC Rating: Council Tax  
Awaited Band: C

Tenure: Freehold

**view this property online [connells.co.uk/Property/FLI305711](http://connells.co.uk/Property/FLI305711)**



1. MONEY LAUNDERING REGULATIONS Intending purchasers will be asked to produce identification documentation at a later stage and we would ask for your co-operation in order that there will be no delay in agreeing the sale. 2. These particulars do not constitute part or all of an offer or contract. 3. The measurements indicated are supplied for guidance only and as such must be considered incorrect. Potential buyers are advised to recheck measurements before committing to any expense. 4. We have not tested any apparatus, equipment, fixtures, fittings or services and it is in the buyers interest to check the working condition of any appliances.

Connells Residential is registered in England and Wales under company number 1489613, Registered Office is Cumbria House, 16-20 Hockliffe Street, Leighton Buzzard, Bedfordshire, LU7 1GN. VAT Registration Number is 500 2481 05.

**See all our properties at [www.connells.co.uk](http://www.connells.co.uk) | [www.rightmove.co.uk](http://www.rightmove.co.uk) | [www.zoopla.co.uk](http://www.zoopla.co.uk)**

Property Ref: FLI305711 - 0003