



REGENT
ESTATES

HIGH STREET, BERKHAMSTED

£315,000 Leasehold

ACCOMMODATION

Superb Two-Bedroom Private Top Floor Apartment – Turner Court

Located within easy walking distance of the town centre and train station, via the High Street, Bridgewater Road, or the picturesque canal towpath, this stylish top-floor apartment offers the perfect blend of convenience and modern living in the highly sought-after Turner Court development.

Situated within a contemporary block, the property boasts:

Spacious Open-Plan Living

A bright and airy dual-aspect kitchen, living, and dining area, featuring French doors that open to a Juliet balcony—perfect for enjoying fresh air and natural light.

Two Well-Proportioned Bedrooms

Both bedrooms are tastefully decorated, with the principal bedroom benefiting from a modern en suite shower room.

Contemporary Bathroom

A sleek, modern bathroom fitted with quality fixtures and finishes.

Welcoming L-Shaped Hallway

Enhancing the sense of space and providing a smooth flow throughout the apartment.

Additional Benefits Include:

- Access to loft space
- Newly redecorated and new carpets.
- 2 Allocated parking spaces
- Visitor parking bays
- Sought-after residential development
- Excellent transport links

This property is ideal for first-time buyers, professionals, or investors seeking a well-located and stylish home.

IMPORTANT NOTICE

1. These sales particulars have been prepared from information supplied by the vendors and information collated by Regent Estates.
2. Confirmation has been sought from the vendors to confirm these particulars accuracy.
3. All measurements given have a tolerance of 3" in accordance with RICS Code of Measuring Practice.
4. None of these appliances, plumbing or electrics mentioned within these particulars have been tested by ourselves, prospective purchasers are urged to check their condition before entering in to purchase.

VIEWING

Strictly by appointment through Regent Estates.

01442 877878

141-143 High Street, Berkhamsted, Herts,
HP4 3HH

Email: info@regent-estates.com
www.regent-estates.com







Third Floor

Approx. 62.5 sq. metres (672.8 sq. feet)

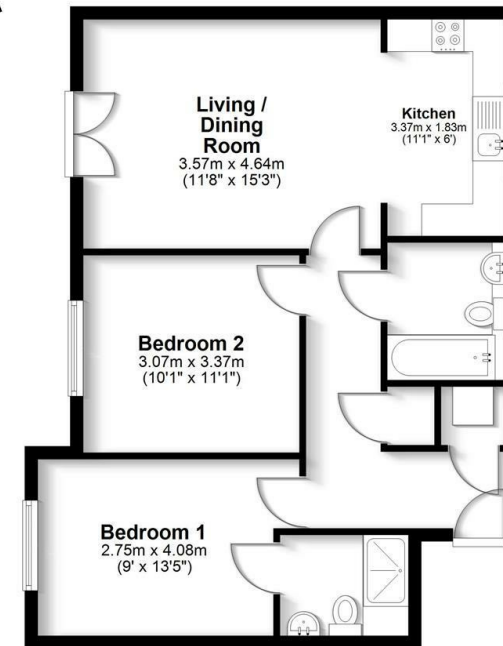

Total area: approx. 62.5 sq. metres (672.8 sq. feet)

FOR ILLUSTRATIVE PURPOSES ONLY - NOT TO SCALE
 The position and size of doors, windows, appliances and other features are approximate only. Total area includes garages and outbuildings - Unauthorised reproduction prohibited.
 Plan produced using PlanUp.

**REGENT
ESTATES**

TELEPHONE: 01442 877878
 141-143 High Street, Berkhamsted,
 Herts, HP4 3HH
 Email: info@regent-estates.com
www.regent-estates.com