



**JR**  
JOSHUA REED



**JR**  
JOSHUA REED



**JR**  
JOSHUA REED



**JR**  
JOSHUA REED

**4 Bed House - Semi-Detached  
located in Anstey**

**JR**  
JOSHUA REED  
Estate Agents

2 New Barns Cottage  
Anstey  
Buntingford  
SG9 0DN

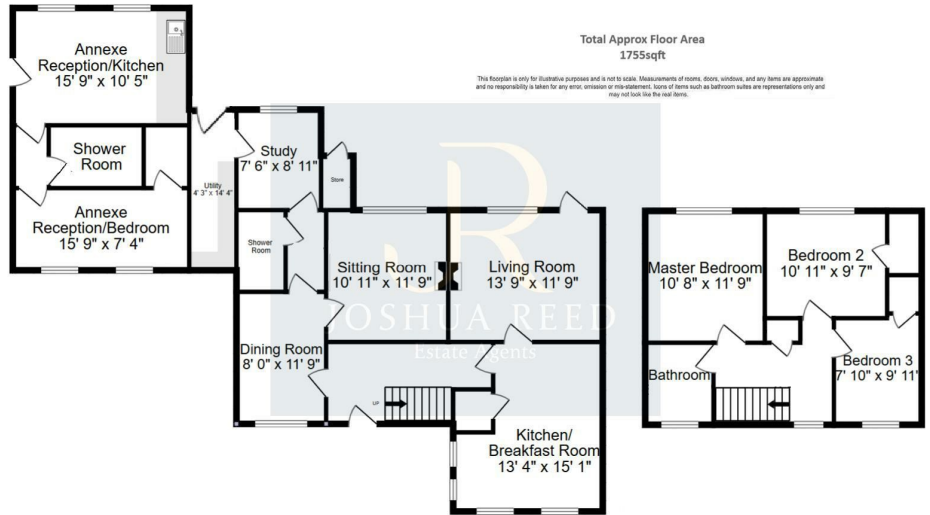

£735,000

CONTACT

23-27 Maidenhead Street  
Hertford  
Hertfordshire  
SG14 1DW

EMAIL

josh@joshua-reed.co.uk

TELEPHONE

01992 917388

www.joshua-reed.co.uk

SUMMARY

A charming and beautifully extended three/four bedroom semi-detached cottage with the added benefit of a self-contained annexe. Ideal for separate living accommodation, guest suite or running a home business. Set in this picturesque rural setting with a stunning garden and truly breath-taking views across open countryside.

This property provides versatile accommodation featuring three reception rooms, modern/kitchen breakfast, office, utility room and shower room to the ground floor. Upstairs you're presented with three good size bedrooms and a luxury family bathroom.

The extended portion of the property provides a self contained one bedroom annexe with a modern shower room that lends itself perfectly for a home gym, rental opportunity or running a home business.

The garden needs no introduction with multiple areas for outdoor dining, entertaining, hot tub space, storage sheds, Koi pond, mature planting and trees. A truly stunning and tranquil place that must be viewed. Furthermore there is ample off-street parking for numerous

DIRECTIONS

