

Addison Place, W11

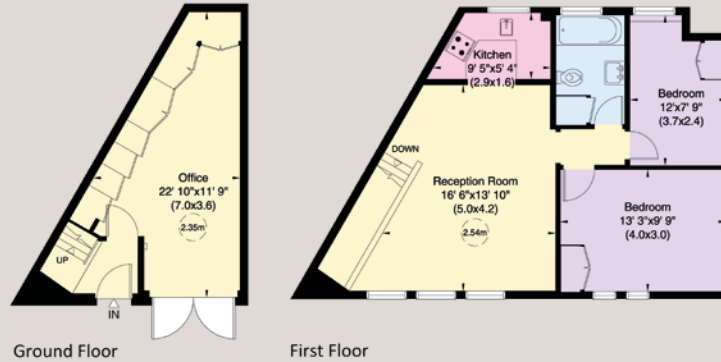



Approx. Gross Internal Area
833 sq ft (77 sq m)



Addison Place, W11

A freehold building consisting of two bedrooms, reception, kitchen and bathroom on the first floor with a garage on the ground floor, currently converted into office space.

Addison Place is a quiet and part-cobbled mews just off Addison Avenue and is conveniently positioned for the many and varied specialist shops and excellent transport facilities on Holland Park Avenue, the Underground Station (Central Line) giving direct access to the City and West End. The Westfield shopping complex is also close by with a direct Overground link to Clapham Junction.

Terms

Tenure Freehold

EPC Rating C

Local Authority The Royal Borough of Kensington and Chelsea

Price £1,250,000 Subject to Contract

For clarification purposes we wish to inform all interested parties that we have prepared these particulars as a general guide. We have not carried out a detailed survey nor tested the services, appliances and specific fittings. Room sizes should not be relied upon for carpets and furnishings.

JOHN WILCOX
& Co.

020 7602 2352

www.johnwilcox.co.uk