

# FLETCHERS

ESTATE AGENTS



## Beaumont Road, W4

£550,000

This recently renovated two bedroom Victorian garden flat has a bright reception space leading onto a modern kitchen with direct access to a landscaped private West facing garden. There is further potential to extend subject to consents and a share of freehold.

Located in one of Chiswick's most sought after areas and is approximately half a mile from Chiswick Park tube station and Chiswick High Road, with plenty of shops, cafés and restaurants to choose from.

- Two Bedrooms • Modern Interior • Separate Kitchen • West Facing Garden • Share of Freehold • No Onward Chain •

# FLETCHERS

ESTATE AGENTS

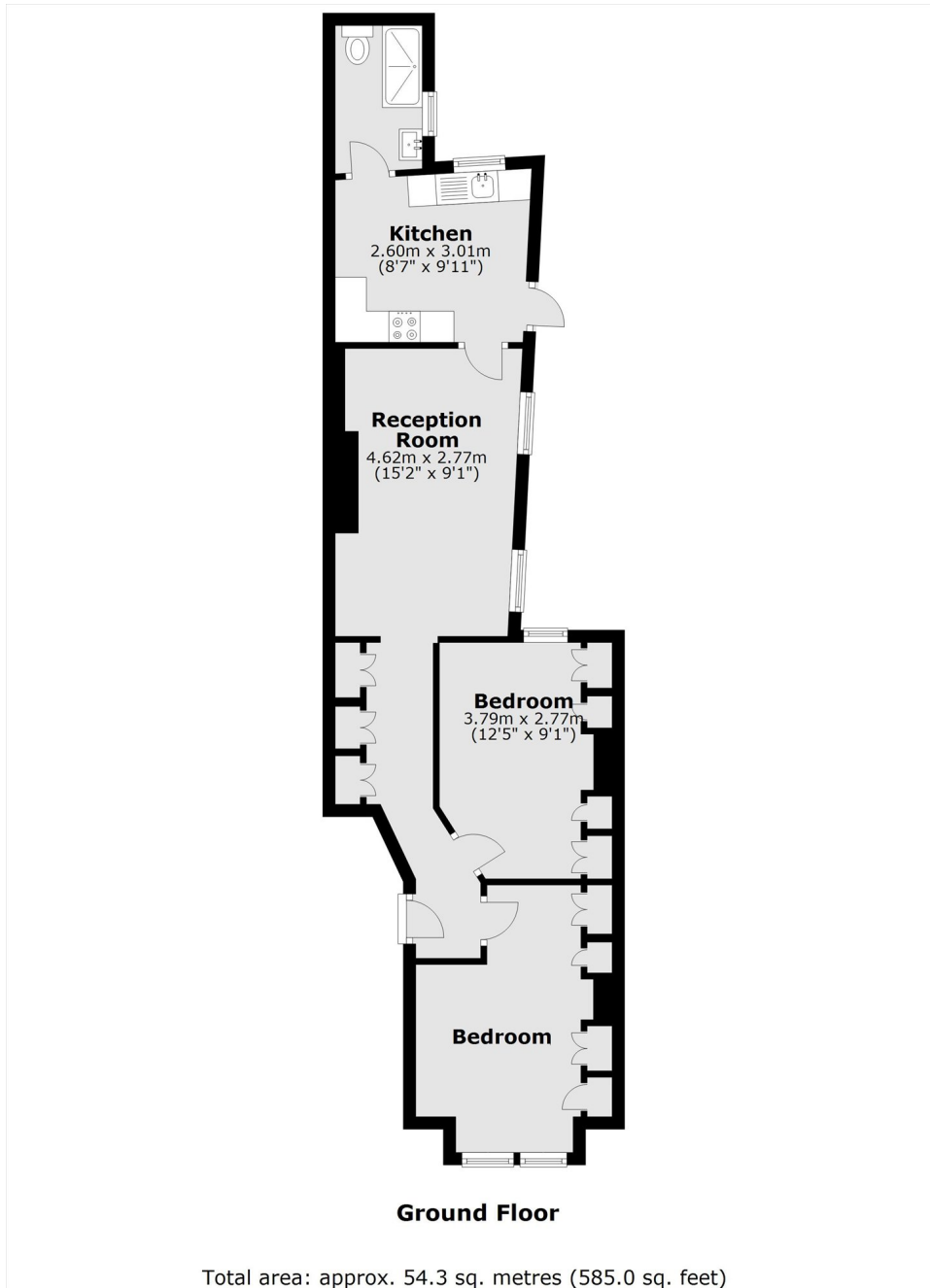

Fletchers Chiswick Turnham Green Sales  
58 Turnham Green Terrace, London, W4 1QP  
020 8987 3000  
chiswicksales@fletcherestates.com

Energy Rating: D. We aim to make our particulars both accurate and reliable. However they are not guaranteed; nor do they form part of an offer or contract. If you require clarification on any points then please contact us, especially if you're traveling some distance to view. Please note that appliances and heating systems have not been tested and therefore no warranties can be given as to their good working order.