



110 Vincent Road, Sharrow, Sheffield, S7 1BX



# 110 Vincent Road

## Sharrow

Guide Price

# £230,000

GUIDE PRICE £230,000 to £240,000

Situated in the highly sought-after area of Sharrow, this beautifully presented three-bedroom terrace property offers spacious and versatile accommodation arranged over four levels, perfectly suited to first-time buyers, professionals and growing families alike.

Ideally located within easy reach of excellent local amenities, well-regarded schools and superb transport links, the property is just a short stroll from the ever-popular Abbeydale Road, renowned for its vibrant mix of independent cafés, award-winning restaurants, trendy bars and local eateries, creating one of Sheffield's most desirable neighbourhoods.

The accommodation comprises a welcoming lounge to the front of the property, featuring a charming bay window, leading through to a generous dining room, ideal for entertaining family and friends. To the rear is a well-appointed fitted kitchen with access to the delightful rear courtyard garden, providing the perfect space for outdoor dining, relaxing and low-maintenance living.

To the first floor are two well-proportioned double bedrooms, a contemporary family bathroom and useful storage cupboard. The second floor is dedicated to an impressive principal bedroom, offering excellent floor space and the added luxury of a modern en-suite bathroom.

Further enhancing the home is a useful cellar, providing excellent storage or potential for further use, subject to the necessary consents.

Externally, the property benefits from a delightful enclosed rear courtyard garden, creating a private outdoor retreat ideal for enjoying the warmer months.

Offering generous living accommodation, character, and an enviable location within one of Sheffield's most popular suburbs, this fantastic home presents an excellent opportunity for a wide range of purchasers. Early viewing is highly recommended to fully appreciate everything this wonderful property has to offer.



- Beautifully presented three-bedroom terrace property arranged over four spacious levels.
- Ensuite to the attic bedroom
- Ideal for first time buyer, young family or investment
- Attractive enclosed southerly facing garden
- Separate lounge and dining room and off-shot kitchen
- Walking distance of excellent amenities
- Viewings Via Banner Cross Branch
- No onward chain



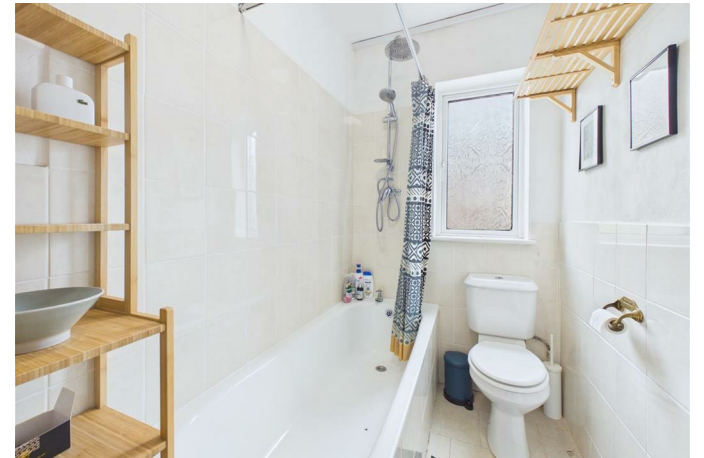

# 110 Vincent Road

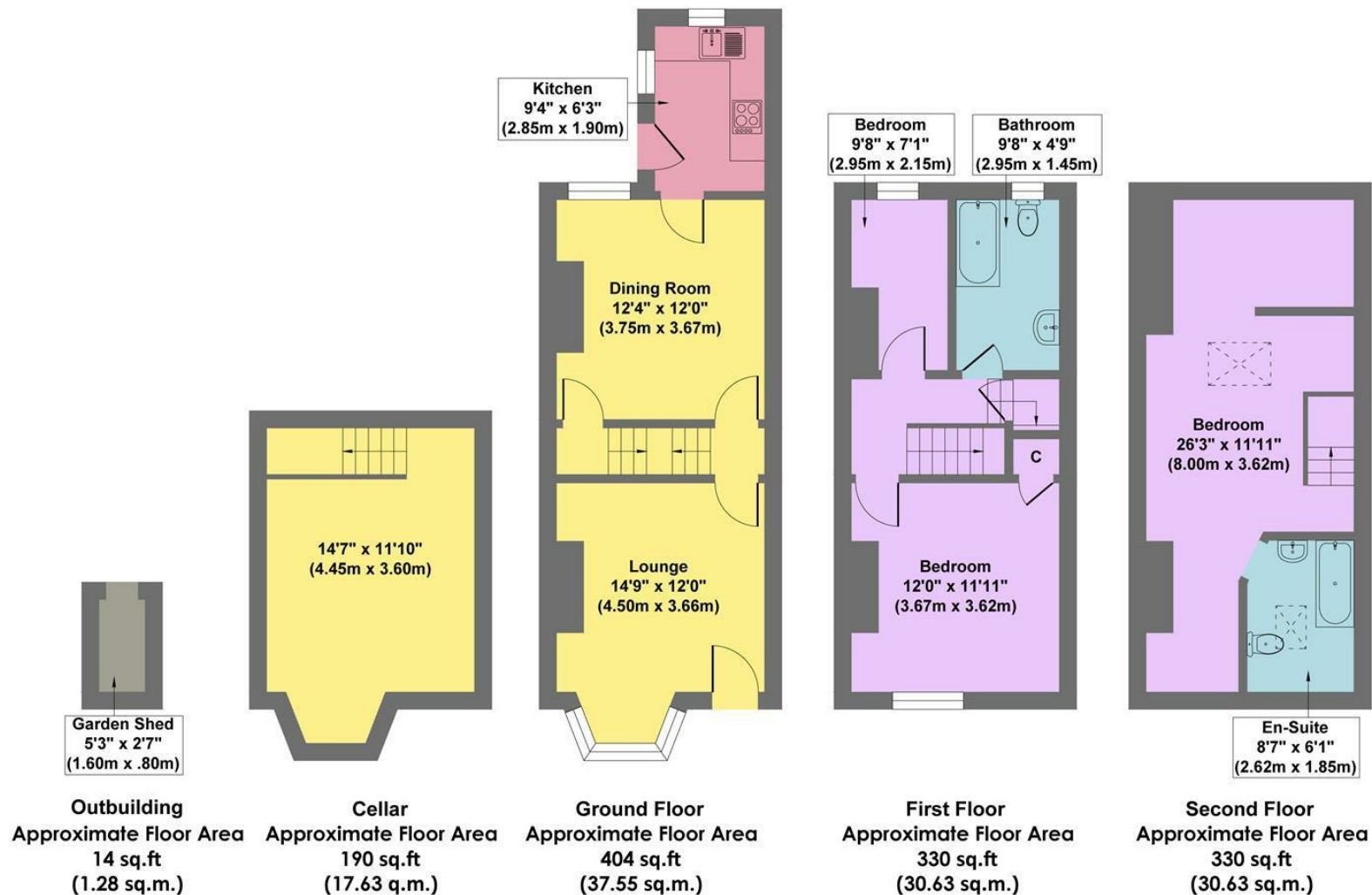

**Approx. Gross Internal Floor Area 1268 sq.ft / 117.72 sq.m**

Illustration for identification puposes only ,measurements are approximate, not to scale

While we endeavour to make our sales particulars fair, accurate and reliable, they are only a general guide to the property and, accordingly, if there is any point, which is of particular importance to you, please contact the relevant office. The Agents have not tested any apparatus, equipment, fittings or services and so cannot verify they are in working order. The buyer is advised to obtain verification. Please note all the measurement details are approximate and should not be relied upon as exact. All plans, floor plans and maps are for guidance purposes only and are not to scale. Under no circumstances should they be relied upon as exact or for use in planning carpets and other such fixtures, fittings or furnishings. YOUR HOME IS AT RISK IF YOU DO NOT KEEP UP REPAYMENTS ON A MORTGAGE OR OTHER LOAN SECURED ON IT. 'A Life Assurance policy may be requested.' 'Written Quotations of credit terms available on request.'

Banner Cross  
T: 0114 268 3241  
E: [bannercross@saxtonmee.co.uk](mailto:bannercross@saxtonmee.co.uk)  
[www.saxtonmee.co.uk](http://www.saxtonmee.co.uk)

Hathersage  
T: 01433 650009  
E: [hathersage@saxtonmee.co.uk](mailto:hathersage@saxtonmee.co.uk)

Bakewell  
T: 01629 815307  
E: [bakewell@saxtonmee.co.uk](mailto:bakewell@saxtonmee.co.uk)

Matlock  
T: 01629 828250  
E: [matlock@saxtonmee.co.uk](mailto:matlock@saxtonmee.co.uk)

