



Connells

Skyline Plaza
Alencon Link Basingstoke



Property Description

This studio apartment is situated in the heart of Basingstoke, the property is located in the town centre and is just minutes walk from the Malls and Festival Place shopping centre, offering a wide variety of shops, leisure and entertainment facilities, bars, restaurants and cafes. Also based within the town centre is the mainline train station to London Waterloo and the Basingstoke bus station which provides regular services across Basingstoke and surrounding areas, making it a great location for those who commute. For those who drive, there is easy access via car to the M3, A339 and the A33.

The property is also conveniently situated next to Waitrose and is a short walk to a number of supermarkets such as Sainsburys, Tesco, convenience stores and other amenities located in the town centre.



Open Plan Living Space

Kitchen Area: Work surfaces with cupboards and drawers under and cupboards over, fitted four ring electric hob, electric oven under, extractor fan, stainless steel sink with drain and mixer tap

Living/Bedroom Area: Storage cupboard, double glazed window

Shower Room

Shower cubical, low level WC, hand wash basin, heated towel rail, extractor fan







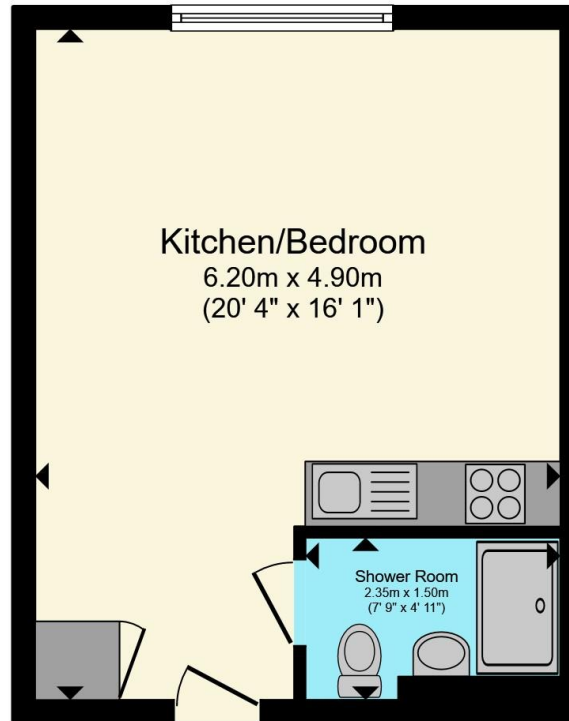

Total floor area 30.0 m² (323 sq.ft.) approx

This floor plan is for illustrative purposes only. It is not drawn to scale. Any measurements, floor areas (including any total floor area), openings and orientation are approximate. No details are guaranteed, they cannot be relied upon for any purpose and they do not form part of any agreement. No liability is taken for any error, omission or misstatement. A party must rely upon its own inspection(s). Powered by www.propertybox.io



To view this property please contact Connells on

T 01256 464566
E basingstoke@connells.co.uk

1 Wote Street
BASINGSTOKE RG21 7NE

EPC Rating: C Council Tax
Band: A

Service Charge:
1600.00

Ground Rent:
125.00

Tenure: Leasehold

view this property online connells.co.uk/Property/BTK314629

This is a Leasehold property with details as follows; Term of Lease 125 years from 22 Mar 2006. Should you require further information please contact the branch. Please Note additional fees could be incurred for items such as

1. MONEY LAUNDERING REGULATIONS Intending purchasers will be asked to produce identification documentation at a later stage and we would ask for your co-operation in order that there will be no delay in agreeing the sale. 2. These particulars do not constitute part or all of an offer or contract. 3. The measurements indicated are supplied for guidance only and as such must be considered incorrect. Potential buyers are advised to recheck measurements before committing to any expense. 4. We have not tested any apparatus, equipment, fixtures, fittings or services and it is in the buyers interest to check the working condition of any appliances.

Connells Residential is registered in England and Wales under company number 1489613, Registered Office is Cumbria House, 16-20 Hockliffe Street, Leighton Buzzard, Bedfordshire, LU7 1GN. VAT Registration Number is 500 2481 05.



See all our properties at www.connells.co.uk | www.rightmove.co.uk | www.zoopla.co.uk

Property Ref: BTK314629 - 0014