

DISTINCTIVE  
HOMES  
by



# Thorncliffe Road

Mapperley Park Conservation Area, NG3 5BQ.

# Thorncliffe Road

Mapperley Park Conservation Area, NG3 5BQ

A spacious and characterful semi-detached family home, ideally situated within the highly sought-after Mapperley Park Conservation Area. This impressive property combines generous proportions with a wealth of original features, offering a perfect blend of period charm and modern living.





Upon entering, you are welcomed by a large and inviting entrance hallway, complete with stylish tiled flooring, which sets the tone for the rest of the home. The elegant living room features a beautiful bay window that floods the space with natural light, alongside a striking feature fireplace and attractive wooden flooring. A separate dining room provides an ideal setting for entertaining, also benefiting from its own feature fireplace and a warm, traditional feel.

To the rear of the property is a well-appointed, modern breakfast kitchen, fitted with integrated appliances, ample storage solutions, and contemporary coloured splashbacks. The kitchen also has wet underfloor heating and provides access to a cellar, a versatile space that benefits from some natural light and offers excellent potential for storage or further use subject to any planning or building regulations approval.





The first floor hosts two generously sized double bedrooms, including a superb master bedroom with access to a private balcony. Both rooms offer excellent space and natural light. This level is further enhanced by a beautifully presented and spacious family bathroom, finished to a high standard.

The second floor comprises two additional double bedrooms, both well-proportioned and ideal for family living or home office use, along with a convenient shared shower room.

Externally, the property offers on-street parking, while to the rear there is a low-maintenance garden, perfect for relaxing or entertaining outdoors.

Well presented throughout, this wonderful home retains many original features and presents a fantastic opportunity for families seeking space, character, and a prime residential location.





**Basement**  
Approx. 27.1 sq. metres (291.2 sq. feet)

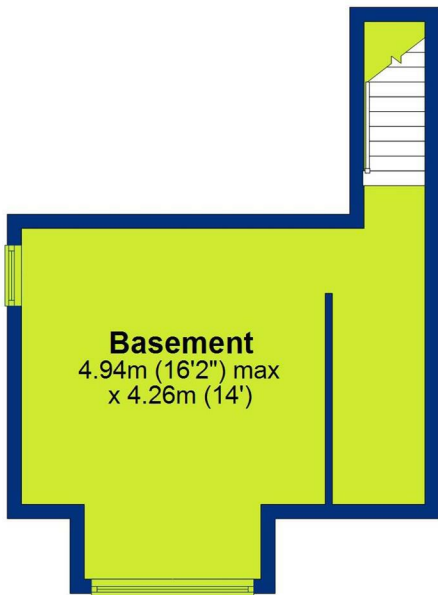

**Ground Floor**  
Approx. 80.3 sq. metres (864.7 sq. feet)

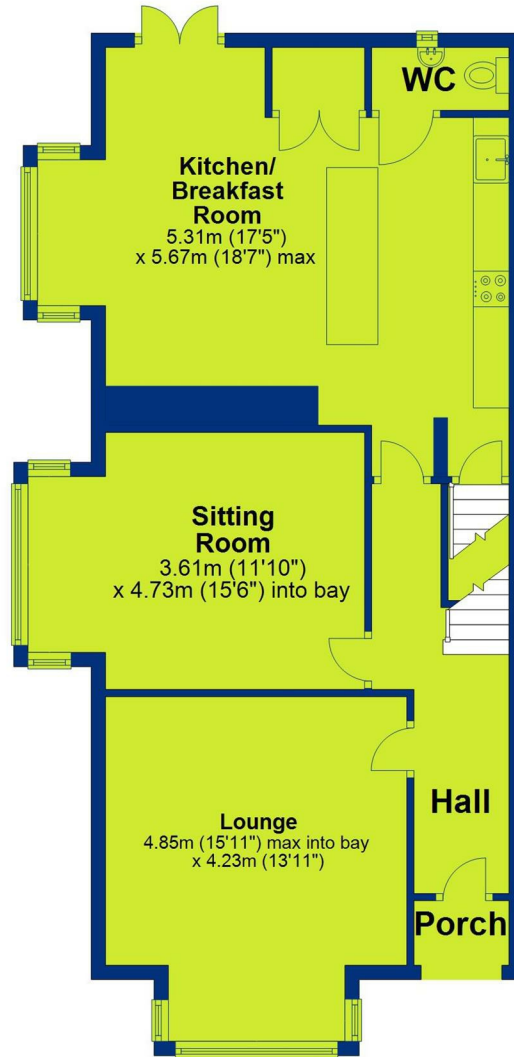

**First Floor**  
Approx. 57.8 sq. metres (622.3 sq. feet)  
(excluding Balcony)

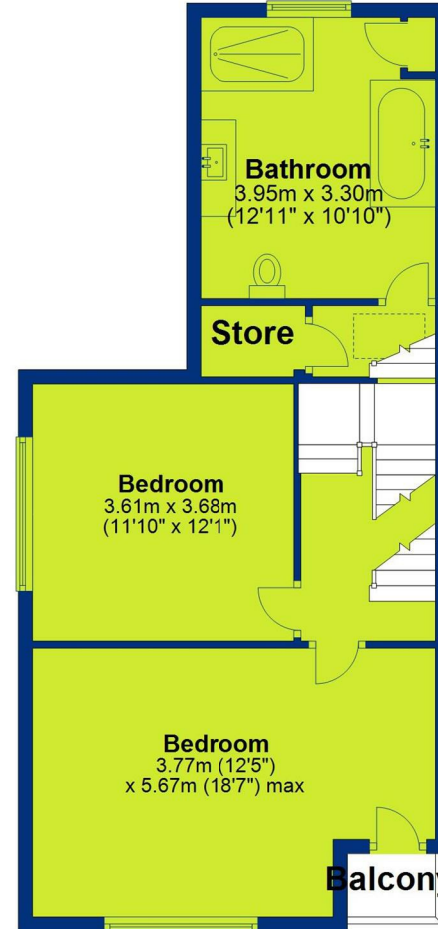

**Second Floor**  
Approx. 36.7 sq. metres (395.4 sq. feet)

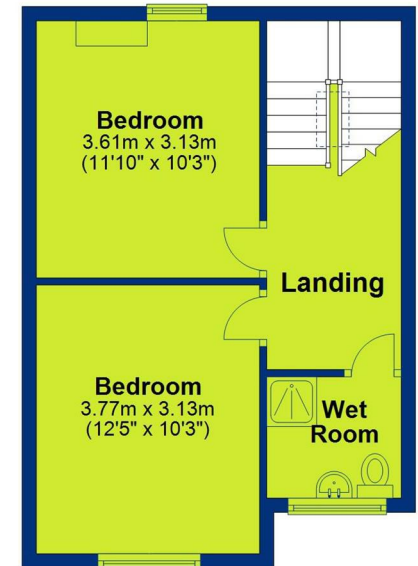

Total area: approx. 201.9 sq. metres (2173.6 sq. feet)



DISTINCTIVE  
HOMES  
by



## Distinctive Homes by FHP Living

A collection of some of the best properties available in the most sought-after areas of Nottingham, and its surrounding suburbs and villages.

[www.fhpliving.co.uk](http://www.fhpliving.co.uk)



Energy Efficiency Rating		Current	Potential
Very energy efficient - lower running costs			
(92 plus) A			
(81-91) B			90
(69-80) C			
(55-68) D		55	
(39-54) E			
(21-38) F			
(1-20) G			
Not energy efficient - higher running costs			
England & Wales		EU Directive 2002/91/EC	

FHP, their clients and joint agents give notice that:

1. They are not authorised to make or give any representations or warranties in relation to the property either here or elsewhere, either on their own behalf or their client or otherwise. They assume no responsibility for any statement that may be made in these particulars. These particulars do not form part of any offer or contract and must not be relied upon as statements or representations of fact.
2. Any areas, measurements or distances are approximate. The text, photographs and plans are for guidance only and are not necessarily comprehensive. It should not be assumed that the property has all necessary planning, building regulation or other consents and FHP have not tested any service, equipment or facilities. Purchasers must satisfy themselves by inspection or otherwise. Figures quoted in these particulars may be subject to VAT in addition. 09/11

## Interested in this home?

Call the FHP Living Distinctive Homes Team



**Jason Cook**  
Mobile: 07876 396 010  
[jason@fhpliving.co.uk](mailto:jason@fhpliving.co.uk)

Tel: 0115 841 1155

23 Bridgford Road  
West Bridgford  
Nottingham NG2 6AU

1 Weekday Cross  
The Lace Market  
Nottingham NG1 2GB