

# URBAN lettings



## Angell Road, London, SW9 7HL

£2,100 Per Month

- Finished to High Standard Throughout
- Secure Gated Parking
- Separate Living Room
- Excellent Transport Links
- Second (Top) Floor Flat
- Bike Shed & Walled Gardens
- Approx. 650 sq ft
- Private Development
- Modern Bathroom & Kitchen
- Wood Floors & Double Glazing

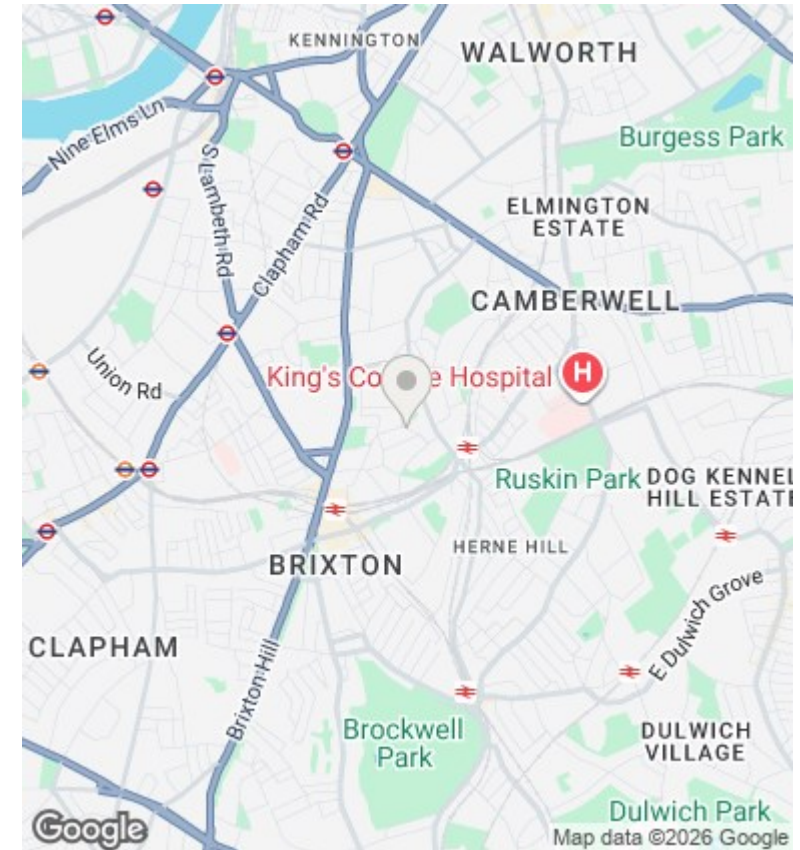
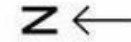
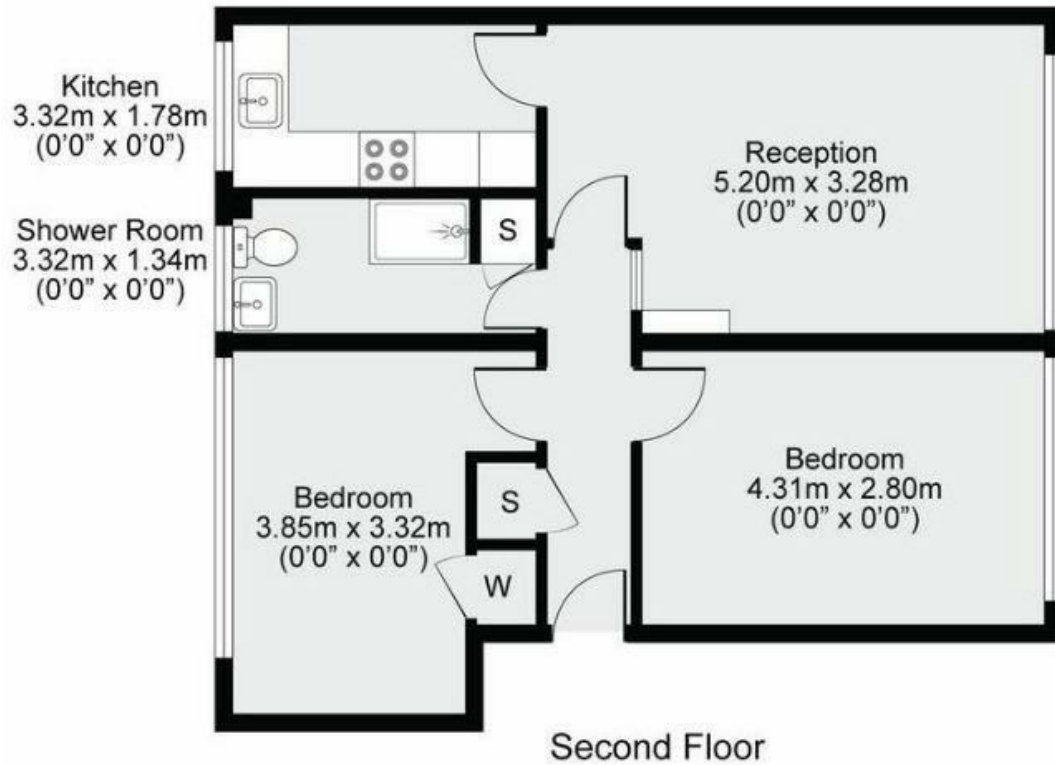

## Directions

## Viewings

Viewings by arrangement only. Call 020 7585 2761 to make an appointment.

## Council Tax Band

B

## EPC Rating:

D

Energy Efficiency Rating		Current	Potential
<i>Very energy efficient - lower running costs</i>			
(92 plus) <b>A</b>			
(81-91) <b>B</b>			
(69-80) <b>C</b>			<b>78</b>
(55-68) <b>D</b>		<b>67</b>	
(39-54) <b>E</b>			
(21-38) <b>F</b>			
(1-20) <b>G</b>			
<i>Not energy efficient - higher running costs</i>			
<b>England &amp; Wales</b>		EU Directive 2002/91/EC	