



WESTON HOUSE, NORFOLK ROAD

BIRMINGHAM, B15 3QD

£3,700.00
PCM

Davidson Luxe | Prime Edgbaston Location | Ex-Show Home | Extremely High-End Throughout | 2 Allocated Parking Spaces | Furnished | Quiet Residential Setting | Open-Plan Living & Entertaining Area | Large Patio Area | Immaculate Communal Areas | Secure Entry with Home Alarm & CCTV | 2x En-Suite Principal Rooms | Thoughtfully Designed Layout

Davidson

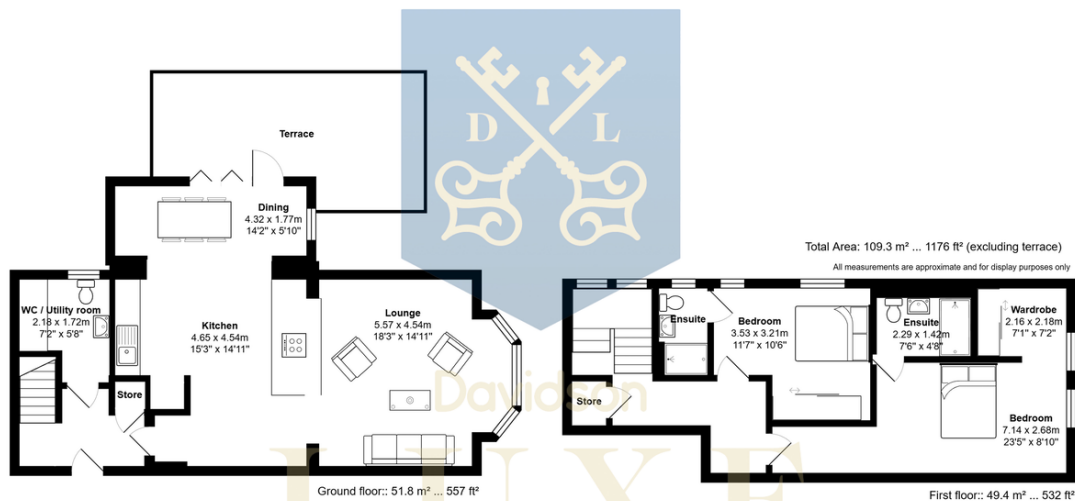

Floorplan measurements are for illustrative purpose only. Floor plan by www.sebastiano.co.uk.

Score	Energy rating	Current	Potential
92+	A		
81-91	B		
69-80	C	75 C	75 C
55-68	D		
39-54	E		
21-38	F		

Davidson

OFFICE
 22 Harborne Road
 Birmingham
 West Midlands
 B15 3AA

0121 455 7727
 info@davidsonstates.co.uk
 www.davidsonstates.co.uk

Agents Note: Whilst every care has been taken to prepare these particulars, they are for guidance purposes only. All measurements are approximate and are for general guidance purposes only and whilst every care has been taken to ensure their accuracy, they should not be relied upon and potential buyers/tenants are advised to recheck the measurements