



Gatliff Road, SW1W

£576 Per week

A bright one double bedroom apartment on the tenth floor with great views across London. The property is in a secure development with 24-hour porter service and is on the borders of Chelsea and Pimlico. The flat has a bright reception room, open plan modern kitchen, good size double bedroom with storage and bathroom with shower over bath.

Grosvenor Waterside is a secure luxury riverside development near Sloane Square and Pimlico, the shopping and restaurant options on the Kings Road are within walking distance. You are also opposite Battersea Park.

Features

- Modern Development
- Residential Gym and Pool
- 24-Hour Porter
- Ample Storage
- 10th Floor Via Lift
- Large Bedroom

Gatliff Road, London, SW1W

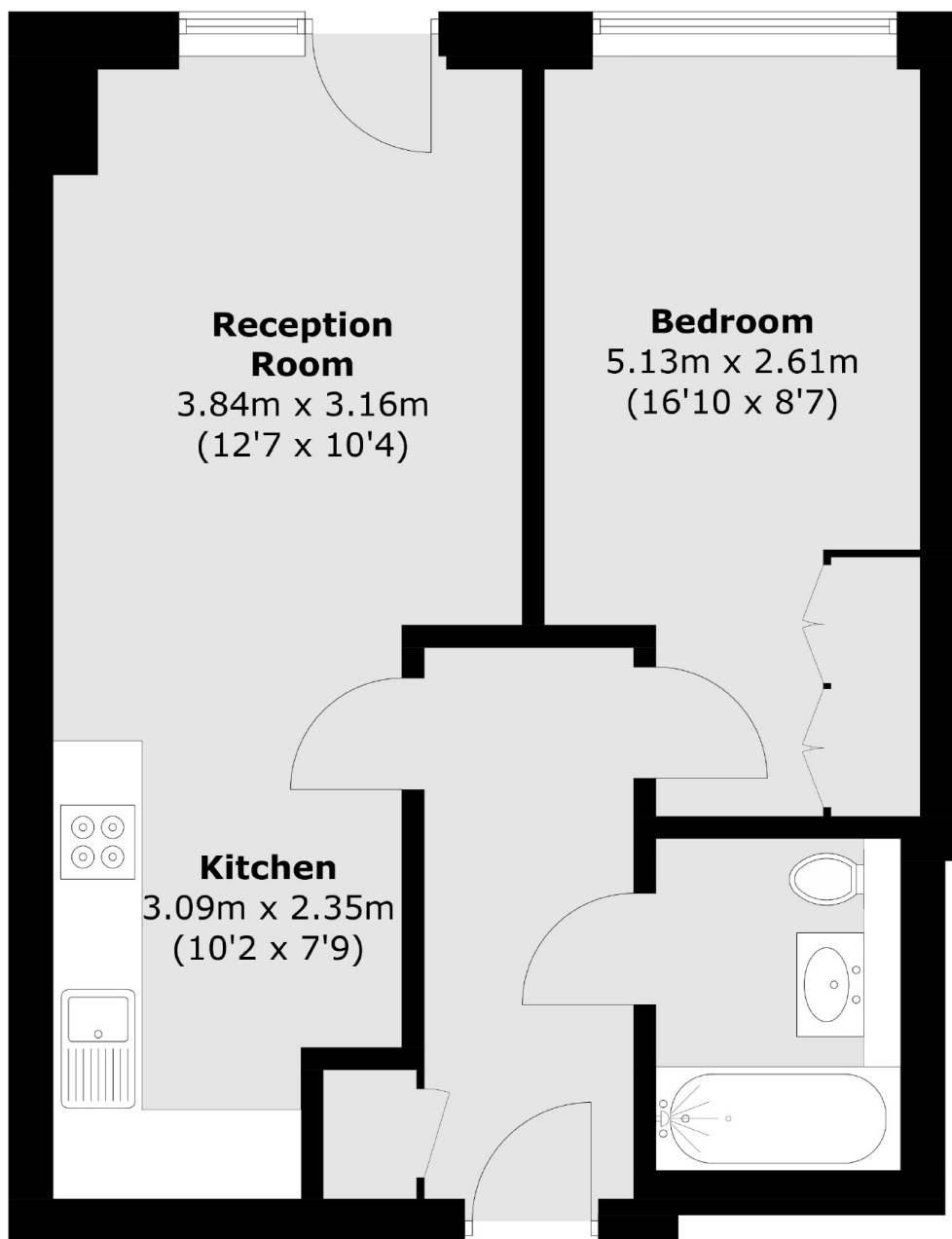

Total area (approx.): 44.4 sq. m (477.9 sq. ft)