



Charter Avenue, Market Deeping, Peterborough  
**£325,000 Freehold**

**Sharman  
Quinney**



# Key Features



- Detached House
- No Chain
- Kitchen Dining Room
- Four Bedrooms
- En Suite

Offered for sale with no chain this four bedroom three storey detached home is located in a popular area of Market Deeping and offers lounge and kitchen dining room to the ground floor. Upstairs there are four bedrooms with master ensuite over two floors. Outside the rear garden is enclosed with driveway leading to a detached single garage.

Accommodation Includes  
Front door to

Entrance Hall  
Radiator, stairs to first floor and landing

Cloakroom  
Fitted with a two piece suite comprising wash hand basin, wc, radiator



### Lounge

5.31m x 3.16m window to front, two radiators, French doors to side, electric fire with feature fire place surround

### Kitchen Dining room

5.33m x 2.77m Fitted with a matching range of base and eye level units with worktop space, sink with mixer tap, integral fridge freezer and dishwasher, built in electric oven, built in four ring gas hob with extractor hood, window to front, two windows to side, radiator

### Utility Room

1.79m x 1.48m Base units with worktop over, sink, plumbing for washing machine, radiator, wall mounted boiler, door to rear

### Stairs to first floor and landing

Window to rear, radiator, airing cupboard

### Master Bedroom

5.32m x 3.20m Window to side and front, two radiators, door to

### Ensuite shower room

Fitted with a three piece suite comprising shower cubicle, wash hand basin, wc, window to rear, radiator

### Bedroom Two

3.18m x 2.79m window to front, window to side, radiator





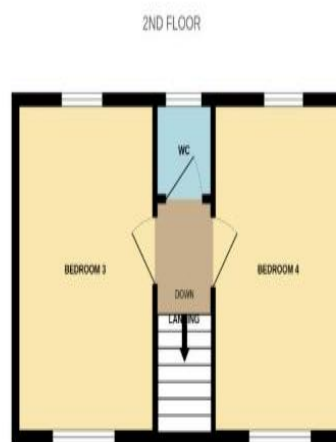
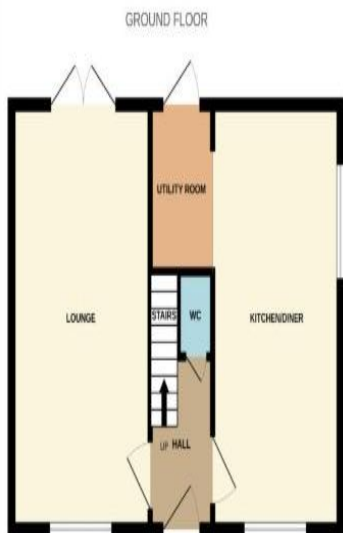

### Bathroom

Comprising panel bath with power shower, wash hand basin, wc, window to rear,

### Stairs to second floor and landing

### Bedroom Three

3.91m x 2.80m window to front, skylight to rear, two radiators

### Bedroom Four

3.90m x 3.19m window to front, skylight to rear, two radiators

### Cloakroom

Comprising wash hand basin, wc, radiator, window to rear

### Outside

Laid to lawn to the front with driveway to the rear leading to a single detached garage, The rear garden is enclosed by a brick wall and timber panelled fencing, laid mainly to lawn with patio area.

To view this property call Sharman Quinney on:  
**01778 343322**

# Selling your property?

Contact us to arrange a **FREE** home valuation.

 01778 343322

 25 Market Place, Market Deeping,  
PETERBOROUGH, Cambridgeshire, PE6 8EA

 marketdeeping@sharmanquinney.co.uk

 [www.sharmanquinney.co.uk](http://www.sharmanquinney.co.uk)



 SCAN ME



Sharman Quinney Holdings Limited is registered in England and Wales under company number 4174227, Registered Office is Cumbria House, 16-20 Hockliffe Street, Leighton Buzzard, Bedfordshire, LU7 1GN. VAT Registration Number is 500 2481 05.

1: These particulars do not constitute part or all of an offer or contract. 2: The measurements indicated are supplied for guidance only and as such must be considered incorrect. 3: Potential buyers are advised to recheck the measurements before committing to any expense. 4: Sharman Quinney has not tested any apparatus, equipment, fixtures, fittings or services and it is the buyers interests to check the working condition of any appliances. 5: Sharman Quinney has not sought to verify the legal title of the property and buyers must obtain verification from their legal representative. 6: Intending purchasers will be asked to produce identification documentation at a later stage and we would ask your co-operation in order that there will be no delay in agreeing the sale. Ref: MRD204329 - 0013

