



## ST. GEORGE WHARF, SW8

£700,000

The apartment comprises of two double bedrooms, with the principle bedroom also benefiting from an en suite. The large balcony offers a stunning river view.

- 2 Bedrooms
- 2 Bathrooms
- Large balcony
- River View
- 840 Sq/Ft
- 24 Hour Concierge



## ABOUT THE HOME

St George Wharf is situated right by Vauxhall station giving easy access right across London from the mainline station and Victoria lines. Also there is a bus station and Thames clipper service. The development also hosts an array of amenities including an onsite Tesco, bars, restaurants and a gym.





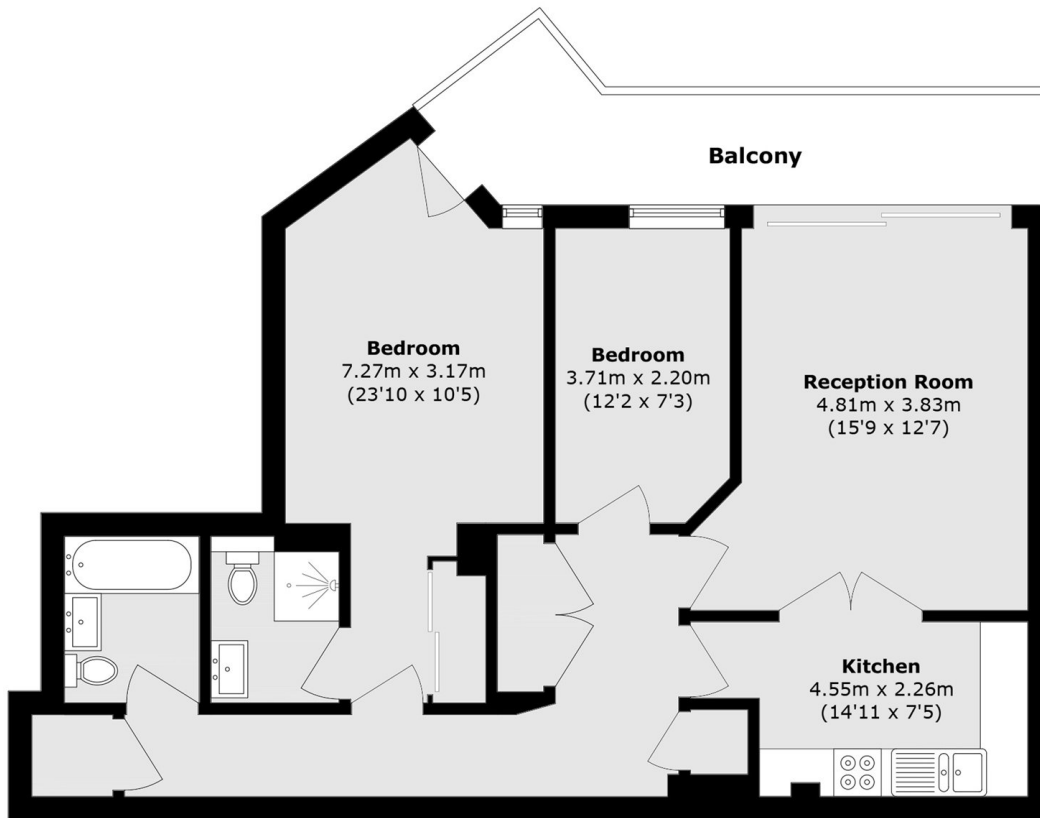

Total area (approx.): 78.1 sq. m (840.7 sq. ft)  
Balcony area (approx.): 11.2 sq. m (120.6 sq. ft)

**LiFE RESIDENTIAL**

11 Flagstaff House, London,  
SW8 2LZ

Sales: 020 7476 1408

Lettings: 020 7582 7989

Energy Rating: . We aim to make our particulars both accurate and reliable. However they are not guaranteed; nor do they form part of an offer or contract. If you require clarification on any points then please contact us, especially if you're traveling some distance to view. Please note that appliances and heating systems have not been tested and therefore no warranties can be given as to their good working order.