



11 Castlevue Close, Highbury & Islington, London, N4 2DJ

£899,000

- 4 bedrooms
- Lovely garden space
- Close to local amenities
- garage
- 2 bathrooms
- Convenient garage parking
- Easy access to transport
- Charming pre-war house
- Located on Castlevue Close
- Viewing recommended

11 Castleview Close, Highbury & Islington N4 2DJ

We are delighted to offer this attractive family home built in the 1980s, ideally situated in the highly sought-after Castleview Close.

Arranged over a well-balanced 1,596 sq ft, the property boasts four well proportioned bedrooms and two bathrooms, including a principal en-suite, in addition to a separate WC.

Further benefits include a private rear garden, ideal for entertaining or relaxing, and a garage providing valuable storage and off-street convenience.

Combining characterful features with practical modern living, this is a rare opportunity to secure a substantial home in a desirable location. Early viewing is highly recommended.

Tenure: Freehold



Council Tax Band: F



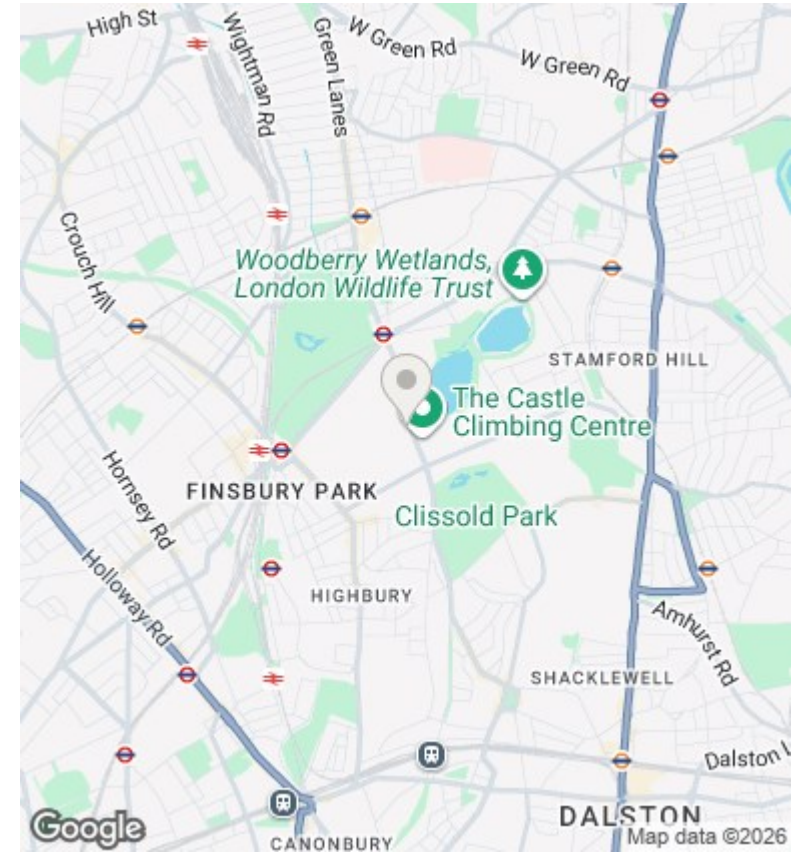
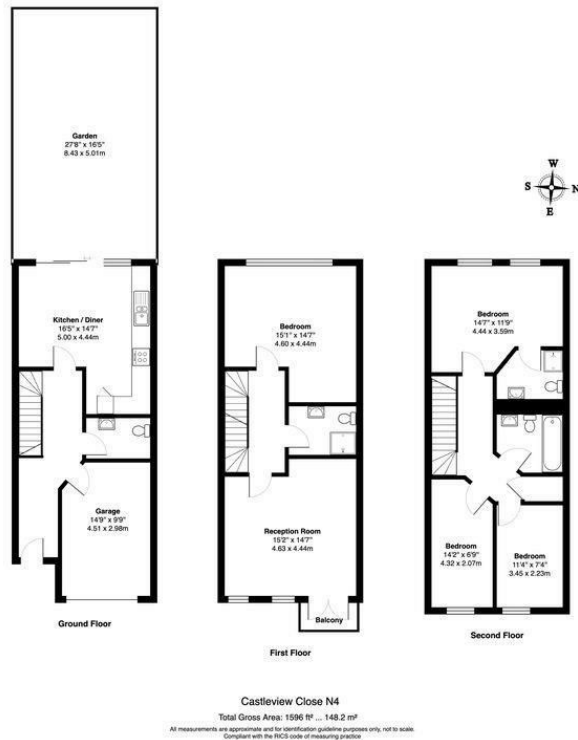

Directions

Viewings

Viewings by arrangement only. Call 02073593191 to make an appointment.

Council Tax Band

F

Energy Efficiency Rating		Current	Potential
Very energy efficient - lower running costs			
(92 plus) A			
(81-91) B			
(69-80) C		75	78
(55-68) D			
(39-54) E			
(21-38) F			
(1-20) G			
Not energy efficient - higher running costs			
England & Wales	EU Directive 2002/91/EC		





