



## St. Georges Road, TW13

### £450,000

Offered with no onward chain is the beautifully presented two bedroom Victorian cottage. It would make a perfect family home benefiting from retaining many original features, a south facing garden and offers potential extension (STPP).

St. Georges Road is a quiet residential street on the borders of Hampton and Hanworth, and has excellent transport links for Heathrow and Feltham town centre with its fast trains to London Waterloo.

### Features

- Two Bedrooms
- Potential To Extend STPP
- No Onward Chain
- Victorian
- End of Terrace
- Large South Facing Garden

# St. Georges Road, Feltham, TW13

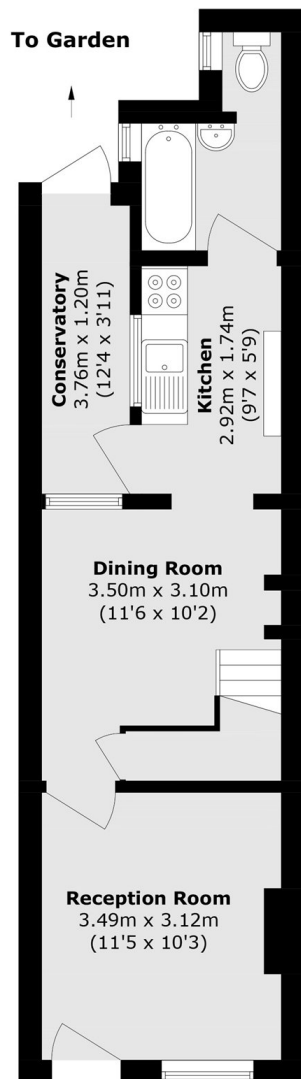

**Ground Floor**

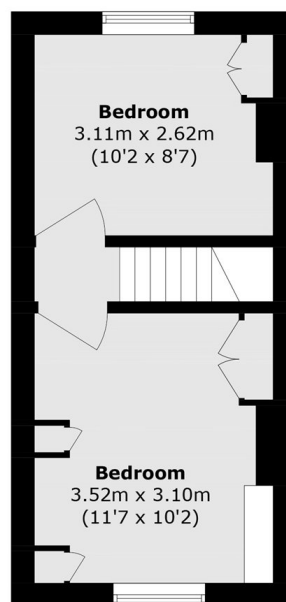

**First Floor**

Total area (approx.): 59.8 sq. m (643.6 sq. ft)