



## 40 Caravel Close, London, E14 8PD

City Realtor are delighted to present to the market this fantastic 3 bed + lounge flat situated in a private gated development.

The flat boasts 3 large double bedrooms, an open plan kitchen lounge, 1 bathroom and 2 of the bedrooms have a juliette balcony each.

OPEN PLAN KITCHEN WITH DISHWASHER

The property will come furnished and all white goods will be provided.

- WALKING DISTANCE TO CANARY WHARF
- PRIVATE PARKING
- GATED DEVELOPMENT
- 2 JULIETTE BALCONY'S
- 3 DOUBLE ROOMS
- FULLY FURNISHED
- DISHWASHER
- NEAR ALL AMENITIES
- MODERN DECOR - GREAT CONDITION
- FANTASTIC LOCATION

**£2,500 Per month\* Fees Apply**

# Caravel Close

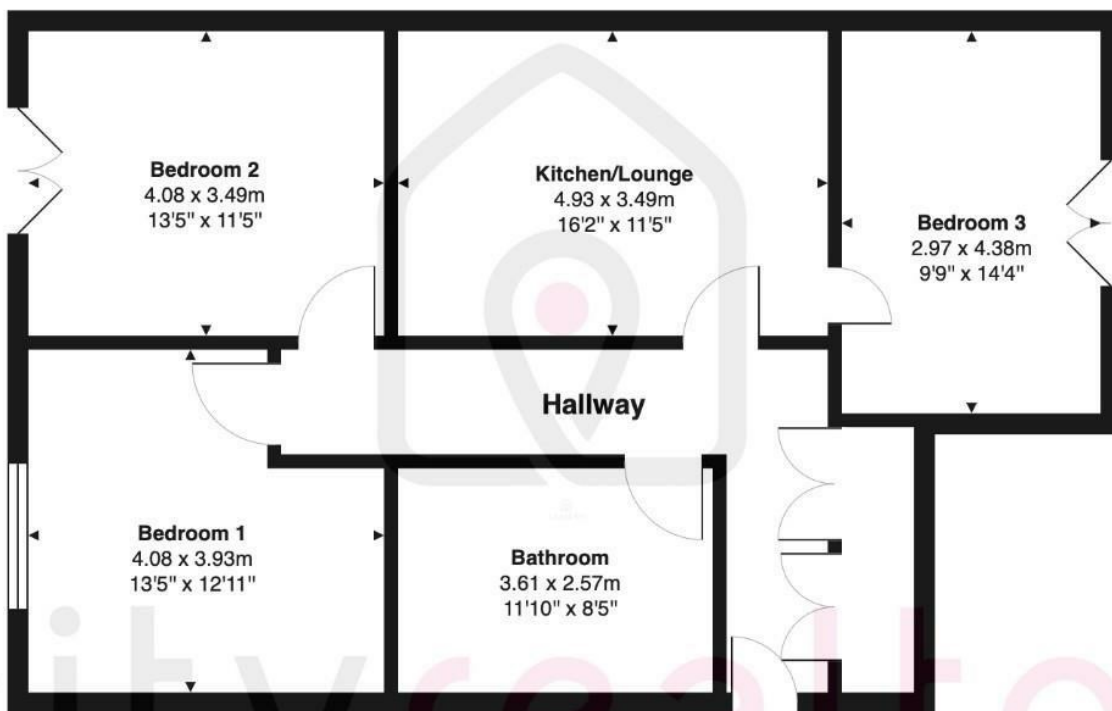

## Fourth Floor

Total Area: 86.4 m<sup>2</sup> ... 930 ft<sup>2</sup>

All measurements are approximate and for display purposes only

Energy Efficiency Rating		Current	Potential
Very energy efficient - lower running costs			
(92 plus) <b>A</b>			
(81-91) <b>B</b>			
(69-80) <b>C</b>			
(55-68) <b>D</b>			
(39-54) <b>E</b>			
(21-38) <b>F</b>			
(1-20) <b>G</b>			
Not energy efficient - higher running costs			
<b>England &amp; Wales</b>	EU Directive 2002/91/EC		

Environmental Impact (CO <sub>2</sub> ) Rating		Current	Potential
Very environmentally friendly - lower CO <sub>2</sub> emissions			
(92 plus) <b>A</b>			
(81-91) <b>B</b>			
(69-80) <b>C</b>			
(55-68) <b>D</b>			
(39-54) <b>E</b>			
(21-38) <b>F</b>			
(1-20) <b>G</b>			
Not environmentally friendly - higher CO <sub>2</sub> emissions			
<b>England &amp; Wales</b>	EU Directive 2002/91/EC		

These particulars, whilst believed to be accurate are set out as a general outline only for guidance and do not constitute any part of an offer or contract. Intending purchasers should not rely on them as statements of representation of fact, but must satisfy themselves by inspection or otherwise as to their accuracy. No person in this firm's employment has the authority to make or give any representation or warranty in respect of the property.